



IMPROBABILITY

44' (13.41m) 1998 Dean 440
Savannah Georgia United States



OVERVIEW

Manufacturer:	Dean	Hull Material:	Fiberglass
Engines:	2 Yanmar	Cruise Speed:	7
Engine Model:	3YM30	Max Speed:	9
Engine HP:	0	Cabins/Heads:	4 / 3
Beam:	24' 0"	Fuel Type:	Diesel
Max Draft:	4' 0"	Fuel:	122 G (461.82 L)
Water:	286 G (1082.63 L)		

\$165,000



Daryl Rester daryl@suncruising.com

601-850-4357

Data Sheet

Category: Catamaran
Condition: Used
Model Year: 1998
Beam: 24' (7.32m)
Max Draft: 4' (1.22m)
LOA: 44' (13.41m)
Cabins: 4
Sleeps: 8
Double Berths: 1
Queen Berths: 1
Heads: 3

Maximum Speed: 9 Cruise Speed: 7 Fuel Fuel Tank: 122 gal (461.82 liters)
Type: Diesel Fresh Water: 286 gal (1082.63 liters)
Hull Material: Fiberglass HIN/IMO: USZ00122J707
Bridge Clearance: 64' 5 In Stock: Yes

Engines/Generators

Engine 1

Yanmar
3YM30
Inboard
Fuel: Diesel
Year: 2014
Location: Port

Engine 2

Yanmar
3YM30
Inboard
Fuel: Diesel
Year: 2014
Location: Starboard

Summary/Description

Introducing - Improbability - 1998 Dean 440

If you were to walk down a dock full of large catamarans, the Dean would stand out with its overly raked mast and unique aerodynamic styling hull shape. Beautifully fitted out in high gloss cherry throughout she oozes comfort and warmth. 4 cabins with in-suites and bathrooms a plenty ensure comfort at sea is a given. With a very well thought out large aft deck she is comfortable for entertaining or on the high seas.

A well-loved and expertly maintained Dean. She has completed several voyages across the Atlantic and cruised the Caribbean down to South America. Over the years she has completed at least 14 round trip ICW voyages from Southern New England to the Florida Keys including offshore passages with Bahamas cruising. Being full time liveaboards space is a must and this Dean answers the bill with hanging lockers and cabinets at every turn.

Some of the updates and features:

Large main salon with 10-foot semi-circle sofa. 2 forward cabins with queen size berths with connected heads. 2 aft cabins with double berths.

The galley to starboard has open access to the main cabin making meals and entertaining delivery a breeze. 4 burner propane stove with separate oven. 5.5 cubic foot side by side refrigerator/freezer. The port hull has a top loading freezer for those long passages. All are 12v with the 110v power option.

Fore cabin port and starboard - Queen-size port side and King-size bed approximately in starboard hull. Each with two opening Lewmar hatches and a side opening Lewmar port light. Opposite is a huge wardrobe with four shelves and a hanging locker and dressing table with three cupboards underneath. Very well-lit throughout.

Aft cabin port and starboard - Large slightly tapered double berth in each cabin with soundproof engine room underneath, two large cupboards with shelf above bed, huge wardrobe with shelves and seat, locker at foot of bed gives access to rudder controls, tiller arms and steering, reading lights.

Very large aft cockpit with a hard top and canvas/screens all around. Surround seating makes easy access to the central folding table.

Dual helm stations with mainsail controls at each.

Rig: 7/8 fractional sloop. Approx 807 sq. ft. main with single line reefing for first two reefs and a third reef. Approx 549

sq. ft. genoa with Profurl furler. Asymmetrical spinnaker with ATN sock about 1345 sq. ft. Storm sail.

2014 Yanmar 3YM30 engines. Two SD-25 saildrives were added in October 2023. Flexifold folding 3 blade propellers.

New bow netting as of 2022.

Owners have meticulous maintenance logs available.

2015 ZODIAC Dinghy was purchased brand new from Defender stock in 2017. 9.8 Tohatsu outboard.

V2





Glamor 2



Glamor 3

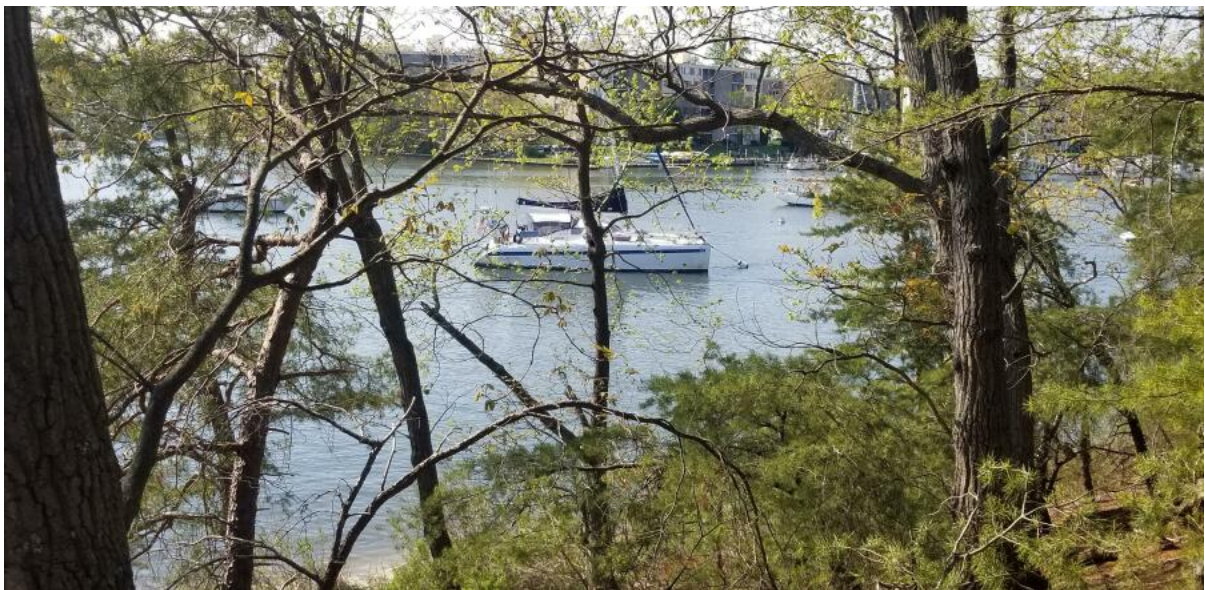

Glamor 4



Salon 1



Salon 2



Salon 3



Port Hallway Facing 1



Port Forward Berth 1



Port Forward Berth 2



Port Forward Berth Hallway



Port Forward Berth Head 1



Port Forward Berth Head 2



Port Hallway Facing Aft 2



Port Hallway Facing Aft

601-850-4357



Port Aft Berth



Starboard Galley 1



Starboard Galley 2



Starboard Galley 3



Starboard Galley 4



Starboard Galley 5



Starboard Entrance To Owners Suite 1



Starboard Owners Suite 3



Starboard Owners Suite Head 5



Starboard Owners Suite Hull Side 2



Starboard Owners Suite Head 1



Starboard Owners Suite Head 2



Aftt Cockpit 1



Aft Cockpit 2

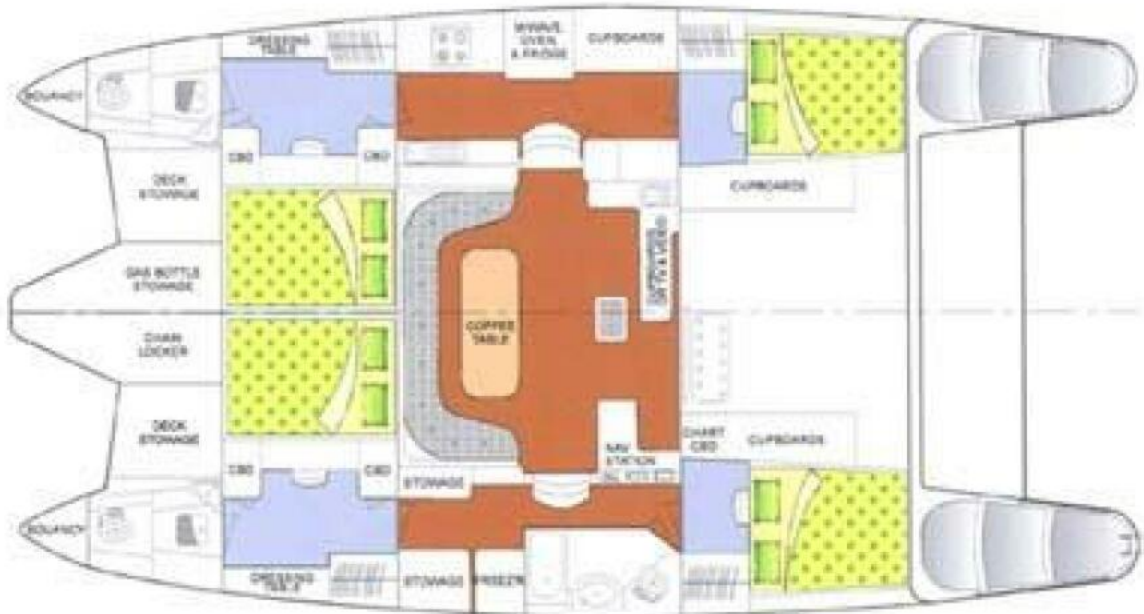

Dean 440 Below Deck Plan

Dean 440 Layout