



50' (15.24m) 2022 Amel 50  
Montenegro



## OVERVIEW

**\$1,185,000**

Manufacturer:	Amel	Hull Material:	Fiberglass
Engines:	1 Volvo	Cruise Speed:	
Engine Model:	D3-110	Max Speed:	
Engine HP:	110	Cabins/Heads:	3 / 2
Beam:	15' 8"	Fuel Type:	Diesel
Max Draft:	22' 11"	Fuel:	170 G (643.52 L)
Water:	160 G (605.67 L)		



## Data Sheet

Category: Cruisers  
Condition: Used  
Model Year: 2022  
Beam: 15'8" (4.78m)  
Max Draft: 22' 11" (7.00m)  
Min Draft: 1' (0.30m)  
LOA: 54' 2" (16.51m)  
LWL: 47' 7" (14.50m)  
LOD: 50' 10" (15.49m)  
Cabins: 3  
Sleeps: 8  
Convertibles: 2  
Single Berths: 2  
Queen Berths: 2  
Head Room: 7' Heads: 2

Fuel Type: Diesel  
Hull Material: Fiberglass  
Air Conditioning: Yes  
Bridge Clearance: 74'

Displacement: 50000 lbs  
Fuel Tank: 170 gal (643.52 liters)  
Fresh Water: 160 gal (605.67 liters)  
Holding Tank: 15 gal (56.78 liters)  
Builder: Chantier Amel  
Designer: Racoupeau  
HIN/IMO: AML50061L122

## Engines/Generators

### Engine 1

Volvo  
D3-110  
Inboard  
110HP  
82.03KW  
Fuel: Diesel  
Hours: 850  
Hours Date: 04-15-2024  
Year: 2021  
Location: Middle

### Generator 1

Onan  
8KW  
2880.00RPM

## Summary/Description

Fantastic opportunity to own a fully-equipped and gently used Amel 50, positioned at the doorstep of the Med and ready to start cruising today!

*Malecon*, a US-flagged/US-owned vessel, was thoughtfully spec'd by her experienced owners, who enjoyed two full seasons of cruising from the Amel factory in La Rochelle and throughout the Mediterranean. A change in plans has made the vessel available for immediate sale. She is truly turn-key, with a full complement of spares, tools, safety gear, galleyware, bedding and more. Read on for a detailed list of factory options and inventory.

A note for American buyers: US citizens cruising in the EU with a Coast Guard Documented vessel can enjoy 18-months of VAT-free cruising in the EU. The 18-month "clock" resets as soon as the vessel clears into a non-EU port such as Gibraltar or Montenegro. Contact the listing broker for more details.

All photographs taken by listing broker in April of 2024.

## Installed Options

***Malecon* is equipped with the following options:**

American walnut interior

Upholstery in white with taupe piping (except nav seat)

Dessalator watermaker, 230V or 24V, 100 l/h

Deep freezer under salon settee

Air conditioning w/ reverse cycle heat (3 zone)

"Pack Plus Comfort":

Onan 8kw 3 cylinder generator with sound shield

Additional 100 amp Mastervolt charger (in addition to 60 amp standard charger)

Lithium battery pack, Mastervolt MLI Ultra with EasyView monitor, 800 ah

4000 watt and 800 inverters

Full USA 110 volt package (in addition to standard 230v European)

50 amp/60 hz shore power inlet and cord

2000 watt 110 v inverter

19 US outlets throughout boat

Victron 110V/230V autotransformer

Microwave

GN Espace induction cooktop with electric oven

Dishwasher

LG Combo clothes washer/dryer

Interior indirect lighting package

Saloon table with electric lowering, cushion insert and lee cloth

Safe in aft cabin

Self-tacking jib with electric furler and all rigging

Spinnaker/whisker pole and required rigging

Electric winch upgrade (primaries and mainsheet)

Varifold feathering prop with line cutter

8 hp retractable bow thruster (24 volt)

Anchor chain upgraded to 100 meters of stainless with Ultramarine 45 kg anchor

LED blue lights at transom/swim platform

LED spreader lights

Underwater lights

Amel electric davits

570 watts of solar on hardtop with MPPT controller

1000 watts of solar on davits with MPPT controller (custom stainless frame)

Highfield dinghy with wheels, nav lights, cover and 20 hp Honda engine with electric start/tilt

Viking 8-person life raft

Cockpit cushions plus optional aft deck cushions in charcoal gray

12 inflatable logo'd fenders with inflater

Cockpit covers, boom tent and winter enclosure in Captain Navy

Complete bedding for all cabins

43" LCD TV in salon with electric lift, networked via Pepwave

Hi-Fi "Pack 1," Fusion head unit, Bose interior speakers/woofer, Polk Audio cockpit speakers

VHF handset in cockpit with loudhailer (in addition to standard VHF at nav desk)

IridiumGO installed

Electronics:

Two 16" Furuno TZT3 Navnet MFD's (helm and nav)

B&G H5000 Hydra system with 3 GFD's + analog wind in cockpit, additional GFD at nav desk

FA70 AIS

2nd Furuno Navpilot 711C

Video camera at masthead for stern view

World Pepwave WiFi 3G/4G received and amplifier for connectivity

EPIRB emergency beacon with GPS

Volvo EasyConnect NMEA interface to display all engine data (including consumption) on Furuno plotters

**Additional custom upgrades:**

45 kg UltraMarine stainless steel anchor

2 additional folding padeyes at bow for jacklines

Bow nose snubber fairlead

Lee clothes for salon settees, port & starboard

Pre-fitting for 3 solar panels on davits

8 fans throughout interior (in white)

Red/white lights at nav table and cockpit

Furuno alarm buzzer in aft cabin

Jonbuoy crew overboard module on stern rail

Mirror above desk in aft cabin

Curved handrail on hardtop, port/starboard

Chart storage under aft cabin bed

USB socket at helm station

4 additional inflatable fenders with logos (for a total of 12)

**Hull and Deck Construction**

Vacuum-infused molding

Solid fiberglass hull below the waterline with vinylester anti-osmosis barrier

PVC closed-cell foam laminate above waterline and on deck

Structural grid in polyethelene omega-foam and plywood, laminated to hull, for maximum rigidity and load distribution

4 safety bulkheads glued and laminated to the hull, with isolation valves for flooding

Decks in moulded "teak" anti-skid finish exclusvie to Amel

Cast iron ballast keel with epoxy coating

twin rudders with foam core, reinforced laminate at leading edges, with stainless steel rudder stocks

## Sails and Rigging

- AMEL mast and electric in-mast furling system and AMEL boom and electric clew sheeting system in extruded aluminum finished in two-part paint (white)

- 2 sets of spreaders.

- Adjustable boomvang

- LED deck lights : 1 on the mast, 2 on the spreaders and 1 on the boom end.

- LED mooring and masthead lights.

- Dyform stainless steel standing rigging.

- Vectran and Dyneema halyards.

- Profurl electric genoa furling gear.

- Halyard for mast ascending.

- Additional external halyard on the mast for light sails.

- Boom extension for hoisting outboard to stow in lazarette

### SAILS

- Tri-radial cut Hydranet mainsail, genoa and self-tacking jib with UV

- Furling Code Zero

## Electrical Systems

Malecon is fully equipped to run on any shore-based power supply found across the globe, or be fully independent to produce her own power supply:

- 230 volt 50 hz shore power fitting
- 110 volt 60 hz (US-standard) shore power fitting
- Victron Autotransformer
- Onan diesen generator
- over 1000 watts of solar power with 3 MPPT controllers



- Mastervolt MLI Lithium (LiFePO4) batteries
- Dual inverters
- 24 volt 110 amp alternator on Volvo engine

## Deck Fittings

Stainless steel bow nose with integrated anchor fairlead

Electric windlass controlled from the cockpit.

Stainless steel pulpit, pushpit and side rails (openings in the pushpit and side rails for easy access to quay or pontoon).

Stainless steel guard line. Teak seats in pushpit and pullpit.

LED navigation lights.

8 mooring cleats in stainless steel.

Liferaft support in side rail.

Stainless steel chain plates.

Sheet traveller tracks with tidy travelers.

All the controls (manual and electric) of sheets, mainsail tackle and sail furling systems are run to the cockpit.

2 manual genoa sheet winches (black anodized Harken). Electric winches available in option.

2 manual winches for genoa sheet travelers.

1 manual mainsail sheet winch (black anodized Harken). Electric winch available in option.

2 manual winches on the mast (black anodized Harken), 2 halyard downhauls on the mast.

2 halyard clutches.

8 opening and 2 fixed hatches on the deck, 7 opening portholes.

On deck, 5 large lockers:

At the foredeck: a large sail locker (isolated by a collision bulkhead), with easy access to the chain locker, to the bow thruster compartment (option) and to a wide space for fenders, mooring lines and extra sails. Timed lighting. Interior

finish with light coloured gelcoat. Lockable from inside the boat.

On the aft deck: a large locker for a possible dinghy, diving equipment, fenders, etc. 230 V socket. Timed lighting. Interior finish with light coloured gelcoat. 230 V shore power socket circuit breaker. 230 V shore power cable. Galvanic

isolator. Compartment for gas cylinder. Access to rudder system and autopilot. Locker hood on gas cylinders. Bilge pump with overflow alarm.

On the port side deck, locker with diesel and water fillers lockable from the inside of the boat.

2 long side lockers on aft coaming.

Large sunbathing area on the aft deck.

The transom opens into a swimming platform, with remote controlled hydraulic opening system. Foldable ladder fitted in dedicated space in the aft part of the platform. Shower with mixing tap. Storing spaces in the transom steps. 2 foldable cleats.

Emergency ladder in transom

## **Interior**

### INTERIOR FITTINGS

Woodwork in American Walnut with a matte finish

Laminate flooring (light oak finish).

Lighting via overhead, recessed LED striplights (floor and headliner), and reading lights

Storage:

- Numerous storage spaces on board including cabinets, drawers, lockers, hanging lockers and under sole lockers.

Trimming and upholstery

- High quality standard upholstery and trim.
- Black-out blinds on all the port lights.
- Black-out blinds and fly screens for all deck hatches.
- Lee clothes or lee boards for the berths.

### SALOON / CHART TABLE / GALLEY

Saloon:

- Bright and spacious. Provides an excellent view of the outside. 2 opening hatches, 2 fixed hatches, 2 fixed roof portlights, 2

opening roof portlights, 4 large hull portlights.

- Lighting from LED ceiling spotlights.
- Numerous electrical sockets.

- On portside: Adjustable saloon table for 8 guests, with very comfortable U shaped seat. Close storage for dishes.

- On starboard, saloon area: Sofa with wine/spirit cabinet and storage for glasses. Small table made of 2 square seats covered by a removable cushion, can be used as additional seats for the dining table. Lee-cloth for the sofa.

To portside, the forward facing navigation station:



- Forward facing chart table with storage space and board for the electronics.
- Easy access to 230 V and 24 V power sources ; 24 V and 12 V terminal, 230 V outlets, electrical backlit 230 V and 24 V boards.
- Excellent view outside via a large hull portlight.

#### **Galley:**

- Functional, bright and ventilated : large hull portlight and 2 opening portholes.
- Large working surface made of moulded Corian with surround. Double sink, stainless steel, with mixer tap. Soap dispenser.
- A combination of low units, drawers and upper cabinets.
- A gimbal-mounted 3-burner induction stove with electric oven
- Fridge: column with 1 x 104-litre drawer and 1 x 78-litre drawer (additional fridge/freezer under starboard settee in salon)
- dishwasher and microwave

### **Engine/Machinery Space**

Spacious engine room, isolated in case of flooding, housing nearly all of the mechanical systems for the boat. This allows for servicing and maintenance to take place without disrupting the living space onboard, a key feature unique to Amel.

- High density insulating foam for sound insulation.
- Several lighting points, 230 V socket.
- Access: full opening of the cockpit bottom assisted by a gas strut.
- Low-speed diesel engine, 110 hydraulic gearbox. Electric throttle.
- Sigmadrive coupling with PSS shaft seal
- Engine starting battery (90 Ah) + coupler for optional generator starting battery (4" digital display in the cockpit).
- Shaft line transmission with strut.
- Propeller shaft break.
- Folding propeller. PSS shaft seal.
- Diesel fuel capacity: 650 litres.
- 24 V fans for the engine and batteries compartments.
- Automatic bilge pump.

### **Additional Equipment**

- Highfield 310 dinghy with wheels, nav lights, cover and 20 hp Honda engine with electric start/tilt
- Safety gear including PFD's, tethers, flares, ditch bag, med kit
- tools
- spare parts
- 12 inflatable Amel fenders with inflator
- docklines

- [all manuals](#)



Cruising Amel 50



Cruising Amel 50





Cruising Amel 50



Deck Amel 50





Deck Amel 50



Deck Amel 50





Deck Amel 50



Deck Amel 50





Deck Amel 50



In-Mast Furling Amel 50



Spinnaker Pole Amel 50



Sun Pad Amel 50





Sun Pad Amel 50



Hard Top Amel 50





Helm Amel 50



Helm Amel 50





Cockpit Amel 50



Cockpit Amel 50



Companionway Amel 50



Saloon Amel 50





Saloon Amel 50



Saloon Amel 50



Saloon Amel 50



Saloon Amel 50





Nav Station Amel 50

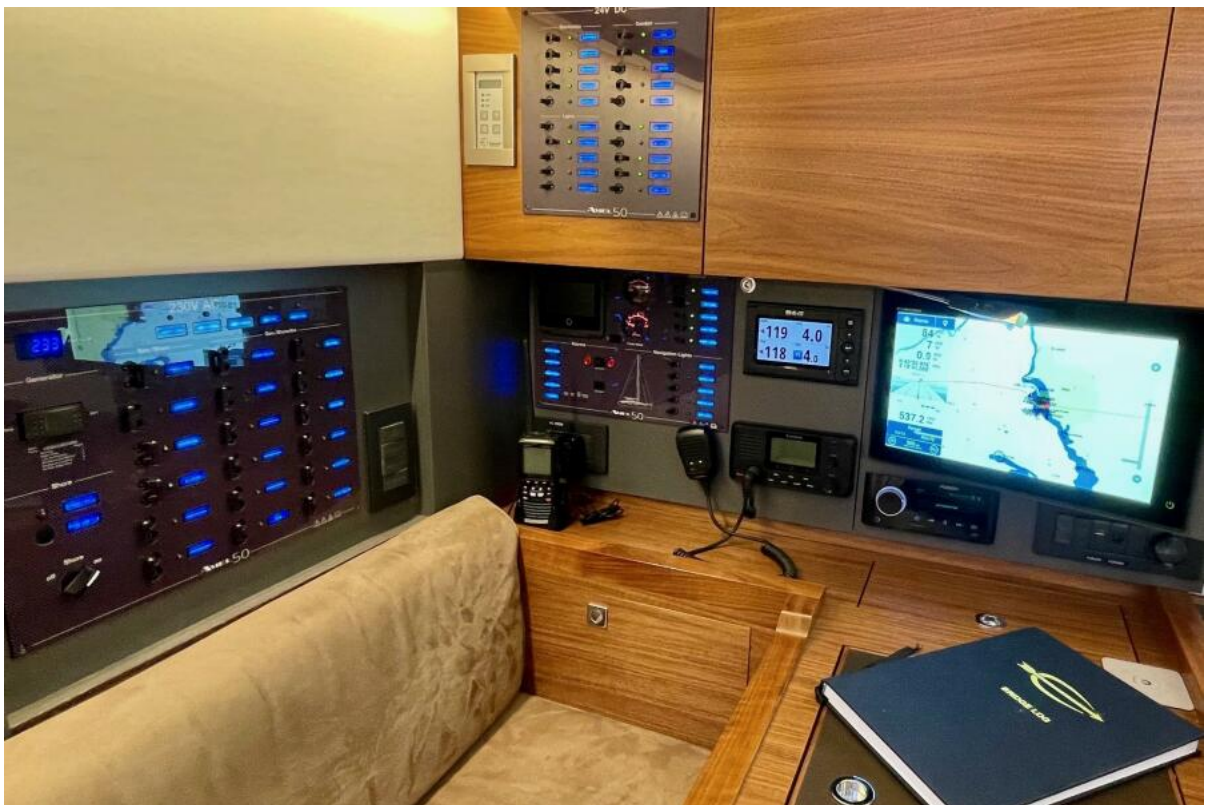

Electronics Amel 50



Galley Amel 50



Galley Amel 50





Galley Amel 50



Galley Amel 50



Forward Bulkhead Amel 50



Primary Cabin Amel 50





Primary Cabin Amel 50



Primary Cabin Amel 50



Primary Cabin Amel 50



Guest Cabin Amel 50





Forward Head Amel 50



Bunk Cabin Amel 50



Hull Storage Amel 50



Hull Storage Amel 50





Dinghy Outboard Amel 50



Covered Helm Amel 50



Night Lighting Amel 50



Underwater Lights Amel 50





Night Lighting Amel 50

## AMEL 50

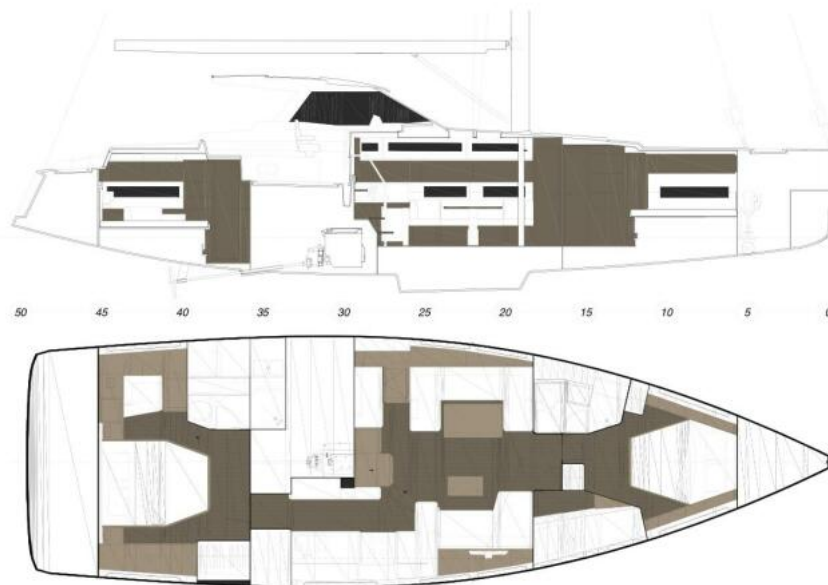

Layout Amel 50