



70' (21.34m) 2025 Aquabay Express
Sequim Washington United States



OVERVIEW

\$4,250,000

Manufacturer:	Aquabay		
Engines:	2 CAT	Hull Material:	Fiberglass
Engine Model:	C-18	Cruise Speed:	20 Knots
Engine HP:	1018	Max Speed:	29 Knots
Beam:	17' 4"	Cabins/Heads:	3 / 3
Max Draft:	3' 7"	Fuel Type:	Diesel
Water:	264.17 G (1000 L)	Fuel:	1194.06 G (4520 L)



Data Sheet

Category: Cruisers
Subcategory: Motor Yachts
Condition: New
Model Year: 2025
Beam: 17'4" (5.30m)
Max Draft: 3' 7" (1.10m)
LOA: 69' 8" (21.25m)
LWL: 58' 4" (17.80m)
Cabins: 3
Sleeps: 6
Full Beam Master: Yes
Heads: 3

Crew Cabins: 1
Captain's Quarters: Yes
Maximum Speed: 29 Knots
Cruise Speed: 20 Knots
Fuel Type: Diesel
Super Structure Material: FRP
Hull Material: Fiberglass
Hull Shape: Deep Vee
Hull Finish: Gel Coat or Paint Option

Displacement: 44 tonnes
Fuel Tank: 1194.06 gal (4520 liters)
Fresh Water: 264.17 gal (1000 liters)
Holding Tank: 238 gal (900.93 liters)
Classification: Bureau Veritas
Builder: TC Yachts
Designer: Peter Lowe Designs/Aquabay Yachts
Interior Designer: Identity Marine/Aquabay YachtsDesigns

Engines/Generators

Engine 1

CAT
C-18
Inboard
1018HP
759.12KW
Fuel: Diesel
Year: 2024
Location: Port

Engine 2

CAT
C-18
Inboard
1018HP
759.12KW
Fuel: Diesel
Year: 2024
Location: Starboard

Generator 1

Northern Lights
25KW

Summary/Description

Based on the high performing the Olympia 76, TC Yachts invited yacht design master, Peter Lowe to further expand the design. They combined the hull of the Olympia 76 with a new deck shape and layout to create the Aquabay 70. The interior is minimalist and modern throughout, yet open and inviting.

The Aquabay 70 Flybridge model is a dynamic yacht cruiser offering US buyers robust Australian design coupled with rugged SCRIMP hull and deck construction. The result is a powerhouse performance yacht that has all the comforts one would expect in the pedigree while avoiding the cookie-cutter feel of production yachts. It feels solid and lasting because it is built with quality materials and engineering.

This Peter Lowe Design by Michele Briand- an Australian designer known for producing stylish and capable yachts for their clients. The resulting design and Express and Flybridge models clearly bring their designs to life.

Originally designed for the Australian market, the Aquabay 70 Express and 70 Flybridge models combine the graceful lines and construction that translates to comfortable ride at speed, great maneuverability, and an interior layout that can be adjusted to suit owner's cabin requirements. More notably - the use of optional pod drive systems for propulsion allow the interior design to increase cabin spaces for those owners that wish to add the optional Volvo IPS System. It is now available to US buyers. The Aquabay 70 gives owners a great yacht built with lasting craftsmanship. Each is produced specifically for their owners. Construction is generally around 12 months. Give us a call to make plans for next year's cruising adventures in a brand new Aquabay 70 built for you and your family.

General Features

- Bow Lounge
- Walk Around Side Decks
- Helm Access Door
- Electric Sun Roof
- Full Size BBQ
- Full size tender garage with electric tender cradle
- Electric Cockpit Sun Awning
- Ice Maker
- Full Size Bar with Fridge, Wine Cooler, Dishwasher
- Electric 4 Way Sun Bed, Sun bed, Sun bed lounge, Coffee table, Dining Table for 8
- Bose sound system
- Miele appliances
- Raymarine or Garmin Navigation
- Premium Ultra-Leather Fabrics
- 3 or 4 Cabin Layout
- Crew Cabin
- Air Conditioning in all area
- Teak bathing platform, Steps, and Cockpit
- Under Water Exhausts
- Automatic fire system and alarms

- SCRIMP Vacuum Infusion Hull and Superstructure
- Bureau Veritas Hull Certification Certificate and Report - option available
- **Please Note - (*) Denotes Option**

Main Deck

- Teak bathing platform, steps and cockpit
- Teak side decks and bow area *
- S/S Anchor
- S/S Anchor roller
- Sea water deck and anchor wash
- Chain Locker x 2
- Windlass (Helm and Foredeck control)
- Bow lounge
- Sun Pad
- Recessed storage lockers x 6
- S/S wipers and washer
- Navation lights
- Fold down S/S mast light
- S/S hand rails
- S/S port lights
- S/S round hatch in foredeck
- Bollards x 4
- Hawse pipe and cleats x 4
- Retractable cleats x 2
- Cleats x 2
- Chocks x 2
- Recessed cabinet for fuel filler and vent
- Recessed cabinet for fire hydrant
- Deck ventilator for engine room
- Recessed fender holders with fenders

- Electric 4 way sun bed and dinning table
- Capstans x 2 *
- Electric sun shade
- Recessed cabinets for shore power/water
- Hot and cold swim shower
- Hydraulic garage door with teak in layed seat
- Electric tender cradle with remote
- S/S swim ladder
- Deck drainers x 4
- Engine room hatch
- Window and equipment covers *
- Hull and superstructure Paint *
- Bow lounge speakers x 2
- Cockpit speakers x 4
- LED access and walkway lights
- Search Light with helm control

Please Note :

Options * - Items are Optional with the (*) at end of each listed, prices available upon request. Not all features are standard due to differences in Owner configurations. Don't see something you would like added? Please contact us directly to discuss.

Engine Room

- Caterpillar C18 engines 1015 hp • Gear box ZF V-Drive
- Trolling valve
- Under water exhaust system
- Engine room exhaust fans
- Generator with sound shield 25kw
- Back up Generator *
- Water maker 95 lph * (600GPD)

- 4,250 L Aluminium fuel tanks (1,122 gallons)
- Fuel tank over flow trays
- S/S 500 L fuel over flow tank (132 gallons)
- Dual engine fuel filters
- Fuel filter gen sets
- Sound insulation
- Engine room machinery fan
- Automatic fire extinguishing system with alarms
- Heavy duty watertight door to crew quarters
- Oil change pump x 2
- All fuel system piping to USL survey standard

Please Note :

Options * - Items are Optional with the (*) at end of each listed, prices available upon request. Not all features are standard due to differences in Owner configurations. Don't see something you would like? Please call us directly to discuss.

Underwater and Stern

- 3 1/2" Propeller shaft • 5 blade Propeller
- S/S Rudder
- Zinc anodes
- Bow thruster
- Stern thruster *
- Under water lights*
- Trim Tabs *
- Sea water strainers for engines and generators
- Sea cocks on all underwater fittings
- Antifouling paint
- All underwater running gear to USL survey standard

Please Note :

Options * - Items are Optional with the (*) at end of each listed, prices available upon request. Not all features are standard due to differences in Owner configurations.

Plumbing

- Vacuum toilets
- Water heater 100L (26 gallon)
- Odour filters
- Macerator pump
- Automatic bilge pumps x 5
- Manual bilge pumps x 1
- Sump pumps x 2
- Premium taps, sinks and basins
- All plumbing and systems to USL survey standard

Please Note :

Options * - Items are Optional with the (*) at end of each listed, prices available upon request. Not all features are standard due to differences in Owner configurations. Don't see something you would like? Please contact us directly to discuss.

Bar Area

- Ice maker
- Fridge Chest *
- S/S BBQ
- S/S bar stools x 2
- Large opening S/S window • Full size bar
- Stone Bench top
- Wine cooler
- Bar fridge
- Dishwasher
- Miele coffee machine *
- S/S in bench garbage bin
- Magazine rack
- S/S sink with mixer

- Sink cover and drainer
- Hidden crew quarters stairs • Dining lounge
- Adjustable table
- Stools x 4
- Air conditioning
- Amtico flooring

Please Note :

Options * - Items are Optional with the (*) at end of each listed, prices available upon request. Not all features are standard due to differences in Owner configurations. Don't see something you would like? Please contact us directly to discuss.

Electrical

- Batteries 210 AH x 11
- Battery charger
- Inverter*
- Shore power connection • Cable master

* Denotes Option

- Premium lighting and switches with dimmers
- Premium Power and data sockets
- All wires/cables tin coated and numbered
- C O Sensors in cabins with helm display and alarm
- All wiring/cables and systems to USL survey standards

Please Note :

Options * - Items are Optional with the (*) at end of each listed, prices available upon request. Not all features are standard due to differences in Owner configurations. Don't see something you would like? Please contact us directly to discuss.

Saloon

- Chaise lounge
- Adjustable coffee table • Stool x 2

- Side cabinet
- Entertainment cabinet • Bose sound system
- 101 cm LCD (40 inches)
- TV lift
- DVD
- Air conditioning
- Amtico flooring
- Electric sun roof

Please Note :

Options * - Items are Optional with the (*) at end of each listed, prices available upon request. Not all features are standard due to differences in Owner configurations. Don't see something you would like? Please contact us directly to discuss.

Helm

- Full set Caterpillar engine Gauges
- Engine controls
- Hand held remote for engine controls *
- Raymarine navigation - or Garmin Option
- Compass
- Power assisted steering
- Tilt steering wheel
- Helm chairs with foot rests x 3
- Electric centre helm chair *
- Chart table
- Side access doors
- Equipment and systems control panels
- Air conditioning

Galley

- Sky light

- Full size fridge 415 L
- Miele dishwasher
- Miele oven
- Miele cook top
- Miele microwave
- Slim line range hood
- S/S sink with mixer
- Sink cover and drainer
- Under stair storage
- Stone bench top and splash back • Under bench garbage bin
- Air conditioning
- Amitco flooring

Owner's Stateroom

- King size bed
- Chaise lounge
- Makeup table with stool
- Office area with stool
- Wardrobe
- Cabinets and drawers
- Storage under bed
- Bose sound system
- 66 cm LCD
- DVD
- Electric blinds
- Air conditioning
- Premium fitted carpet

Owner's Stateroom Ensuite

- Basin with mixer • Full size shower • Exhaust fan

- Vacuum toilet
- Timber shower grate
- Frameless glass shower door • Bath robe locker
- Bath and hand towel rails
- Mirror
- Timber Vanity top
- Amtico flooring

VIP Stateroom

- Double bed
- Wardrobes
- Bed side tables
- Lift up bed for storage
- TV- 19"
- Air conditioning
- Premium fitted carpet

VIP Ensuite

- Basin with mixer
- Exhaust fan
- Vacuum toilet
- Timber shower grate
- Frameless glass shower door
- Bath and hand towel rails
- Mirror
- Timber Vanity top • Amtico flooring

Twin Cabin

- Single beds x 2
- Wardrobe
- Under bed storage

- Cabinet and drawers
- TV 19"
- Air conditioning
- Premium fitted carpet

Dayhead

- Basin with mixer
- Exhaust fan
- Vacuum toilet
- Timber shower grate
- Frameless glass shower door
- Bath and hand towel rails
- Mirror
- Amitco flooring

Crew Cabin and Head

- Single bed
- Pullman bunk *
- Wardrobe
- Storage under bed
- LCD/DVD TV
- Air conditioning
- Shower
- Toilet
- Basin with mixer
- Mirror
- Washer/dryer *
- Fold down ironing board *

Please Note :

Options * - Items are Optional with the (*) at end of each listed, prices available upon request. Not all features are standard due to differences in Owner configurations. Don't see something you would like? Please contact us directly to discuss.

Optional Features

- Built in 1E & 2C USL Survey
- Teak and bow side decks
- Extra side opening helm door
- Stern thruster
- Retractable sun shade
- Capstans
- Trim tabs
- BBQ fridge locker
- Coffee machine
- Hand held engine control remote
- Caterpillar upgraded gauges

Mechanical Disclaimer

Engine and generator hours are as of the date of the original listing and are a representation of what the listing broker is told by the owner and/or actual reading of the engine hour meters. The broker cannot guarantee the true hours. It is the responsibility of the purchaser and/or his agent to verify engine hours, warranties implied or otherwise and major overhauls as well as all other representations noted on the listing brochure.

Disclaimer

The company offers the details of this vessel in good faith but cannot guarantee or warrant the accuracy of this information nor warrant the condition of the vessel. A buyer should instruct his agents, or his surveyors, to investigate such details as the buyer desires validated. This vessel is offered subject to prior sale, price change or withdrawal without notice.

AQUABAY YACHTS and Builder reserves the right to modify specifications/inclusions/options.



Aquabay 70 express Also Available in Flybridge version



Running shot

OLYMPIA EXPRESS 70



PETER LOWE DESIGN

Design with Blue Hull Original Concept Design



Running shot B



Awning Convertible settee and awning over aft deck



Open to Aft Deck Welcoming entry and window



Helm Seating options and great visibility



Helm Details Custom helm



Overhead sun hatch Bright and open design- Sunroof Open



Interior Salon Salon to Bridge View- Sunroof Closed



Side Deck details Frameless windows



Foredeck Settee Excellent use of space



Side deck A



Twin Berths



Lower galley Additional galley or laundry space



Salon to Aft Deck Bright open design on main deck



Full beam Master Starboard view



Master and Ensuite Full beam Master and head



VIP Cabin



Engine Room



Foredeck details Sunpad - Sidekicks- Helm



Aft Deck Bar Seating Storage - Seating- Window Bar - Sunpad



Night shot Aft Deck and stair lighting



Sunset at speed



Profile Drawing

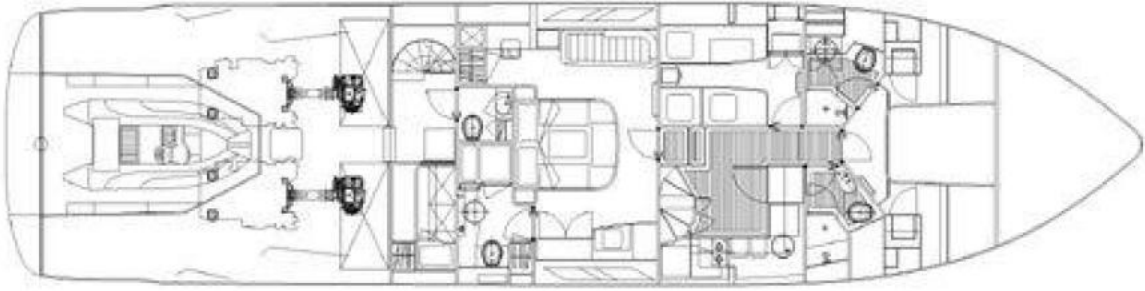

Main Deck Drawing

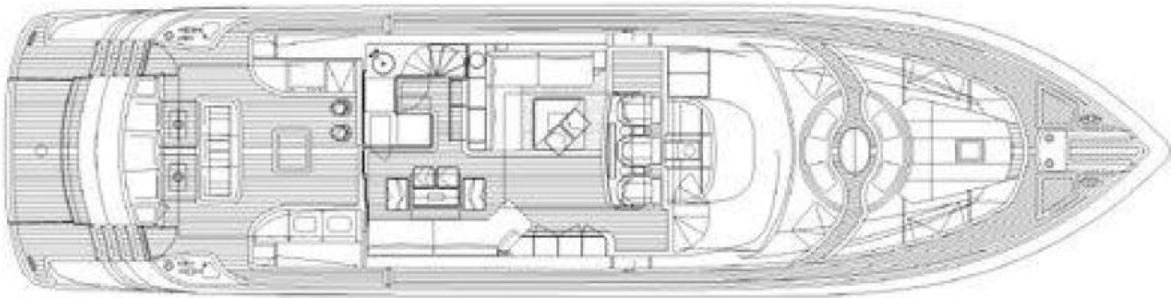

Flybridge Version Drawing