



Performance Catamaran

63' (19.20m) 2024 McConaghy Boats MC63P Tourer
Fort Lauderdale Florida United States



OVERVIEW

Manufacturer: *McConaghy Boats*

Engines:	2 Yanmar	Hull Material:	Other
Engine Model:		Cruise Speed:	20
Engine HP:	440	Max Speed:	36
Beam:	31' 1"	Cabins/Heads:	4 / 4
Max Draft:	4' 7"	Fuel Type:	Diesel
Water:	1500 G (5678.12 L)	Fuel:	8000 G (30283.28 L)

\$4,549,550



Data Sheet

Category: Catamaran	Maximum Speed: 36 Cruise Speed: 20	Bow Thruster: Yes
Condition: New	Range NM: 1500	Fuel Tank: 8000 gal (30283.28 liters)
Model Year: 2024	Fuel Type: Diesel	Fresh Water: 1500 gal (5678.12 liters)
Beam: 31'1" Max Draft: 4' 7" LOA: 63' 3" (19.30m)	Hull Material: Other	Builder: McConaghy
Cabins: 4	Hull Shape: Catamaran	Designer: Ker Yacht Design
Single Berths: 2	Hull Finish: Two Pack polyurethane coating	Interior Designer: Ker Yacht Design
Double Berths: 3	Air Conditioning: Yes	HIN/IMO: SpecOrderTBD
Heads: 4		Stock #: B91846

Engines/Generators

Engine 1

Yanmar
Inboard
440HP
Fuel: Diesel
Year: 2023
Location: Port

Engine 2

Yanmar
Inboard
440HP
Fuel: Diesel
Year: 2023
Location: Starboard

Generator 1

Onan
MDKDU with moisture eliminator and insulation (USA)
27KW

Summary/Description

"Quality, Custom-Builds & Lightweight, this is McConaghy." McConaghy is proud to now introduce an entire line of Cruising Multihulls. Drawing on their 50 years of yacht building excellence, and reputation for creating some of the world's best performing race boats.

McConaghy's continual innovation and investment in new materials and technologies, has allowed the builder to firmly establish their position at the forefront of progressive high-performance and now also luxurious yacht building.

The MC63 is the flagship power model and utilizes highly optimized hull forms combined with the already iconic lines of the McConaghy. This strong, light, and powerful motor yacht is the first among its peers to offer both coastal cruising.

Available- MC63P Tourer Version

McConaghy's carefully considered use of carbon and precise hull forms allows the MC63P Tourer a fuel-efficient vessel at lower speeds, while still being able to achieve top speeds above 20kts.

The MC63p Tourer offers two flybridge layouts to choose from. This model has the highly desirable Front Cockpit and Opening Forward Weathertight Door. Versatile interior arrangements are available, allowing for a three or four-cabin layout.

Introducing McConaghy's Power Catamaran - MC63P Tourer

McConaghy Multihulls is the latest product range from McConaghy, drawing on our 50 years of yacht-building excellence, as well as a storied history in creating some of the world's best-known and best-performing race boats. Our continual innovation and investment in new materials and technologies have allowed us to firmly establish our position at the forefront of progressive high-performance yacht building. McConaghy is proud to now introduce an entire line of cruising multihulls to our portfolio, created in collaboration with world-leading designers. The MC63p Tourer features clean lines, apartment-style living, and an overall open and modern dynamic that simultaneously enables more comfortable cruising and better performance; a feat not yet achieved in any other line of a multihull. The MC63p Tourer is our flagship power model and utilizes highly optimized hull forms combined with the already iconic lines of the McConaghy MC62. This strong, light, and powerful motor yacht is the first among its peers to offer both coastal cruising and the capability for far-flung oceanic adventures.

MC63P Tourer Version Equipment & Options Configured

Aft Main Deck

- Frameless, bi-folding, tempered safety glass doors between the saloon and aft deck
- Clear carbon stairs and handrails to the flybridge with illuminated steps
- Aft deck settee with reversible lounge and table
- Outdoor aft deck rain shower recessed into flybridge structure, hot/cold mixer tap
- Hydraulic swim platform/tender lift with remote control, Seasmart tender cleats, safety locks, folding padeyes (x4), and deck sockets for passerelle and swim ladder
- Recommend tender: OC350 (tender optional)
- Telescopic swim ladder neatly housed in the transom

FWD Deck:

- Fwd cockpit door
- Fwd settee, table, and sunbed

Saloon to Starboard

- Electric sliding main saloon windows
- L-shaped settee with bench seats, cushions
- Dining table with fold-out extensions on electric struts lowers to become a coffee table

Port Side Galley and the "Island"

- Electric sliding saloon windows with safety locks
- Skylights extending the length of the saloon over the Island and Galley
- Expansive custom Corian countertops
- Twin stainless steel sinks
- Stainless steel Isotherm 160L draw fridge
- Stainless steel Isotherm 160L draw freezer
- Electric oven and cooktop

FlyBridge

- Enlarged flybridge, with offset spiral stairs to port, sunbeds and a central dining area with a bench seat in front, Central helm station
- Lounge area with wrap-around seating
- Flybridge Sunbrella cushions
- McConaghy carbon fiber steering wheel

Mid Ship Lounge / Den

- Sofa
- Custom cabinetry with soft close drawers
- Large articulating TV Cabinet (TV not included) or bookshelf/storage

Entertainment

- Fusion entertainment system - Four (4) speakers

Rudder and Steering

- Twin Rudders
- Hydraulic Steering

Anchoring & Mooring

- One (1) Lewmar V4 Electric Windless

Misc Deck Hardware

- McConaghy composite stanchions
- Solid stainless steel bow rails

MC63P Tourer Version As-Option Equipment Included:

Interior / Exterior Loose Parts

- Two (2) Saloon Ottomans
- Eighteen (18) Interior/Exterior Scatter Cushions (choice of Sunbrella fabrics)
- Sunbrella and weathermax foam cushions for the foredeck lounge
- For twin berths cabins: Panel insert to convert to a large double berth

House/Domestic Equipment, Batteries, and Inverters

- Generator 12kW Fisher Panda (USA)
- Air conditioning (reverse cycle Heat/Cool) - 3 cabins and Saloon
- Water maker - 110L - Spectra Newport 700cc
- Dishwasher - 12 sets - Siemens/Bosch
- Microwave oven - Siemens/Bosch
- Washer/Dryer
- Upgrade fridge to 190L - Isotherm
- Additional 160L stainless steel drawer freezer - Isotherm
- Wine fridge (20 bottles) - Vitrifigo
- Ice Maker 23L - Isotherm
- One (1) Interior cabin fan
- Additional 110/230V socket
- Additional 12/24V or USB socket
- Four (4) Ocean LED Underwater Lights

Aft Deck

- Gas Barbecue - Magma
- Shore water inlet regulator located starboard transom inner topsides
- Removable dingy chocks with fast pins and stainless ratchet straps
- Carbon fiber swim ladder (includes brackets for storage in the engine room)
- McConaghy carbon fiber foldable passerelle customized with boat's name, bag, stanchions, (x2), ropes, clear chequer plate, non-skid, racks for stowage in the engine room and deck fittings

Flybridge

- Hard top composite flybridge cover with four (4) overhead LED lights
- Soft Storm dodger for the hard top, clear sectional panels, zippers and tracks, can enclose the whole flybridge
- Soft clear aft for enclosed flybridge
- Protective fabric covers for helm stations (x1)
- Cushions for a flybridge seating area - Sunbrella & Weathermax foam

Real Teak Optioned for:

- Teak floor on the aft deck, swim platform, stairs to side deck, stairs to flybridge, and flybridge sole

Engines, Tankage, Batteries, and Solar Power

- **Upgrade to twin (2) 440hp Yanmar engines**
- Portable electrical engine throttle control
- One (1) Auto transformer (for USA if two inverters are selected)

Docking and Anchoring Pack

- Six (6) inflatable fenders (1500 x 450mm) with covers, portable electric pump, and fender lines Carbon fiber boat hook: Six (6) 22mm mooring lines, cored, spliced, looped and whipped: Anchor Bridle, 22mm with chain hook

- Chain counter and windless control on flybridge console
- Two (2) stern cleats for Med mooring
- Two (2) Mooring winches - Lewmar C3 or equivalent
- Upgrade to S/S Lewmar 40kg Anchor

Raymarine Navigation & Electronics

- AIS 650 Class B Transceiver +Active AIS Splitter 100 | 4kW 24" (608mm) HD Color Radome | CP370 ClearPulse 1KW Sonar Module | Evolution Autopilot with p70Rs control head & ACU-400, EV1 Sensor Core, EV1 Cabling kit (suitable for Type 2 & 3 drives) | Ray63 VHF Radio with Integrated GPS receiver | Raystar 150 10Hz GPS/Glonass antenna| 16" Multi-function Display with integrated High CHIRP Conical Sonar for CPT- S | Foward Scan Radar

Entertainment

- Allowance for accepting 49" FlatscreenTV by navigation station (electrically deployed, articulating, TV owner supplied)
- Outdoor Speaker Pack - four (4) additional Fusion Speakers - two (2) Flybridge
- Four (4) Bose overhead speakers in the saloon

Miscellaneous

- McConaghy Sata Toolbox
- Antifouling
- Shrink wrap the whole boat

Additional Options Below (Not Included in Price)

- 4 x Cabin version - extra double berth cabin in Starboard Hull

House/Domestic Equipment, Batteries, and Inverters

- Alternate Config for Generator 12kW Fisher Panda (Europe)
- Alternate Config for Air conditioning (reverse cycle Heat/Cool) - 4 cabins and Saloon
- Options for various Water makers - 67-155L - Spectra Newport

Aft Deck

- OC 350 Tender Pack including Yamaha 15hp 4-stroke and boat cover

Alternative Synthetic Teak vs Teak

- Synthetic teak on the aft deck, swim platform, stairs to side deck, stairs to flybridge, and flybridge sole, fwd cockpit

Engines, Tankage, Batteries, and Solar Power

- Solar panels on the coachroof, tredable, non-slip, conformed to the shape of the boat, including electrical regulators (price estimate)
- Solar panels on hard top flybridge cover including electrical regulators (price estimate)

Entertainment

- Allowance for accepting 49" FlatscreenTVfor Owner's Stateroom (Fold down form headliner,TV owner supplied)
- Wifi network consolidator, booster, and 4G antenna

- TV 5STV – 45cm Satellite TV Antenna System

Miscellaneous

- Option to Shrinkwrap whole boat

Disclaimer

The company offers the details of this vessel in good faith but cannot guarantee or warrant the accuracy of this information nor warrant the condition of the vessel. A buyer should instruct his agents, or his surveyors, to investigate such details as the buyer desires validated. This vessel is offered subject to prior sale, price change or withdrawal without notice.





































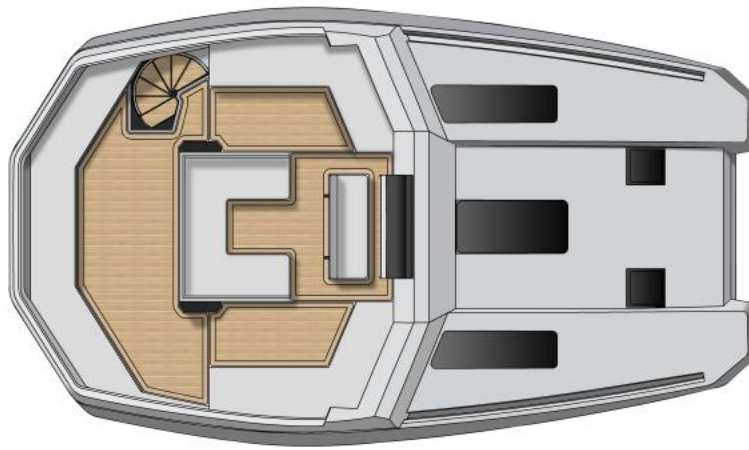

MC63_p TOURER
MULTIHULL

FLYBRIDGE



MC63_p TOURER
MULTIHULL

MAIN DECK

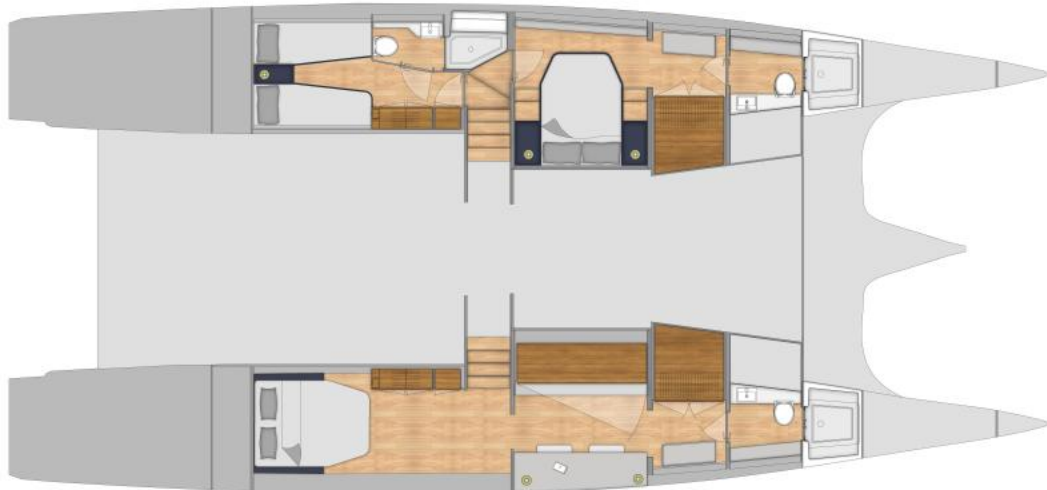

MC63_p TOURER
MULTIHULL

3 CABIN LAYOUT

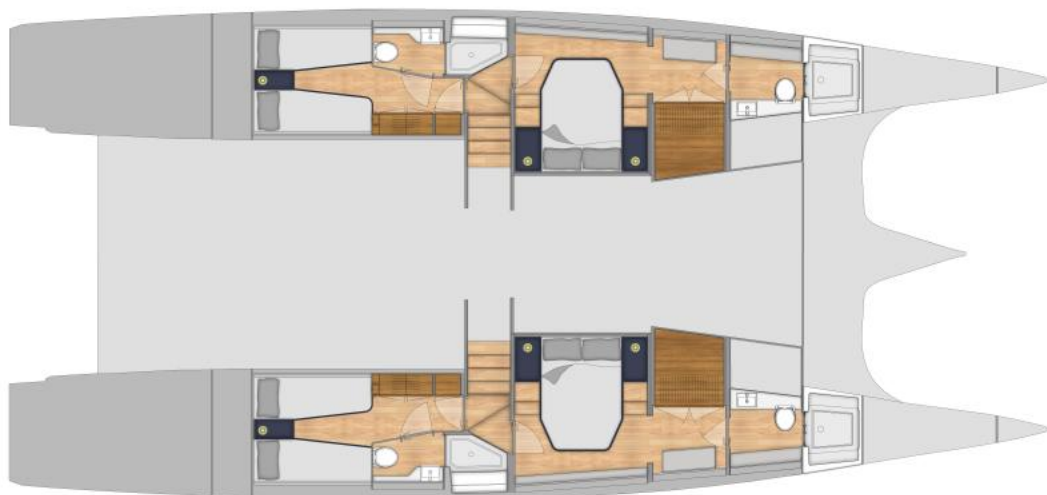

MC63_p TOURER
MULTIHULL

4 CABIN LAYOUT