



Performance Catamaran

82' (24.99m) 2024 McConaghy Boats 82P
Fort Lauderdale Florida United States



OVERVIEW

\$7,075,000

| | | | |
|---------------|------------------------|----------------|--------------------|
| Manufacturer: | <i>McConaghy Boats</i> | | |
| Engines: | 2 Scania | Hull Material: | Composite |
| Engine Model: | | Cruise Speed: | |
| Engine HP: | 875 | Max Speed: | |
| Beam: | 33' 5" | Cabins/Heads: | 5 / 6 |
| Max Draft: | " | Fuel Type: | Diesel |
| Water: | 396 G (1499.02 L) | Fuel: | 2113 G (7998.57 L) |



Data Sheet

Category: Catamaran
Condition: New
Model Year: 2024
Beam: 33'5" (10.19m)
LOA: 82' (24.99m)
Cabins: 5
Double Berths: 5
Heads: 6

Fuel Type: Diesel
Hull Material: Composite
Hull Shape: Catamaran

Fuel Tank: 2113 gal (7998.57 liters)
Fresh Water: 396 gal (1499.02 liters)
Holding Tank: 132 gal (499.67 liters)
Builder: McConaghy Boats
Designer: Malcolm McKeon Yacht Design
HIN/IMO: SpecOrderTBD
Stock #: B90850

Engines/Generators

Engine 1

Scania
Inboard
875HP
Fuel: Diesel
Year: 2023
Location: Port

Engine 2

Scania
Inboard
875HP
Fuel: Diesel
Year: 2023
Location: Starboard

Summary/Description

"Quality, Custom-Builds & Lightweight, this is McConaghy." McConaghy is proud to now introduce an entire line of Performance Luxury Multihulls. Drawing on their 50 years' of yacht building excellence, and reputation for creating some of the world's best performing race boats.

McConaghy's continual innovation and investment in new materials and technologies has allowed the builder to firmly establish their position at the forefront of progressive high-performance and now also luxurious yacht building.

The MC82P features clean lines, apartment-style living and an open modern dynamic that simultaneously enables comfortable cruising and better performance. She has been designed with the performance cruiser in mind. Whether you're an experienced multihull yachtsman or new to the genre, whether you seek bluewater adventures or coastal cruising with friends and family, these innovative multihulls offer impressive performance in a stylish and luxurious package.

Specifications Pricing & Options as Configured \$6.7M

McConaghy MC82P - Specifications Pricing and Options as Configured 5-2022

Aft Main Deck

- Tempered safety glass sliding doors between saloon and aft deck
- Clear carbon off center stair and handrail to fly bridge with illuminated steps on stbd aft side deck
- Forward facing settee and table
- Day bed on starboard
- Bar on port with single large stainless sink
- One (1) x drawer fridge recess under bar
- One (1) x ice maker
- Transom steps, port and starboard, with discreet lighting
- Outdoor aft deck rain shower recessed into flybridge structure, hot/cold mixer tap

Forward Cockpit

- Two (2) forward facing doors
- Settee/Sunbed port and starboard
- Steps to forward bridge deck

Saloon Aft Starboard

- Electric sliding main saloon windows with safety locks
- Settees with bench seats, cushions

Port Side Galley & the "Island"

- Two Fisher & Paykel integrated drawer fridge/freezers
- One (1) x Hob (4 unit induction) Miele AEG IPE64551FB or similar
- One (1) x Oven - Miele or similar
- One (1) x Microwave oven Miele or similar
- One (1) x Dishwasher Miele or similar
- One (1) x Drawer fridge Vitrifrigo DW180.RFX or DTX or Isotherm
- One (1) x Wine cooler Miele or similar
- Expansive Corian counter tops
- Double bowl stainless steel sink

Saloon Forward

- L shape settee to starboard

Helm Station

- Single built in helm station with good visibility
- McConaghy custom carbon fiber steering wheel
- Two (2) helm seats included
- 110/230V AC and USB Sockets, Cordless phone charges
- 2 side opening windows, 2 FWD opening windows

Flybridge

- L shape settee with storage under to port
- One (1) Coffee table
- One (1) dining table for 10 in center (loose furniture owner supply)
- Single stainless-steel sink
- One (1) x Drawer fridge
- One (1) x Wine cooler
- One (1) x Icemaker

Utility Room

- CAVE under floor for food and wine storage
- Separate washing machine and Induction dryer (heat pump type)
- One (1) sink with cabinet and hot/cold mixer tap
- Electric freshwater toilet
- Shower with quality fittings, Corian sole and inboard hatch
- Overhead and floor level recessed courtesy lighting and down lights

Crew Cabin

- Storage under berth, raises on gas struts
- Two (2) Hanging lockers

- Large seaward facing side window
- Overhead and floor level recessed courtesy lighting and down lights

Engine

- 2 x 2 x Scania 875hp engines with 2 x gearboxes ZF370V with shaft drives
- Electronic throttle control mounted to helm
- Docking station in cockpit
- Mastervolt Alpha alternator 24/150 fitted to both main engines
- Engine instrument panel at helm position
- Four (4) Fuel tanks in total approx. capacity 8000L
- Racor500 fuel filters
- Two Day Tanks with fuel polish system
- Rope cutters on the propeller shafts

Plumbing

- Six (6) Rule automatic bilge pumps (2,000GPM each)
- Pressurized hot & cold water system
- Two (2) Isotherm water heaters - 75 Liter tanks
- Two (2) Fresh water pump MXHM204 Calpeda
- Two (2) Black water tanks Sealand DTW-Waste Discharge Pump
- Two (2) x Sea Recovery water makers 2 x 200 LPH or similar
- Fresh water tanks approx 1500L
- Black/Grey tank approx 500L

Power Supply

- Four (4) 160AH AGM Main Engine Start Batteries
- Eight (8) x Lithium Ion Batteries (180Ah/per each)
- Four (4) x Mastervolt 24/4000w inverters
- One (1) x Generator Onan 27kw

Navigation

- Autopilot, with control head (Raymarine p70).
- 2 x Multifunctional display Raymarine Axiom Pro 16" (flybridge helm)
- Radar Raymarine open array 4ft 4kW HD Color
- 2 X Raymarine day/night docking camera (at cockpit ceiling, aft-facing)
- 2 x Raymarine ER cameras
- Raymarine i70, echo sounder, GPS Raymarine RS130, VHF (with antenna), AIS (with antenna), including Raymarine backbone and cables

Air Conditioning

- Aircon package 228K BTU with 12 air handlers

Interior and Navigation Lighting and DC Power

- CZone Digital Switching System including touch screen, ipad compatible, voltage, tank, bilge and fuse alarms, lighting (switches and dimmers), custom controls hydraulic transom
- Interior down lights
- One (1) Red/White nav stn light
- USB outlets in cabins and helm
- Induction phone chargers at helm
- Induction phone chargers either side of beds

Rudder and Steering

- Twin rudders
- Hydraulic steering

Anchoring & Mooring

- One (1) electric windlass Lewmar V8
- One (1) 80kg galvanized anchor, 150m galvanized chain, and 100m warp
- Eight (8) x 300mm folding cleats
- Two (2) x pop up cleats in transom

Shipping Cradle

- One (1) electric windlass Lewmar V8

Tender Lift

- Hydraulic tender-lift swim platform pay load 1500Kg

Bow Thrusters

- One electric thruster, One hydraulic thruster

Fire Detection System

- Fireboy ASM Addressable Fire Detection for interior and engines

Boarding

- One (1) x MCB carbon passerelle
- One (1) x MCB carbon swim ladder

Options As Configured (Included at \$6.7M)

- One (1) x MCB retractable carbon swim ladder
- One (1) x MCB side boarding ladder
- Two (2) x Oil Change system
- Chain counter (flybridge)
- One (1) x waterproof white horn speaker
- One (1) x Searchlight ACR RCL-100 LED
- Entertainment Package: One (1)x 55" TV with electric rotate/lift at aftdeck, One (1)x 70" TV with electric rotate lift in saloon, Fusion speakers x (4) package
- Six (6) x underwater lights
- Three (3) x flood lights
- Wireless outdoor speakers x four (4) for flybridge

Additional Options Below (Not Included in Price)

- Sunpower solar panel, total 6.78kw (To be reviewed to have enough solar panels to recharge house batteries during construction)
- One (1) x MCB retractable carbon diving ladder
- Wifi network consolidator, booster and 4G antenna

Disclaimer

The company offers the details of this vessel in good faith but cannot guarantee or warrant the accuracy of this information nor warrant the condition of the vessel. A buyer should instruct his agents, or his surveyors, to investigate such details as the buyer desires validated. This vessel is offered subject to prior sale, price change or withdrawal without notice.



































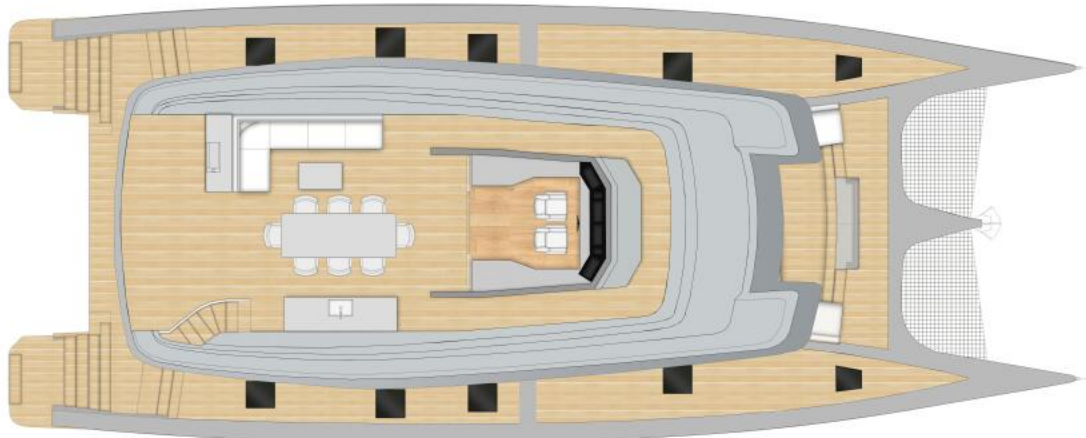

MC82_p
MULTIHULL

FLYBRIDGE



MC82_p
MULTIHULL

CABIN LAYOUT

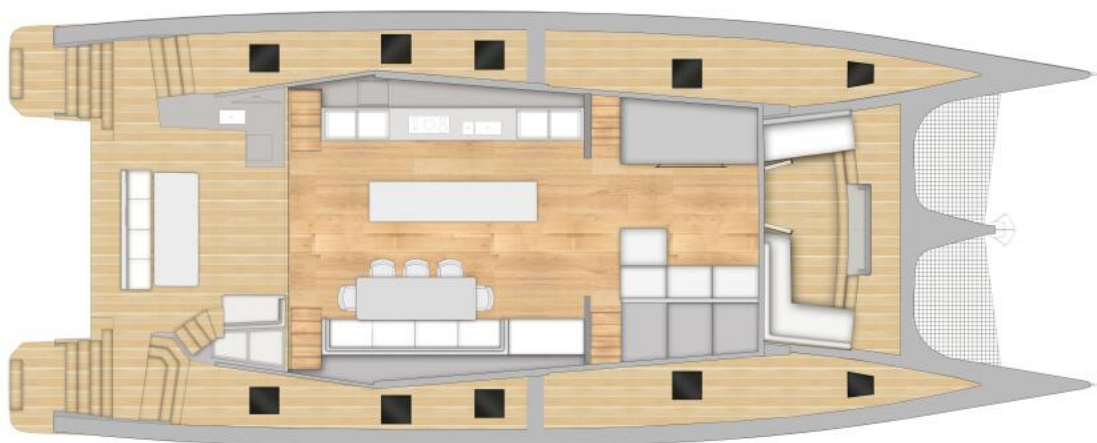

MC82_p
MULTIHULL

MAIN DECK

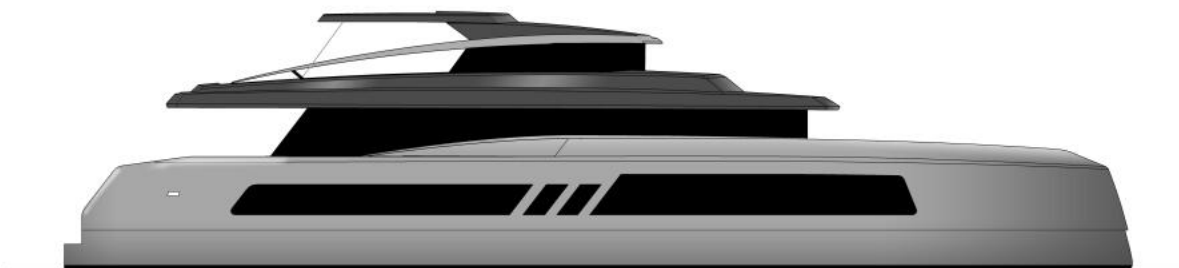

MC82_p
MULTIHULL

PROFILE