



85' (26.00m) 2024 Aegean Yacht Explorer M26
Bodrum Turkey



OVERVIEW

Manufacturer: *Aegean Yacht*

Engines:	2 MAN	Hull Material:	Steel
Engine Model:	D2676LE425	Cruise Speed:	10 Knots
Engine HP:	650	Max Speed:	12.7 Knots
Beam:	22' 7"	Cabins/Heads:	6 / 7
Max Draft:	6' 10"	Fuel Type:	Diesel
Water:	1611.45 G (6100 L)	Fuel:	4327.14 G (16380 L)

€5,650,000



Data Sheet

Category: Motor Yachts
Subcategory: Expedition Yacht
Condition: New
Model Year: 2024
Beam: 22'7" (6.90m)
Max Draft: 6' 10" (2.10m)
LOA: 85' (25.91m)
LWL: 77' (23.48m)
Cabins: 6
Sleeps: 12
Twin Berths: 2
Queen Berths: 4
Heads: 7

Crew Cabins: 4
Crew Sleeps: 4
Maximum Speed: 12.7 Knots
Cruise Speed: 10 Knots
Range NM: 3500
Fuel Type: Diesel
Super Structure Material: Aluminium
Hull Material: Steel
Air Conditioning: Yes

Gross Tonnage: 187
Displacement: 165 tonnes
Bow Thruster: Yes
Fuel Tank: 4327.14 gal (16380 liters)
Fresh Water: 1611.45 gal (6100 liters)
CE Certified: Yes
MCA Certified: Yes
Builder: Aegean
HIN/IMO: PENDING
Stock #: B93289

Engines/Generators

Engine 1

MAN
D2676LE425
650HP
484.71KW
Fuel: Diesel

Engine 2

MAN
D2676LE425
650HP
484.71KW
Fuel: Diesel

Generator 1

KOHLER
EFKOZD
35KW

Generator 2

KOHLER
EFKOZD
35KW

Summary/Description

Having launched the first unit of this new line of explorer yachts in 2022, hull #2 of this genuine 6 cabins world cruiser is available with short delivery time from experienced yacht builder, Aegean Yacht.

Having launched the first unit of this new line of explorer yachts in 2022, hull #2 of this genuine 6 cabins world cruiser is available with short delivery time from experienced yacht builder, Aegean Yacht.

Designed and developed entirely inhouse by the Aegean team, this go everywhere, genuine world cruiser has a steel hull with aluminum superstructure ensuring a stable ride and excellent handling while at sea.

The intelligently designed general arrangement and generous interior volumes, particularly for a yacht of her length, has allowed for up to 6 guest cabins including 3 full-beam master suites, catering to 12 guests. The standard configuration includes three almost identically sized "owner cabins" – ideal for use in charter – a VIP double as well as two twin berthed cabins, all with ensuite facilities. An alternative layout allows for a generous sky lounge – replacing the bridge deck master state room – but reduces capacity to 10 guests, more than enough for the majority of yacht owners of vessels of this size.

The main deck saloon is light and airy thanks to large windows on all sides and offers comfortable dining for guests. The combination of warm oak furniture and parquet floors with stainless steel accents and white lacquered ceilings ensures her interior is warm and elegant, yet understated.

Forward of the saloon on the port side is a large galley, including crew mess as well as a crew staircase to the lower deck, another clever feature which allows for crew to seamlessly pass around the yacht to deliver the 6 star service required.

Outside areas are equally generous with multiple separate areas for guests to enjoy, including on the bridge deck forward, aft of the sky lounge / mast cabin, on the main deck, aft of the main saloon, and the large swimming platform.

Powered by two MAN 650 HP engines, she achieves a maximum speed of almost 13 kts, with cruising speed at 11kts. A range of over 3,500 nautical miles, huge storage areas together with separate, individual cabins for the 4 crew, makes her an ideal vessel for long stays and journeys to remote and unique destinations.

ABOUT AEGEAN YACHT

AEGEAN YACHT was founded by Sinan Ozer in 1976. Production is based at two full service, seafront boatyards in Bodrum and Antalya freezone in Turkey. Initially dedicated to wooden yacht construction, for the last 20 years the shipyard has focused on refit work as well as new build, full & semi-custom yachts built from steel & aluminum. In the

almost 50 years since opening the doors, the shipyard has delivered more than 50 yachts, from 20 to 57m, across both sail and power.

HULL AND SUPERSTRUCTURE

The Hull of the Vessel shall be built of A and/or AH grade Marine steel and the Superstructure of the Vessel shall be built of Marine Grade Aluminium according to CE requirements.

DECK EQUIPMENT

Two DATA DZC 1400 hydraulic vertical windlasses at fore main deck with rope drums.

Two stainless steel FOB HHP anchors as per CE rules.

Two, size, as per CE rules, studlink galvanized anchor chains with 2 swivels, 137,5 meters each, Ø 12.5 mm

Stainless steel bollards and fairleads,

Mooring ropes, 24 mmø, 2 x 80 m. & 24 mmø, 1x 100 m.

Two DATA DHC 1000 hydraulic capstans aft,

Hydraulic swimming platform

Fuel and water inlets,

Standard sanitary outlet

MACHINERY AND MAIN PROPULSION

1. Main Engines

Two MAN D2676LE425 650 HP @ 2100 RPM marine diesel Engine Medium Duty with ZF reverse reduction gears to be controlled from wheel house & aft deck.

2. Propulsion Gear

Two reverse reduction gearboxes ZF 550-1A with reduction ratio of 2.96:1.

The gearboxes will be connected to the stainless-steel shafts with flexible couplings.

3. Propellers & Stern tubes & Bow thrusters

Two ERIS or equivalent well balanced manganese bronze propellers to be supplied and installed.

Propeller shafts in 316 L stainless steel or duplex steel diameter as per CE rules.

Seamless steel stern tubes. Bronze stern glands.

4. Main Diesel Generators

Diesel generators, KOHLER or equivalent brand, 2 x 35 kW.

The generators will be furnished with sound insulation cabins and installed on steel foundations with rubber chocks.

5. Pumps

GIANNESCHI or equivalent pumps to be installed as per rules.

All pumps have to be installed on rubber chocks.

All pumps to be installed with by-pass emergency systems.

6. Fire-Fighting System

A fixed & remote controlled NOVEC 1230 fire-fighting system for fire protection of engine room to be supplied and installed.

The system will be installed in the engine room in compliance with regulations. Number and type of detectors according to CE requirements.

The accommodation will have an extensive fire detection system, with signals in the main fire alarm panel.

ACCOMMODATION

Cabins:

Owner:

Full beam master suite on the upper deck with large sliding glass door opening to a private upper aft deck

Guests:

2 x additional full-beam master suites on main and lower deck

1 VIP cabin

2 x Twin cabins

Crew:

4 x Single cabins with their own individual bathroom, accommodating 4 crew

DOMESTIC APPLIANCES & GALLEY EQUIPMENT

POLYCOR or equivalent acrylic counters & non skid ceramic floors

SIEMENS or equivalent refrigerator / freezer

SIEMENS or equivalent cook top 4 burners, electric

SIEMENS or equivalent overhead hood

SIEMENS or equivalent electric oven

SIEMENS or equivalent dishwasher

NAVIGATIONAL ELECTRONIC EQUIPMENT

Given for indication only; a new owner can upgrade or change the below:

SIMRAD GB 12 INCH GLASS BRIDGE DISPLAY I-marine TCBS CLASS B AIS

SIMRAD BSM-1 BROADBAND SOUNDER SIMRAD B260 1 KW TRANSDUCER SIMRAD HALO20 RADAR

SIMRAD AP44 AUTO PILOT

SIMRAD RS 20SVHF RADIO WITH CLASS-D DSC

NAVIONICS Aegean Sea, Black and Mediterranean Sea Chart SIMRAD HS75 GPS COMPASS

FURUNO NX300 NAVTEX RECEIVER INTELLIAN i6P SAT TV

Disclaimer

The company offers the details of this vessel in good faith but cannot guarantee or warrant the accuracy of this information nor warrant the condition of the vessel. A buyer should instruct his agents, or his surveyors, to investigate such details as the buyer desires validated. This vessel is offered subject to prior sale, price change or withdrawal without notice. Any vessel that is not U.S. flagged and has not paid U.S. duties cannot be offered for sale to U.S. residents whilst in U.S. waters.





























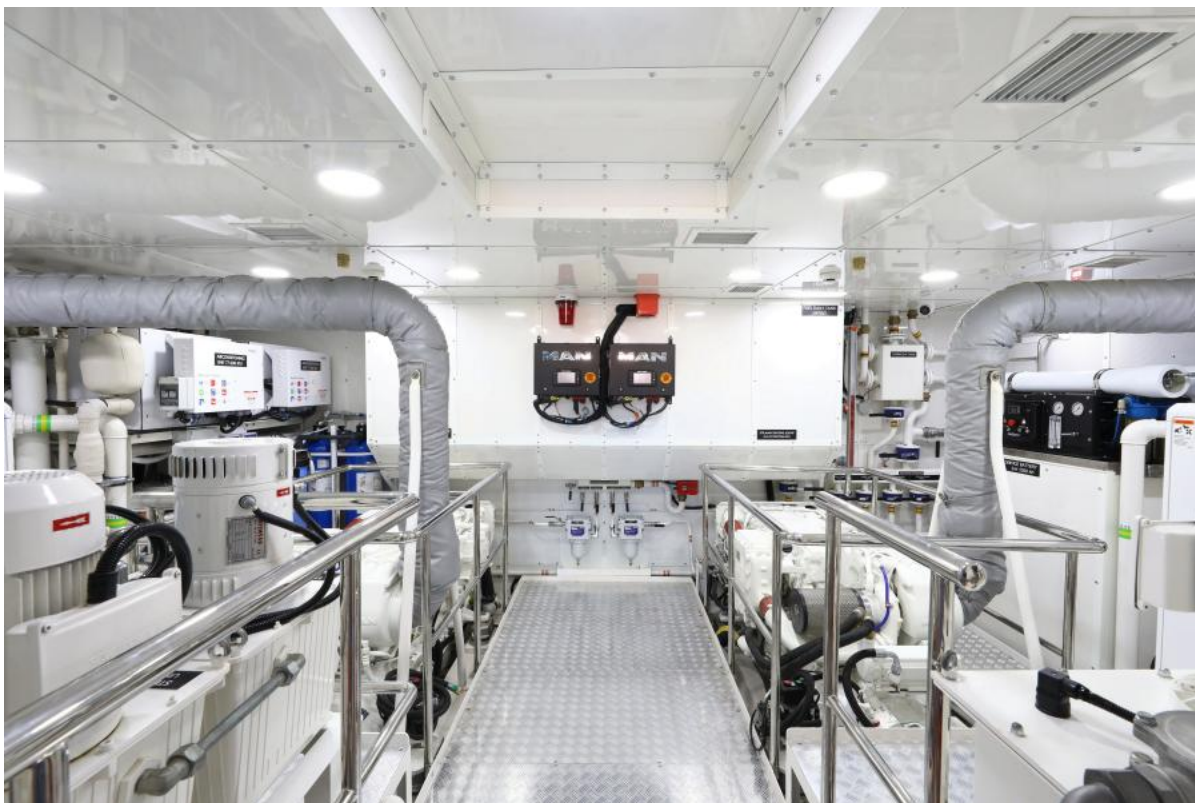

LOWER DECK



MAIN DECK



UPPER DECK



ALTERNATIVE UPPER DECK OPTIONS:

1. SKY LOUNGE ON UPPER DECK AND JACUZZI ON BOW AREA

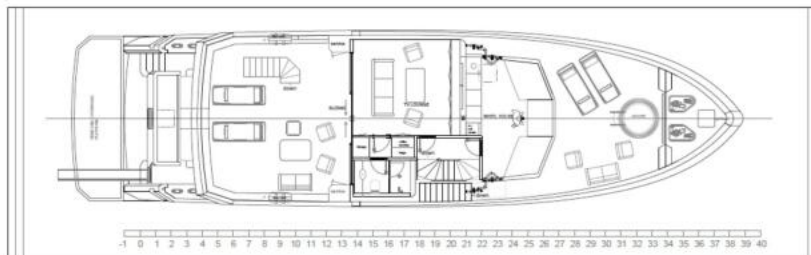

2. GYM ON UPPER DECK AND LARGE SUNBED ON BOW AREA

