



# SOVEREIGN

100' (30.48m) 1966 Burger  
Palm Beach Florida United States



## OVERVIEW

Manufacturer:	<i>Burger</i>		
Engines:	2 Cummins	Hull Material:	Aluminum
Engine Model:	QSM11	Cruise Speed:	12 Knots
Engine HP:	580	Max Speed:	14 Knots
Beam:	21' 10"	Cabins/Heads:	4 / 5
Max Draft:	5' 6"	Fuel Type:	Diesel
Water:	3600 G (13627.48 L)	Fuel:	6000 G (22712.46 L)

**\$2,100,000**



## Data Sheet

Category: Motor Yachts  
Condition: Used  
Model Year: 1966  
Refit Year: 2020  
Beam: 21'10" (6.65m)  
Max Draft: 5' 6" (1.68m)  
LOA: 100' (30.48m)  
Cabins: 4  
Sleeps: 7  
Heads: 5

Crew Cabins: 3  
Crew Sleeps: 4  
Maximum Speed: 14 Knots  
Cruise Speed: 12 Knots  
Fuel Type: Diesel  
Hull Material: Aluminum  
Hull Shape: Displacement  
Hull Finish: Awlgrip

Gross Tonnage: 150  
Stabilizers: Standard  
Stabilizer Brand: Quantum  
Bow Thruster: Yes  
Fuel Tank: 6000 gal (22712.46 liters)  
Fresh Water: 3600 gal (13627.48 liters)  
Builder: Burger  
Designer: Jack Hargrave  
Interior Designer: Jack Hargrave  
HIN/IMO: 0000

## Engines/Generators

### Engine 1

Cummins  
QSM11  
Inboard  
580HP  
432.51KW  
Fuel: Diesel  
Hours: 1885  
Hours Date: 05-01-2023  
Year: 2007  
Location: Port

### Engine 2

Cummins  
QSM11  
Inboard  
580HP  
432.51KW  
Hours: 2033  
Hours Date: 05-01-2023  
Year: 2007  
Location: Starboard

### Generator 1

Onan  
55KW  
1800.00RPM

### Generator 2

Onan  
55KW  
1800.00RPM

## Summary/Description

SOVEREIGN is a 100' (30.48m) Burger motor yacht delivered in 1966, refit in 2020 with many upgrades throughout the last few years. Accommodations include 4 staterooms sleeping 7 guests with 4 crew in 3 cabins.

## Overview

SOVEREIGN is a stunning vintage Jack Hargrave-designed Burger that has been continually maintained and upgraded over time by conscientious owners and a professional crew. Accommodation for up to 8 guests is found in 4 beautifully appointed ensuite staterooms. Presented in beautiful condition, she essentially needs nothing beyond a new owner's personal touches to enjoy immediate use.

Nearly every system, finish, and feature has been either upgraded or improved aboard SOVEREIGN in recent years. Paint, decks, head system, new Cummins QSM11's main engines and Onan 55kw generators, new galley appliances, refreshed interior, new bar area, new upper flybridge lounging area, and a custom swim platform extension with stairs. No expense has spared aboard SOVEREIGN to ensure her head turning appearance and ready to go condition.

### Key Features

- QSM11 engines, gears, exhaust system, and Onan Generators new in 2007
- Refreshed interior with new custom bar area forward in the salon
- Fully updated and recent navigational electronics and communications systems
- Redesigned custom swim platform and stern boarding stairs

## Guest Accommodations

The uniquely styled chic interior of SOVEREIGN has been through a custom refit by American Custom Cabinetry and Ellen Kavanaugh interiors of Palm Beach. Unlike many other classic yachts, the interior of SOVEREIGN is bright, airy, and crisp. The main salon is a comfortable place to entertain, thanks to her recent custom bar area forward, or watch a movie on the hidden TV. The aft deck features a larger than normal lounging settee and a beautiful custom-fitted sliding high low dining table finished in high gloss teak. A cleverly redesigned formal dining room forward now functions as an "eat-in-kitchen". The galley has been recently upgraded with first-class stainless steel appliances and provides excellent facilities and prep/plating space for any chef. Accommodation for 7 guests in 4 traditionally appointed ensuite staterooms is below and aft. Crew accommodation for 5 in 3 staterooms is below and forward.

### Owners Midship Stateroom

- Bed: Centerline King

- Head: (1) Remodeled with (1) oversized stall shower (2019)
- 2 x Large hanging lockers
- Very generous drawer and locker storage
- Desk to starboard
- Settee to port
- 5 x Opening ports
- Carpeted sole

#### Starboard Mid Stateroom

- Bed: Custom larger than twin berth
- Head: 1 x with 1 x Shower
- Hanging locker
- Bookcase
- 2 x Opening ports
- Vizo TV
- Carpeted sole

#### Port Aft Guest Stateroom

- Bed: 2 x Twin berths
- Head: 1 x with 1 x bathtub and shower
- Large hanging locker
- 2 x Opening ports
- Carpeted sole

#### Starboard Aft Guest Stateroom

- Bed: 2 x Twin berths
- Head: 1x with 1 x shower
- Large hanging locker
- 2 x Opening ports

- Carpeted sole

## Crew Accomodations

Accommodation for up to 5 crew is found forward via a private companionway between the Galley and forward dining salon. A large L-shaped settee and table provide ample lounging and dining space as well as direct access to the yacht's engine room. A second small "convertible" galley has been installed in the engineers cabin to allow for further crew privacy and a full entertainment system ensure the crew is entertained during their downtime. A large dry bilge storage area with five large custom refrigerator / freezers is located here as well for supplies, dry goods, and food storage.

### Captain's Cabin (Port)

- Bed: Single with storage drawers below
- Head: 1 x with 1 x shower
- Vinyl sole
- Reading lamps
- Pyle TV with DirectTV receiver
- Hanging locker
- (1) Portlight
- Upholstered stool and vanity

### Forward Cabin

- Bed: 2 x Twin bunk
- Head: 1 x with 1 x shower (Shared)
- 2 x Reading lamps
- 4 x Portlights
- Large overhead hatch with screen on centerline
- Vinyl sole
- Samsung TV with DirectTV receiver
- Anchor chain pipe leads to chain locker below sole

### Starboard Crew Cabin / Crew Galley

- Bed: 1 x Twin bunk

- Head: (1) with (1) shower (Shared)
- 1 x Portlight
- Sharp Carousel microwave oven
- GE Refrigerator
- Stainless sink with hot and cold faucet
- Summit 2-burner electric induction cooktop
- Stainless counter

#### Crew Mess / Lounge

- L-shaped settee, dining table, and chairs
- Dining table lowers to settee level to form another double berth
- Vinyl sole
- Samsung TV with DirectTV satellite receiver
- Sony PlayStation
- Sony stereo
- Custom solid surface table
- Bookshelves
- Washer and Dryer: Miele full size stackable units
- Weems and Plath clock
- Coffee maker

## Salon

- Carpeted sole
- Large hidden TV with DirectTV satellite receiver
- BlueRay disk player
- Apple TV
- Stereo with blu-tooth receiver
- 2 x Large middle windows raise and lower with screens
- Custom forward bar area with seating

- Thermadore stainless drink refrigerator
- Assorted furnishings and décor (2018)

## **Aft Salon and Lazarette**

- Refrigeration: 3 x Sub Zero Under-counter
- Ice Maker: Manitowoc 55lbs per day
- Freezer: Frigibar chest-type freezer
- Two separate settees with tables allow for dining with 10
- Centerline door with access to the cockpit
- 40" Samsung TV with DirectTV satellite receiver US & Latin America
- RTI entertainment system control

## **Galley**

- Refrigerator: Sub-Zero
- Oven: Thermador induction 4 burner with stovetop
- Dishwasher: stainless Bosh
- Sinks: (2) stainless with insinkerator
- Fresh water filter
- LG Microwave oven
- Hoshizaki stainless icemaker
- Nespresso coffeemaker
- Stainless countertops
- 4 x Round Portlights
- 2 x Large roll down windows with screens
- 1 x Large overhead hatch with screen
- Weems and Plath clock

## **Pilothouse and Electronics**

- Large aft bench seat
- Generous chart areas and chart drawers
- Fully updated electronics suite

- 3 x Large Garmin displays
- Garmin tri-data display
- Garmin VHF
- Simrad AP70 Autopilot
- Simrad 535 Jog control
- Simrad remote VHF
- Simrad RI35 rudder angle indicator
- 3 x Icom handheld VHF's
- Dockmate Yacht Control System (2019)
- Micro-commander electronic throttle controls
- Fusion Stereo (2020)
- Magnetic compass
- HP Office Jet printer
- 3 x Wipers
- KVH Mini 8 Satellite (2021)
- Agean wifi antenna (2023)
- Trac Phone V3 (2021)
- Flir
- Ocean Signal Class II EPIRB

## **Flybridge and Boat Deck**

- 2 x Marquipt 1500lbs davits
- 2 x Safe-Sea 8-person life rafts (Inspected through 12/2023)
- Custom stainless propane grill and wet bar (2021)
- Aft teak deck (2022)
- Custom overhead sun awning / Bimini (2021)
- Sofa and lounge chairs (2018)
- 2 x Soaking tubs (2022)
- Freshwater washdown spigot



- Smokestack with main engine and generator dry stack exhaust
- 2 x Chrome cowl vents
- Lifesling Overboard rescue system

## Hull and Deck Features

SOVEREIGN features full walkaround teak decks that lead to a large foredeck with covered guest seating and ample space to operate her windlass. Her larger than normal aft deck offers lounging and dining space found on much larger yachts, as well as an ultra-light, easy to deploy side boarding platform and ladder customized swim platform with boarding stairs and an additional Passerelle that deploys off the stair above the aft swim platform offering easy access to the water.

- Aluminum hull and superstructure
- Custom aluminum swim platform with teak decking (2022)
- Vinyl coated stainless steel cable lifelines with removable stainless stanchions on platform
- Teak and stainless 5 step transom ladder
- Custom stern stairs to swim platform (2020)
- Custom flybridge stairs (2021)
- Custom table with high low / in out function (2019)
- Aft deck cushions new (2023)
- Aft deck sunshade and side panels 2020)
- 2 x Aft deck wing doors
- Ultra-light custom side boarding passerelle with ladder (2019)
- Ultra-light passerelle off stairs above aft swim platform
- Numerous fire station points
- Pilothouse sunscreen (2023)
- Ideal windlass with capstan, wildcat, and vertical winch
- Custom anchor deployment bow roller system for Plow Anchor(2021)
- Custom bow seat with awning / Bimini (2023)
- Large sun pad on forward coach roof
- Freshwater washdown spigot

- Teak table with chairs
- 8" Ships Bell
- 2 x Fortress FX125 Anchors w/300' Chain rode
- Hatch to chain locker
- Hatch to forward cabin

## **Machinery and Electrical**

- Cummins QSM11-M1 D-Rated 580HP Diesel engines: (Port: 1885hrs and Starboard: 2033hrs 5/2023)
- Twin Disk 3.0:1 reduction Gears
- Centa anti-vibration couplings
- Onan 55KW 1800 RPM 120/240 60 cycle generators: (Port: 3710hrs and Starboard: 2084hrs 5/2023)
- New sound shield for Starboard Generator (2020)
- Dual Racor 1000 Fuel filter systems for all machinery
- Custom designed drystack exhaust system
- SeaRecovery Watermaker
- 2 x Headhunter Mach V domestic fresh water pumps
- Torrid stainless water heater (50gal)
- Torrid stainless water heater (80gal)
- Headhunter Tidal Wave marine sanitation device with associated pumps
- Marine Air Conditioning system with 2 x 72,000 BTU Compressors (replaced 2021 & 2023)
- AC Compressors have variable frequency drives
- Quantum stabilizer actuators port and starboard
- Vetus Electric Bow Thruster
- Bow Thruster batteries (Replaced 2023)
- Starting batteries (Replaced 2022)
- House batteries (Replaced 2022)
- 2 x 100 Amp shore power inlets with transformers
- 3 x Mastervolt Mass 24/50 Battery chargers
- 1 x Professional Mariner Pro 300 battery charger

## Exclusions

Artwork and personal effects that may be seen aboard at time of viewing are not included in the sale.

## Brokers Remarks

SOVEREIGN - Launched as TITAN - was the largest yacht ever built in aluminum at the time. The yacht's designer, Jack Hargrave, was very proud of this fact which made her 30,000 pounds lighter than if she were built out of steel and allowed her a shallower, more Bahamas friendly, draft, and achieved the same performance with about 15 percent less horsepower. Her interior was described as "over the top" for her day, and she originally contained two full beam fore and aft staterooms along with a small "emergency stateroom" or starboard mid-stateroom. Eventually, the full beam aft stateroom was split and another ensuite head was added to make SOVEREIGN the four-stateroom yacht she is today. Her original Carpathian elm burl and Brazilian rosewood is still visible and in beautiful shape in the staterooms and the main deck/salon still features modern and crisp white paneling. Much like her first furnishings, she features sleek contemporary mid-century modern furniture offering bright pops of color throughout. Her aft deck was appointed with unusually deep lounge seating surrounding the table.

It is very rare to come across a yacht that has had such fantastic continuous care and updates throughout all her owners. SOVEREIGN is in beautiful condition and needs to be seen to fully appreciate all that she has to offer. She is highly recommended by her broker.

## Disclaimer

The company offers the details of this vessel in good faith but cannot guarantee or warrant the accuracy of this information nor warrant the condition of the vessel. A buyer should instruct his agents, or his surveyors, to investigate such details as the buyer desires validated. This vessel is offered subject to prior sale, price change or withdrawal without notice.



Profile



Port Profile





Port Quarter



Aft Deck Dining



Aft Deck Dining



Aft Deck Dining





Aft Deck



Salon



Salon



Salon





Salon Facing Forward



Salon Facing Aft



Dining Area



Dining Area





Galley



Galley



Galley



Owner Stateroom





Owner Stateroom



Owner Stateroom



Owner Ensuite Head



Owner Shower





Single Stateroom



Single Stateroom



Single Stateroom



Ensuite Head





Starboard Guest Stateroom



Starboard Guest Stateroommm



Ensuite Head



Port Guest Stateroom





Port Guest Stateroom



Ensuite Head



Pilothouse



Helm Electronics





Aft Sundeck Seating



Foredeck Seating





Engine Room



Engine Room

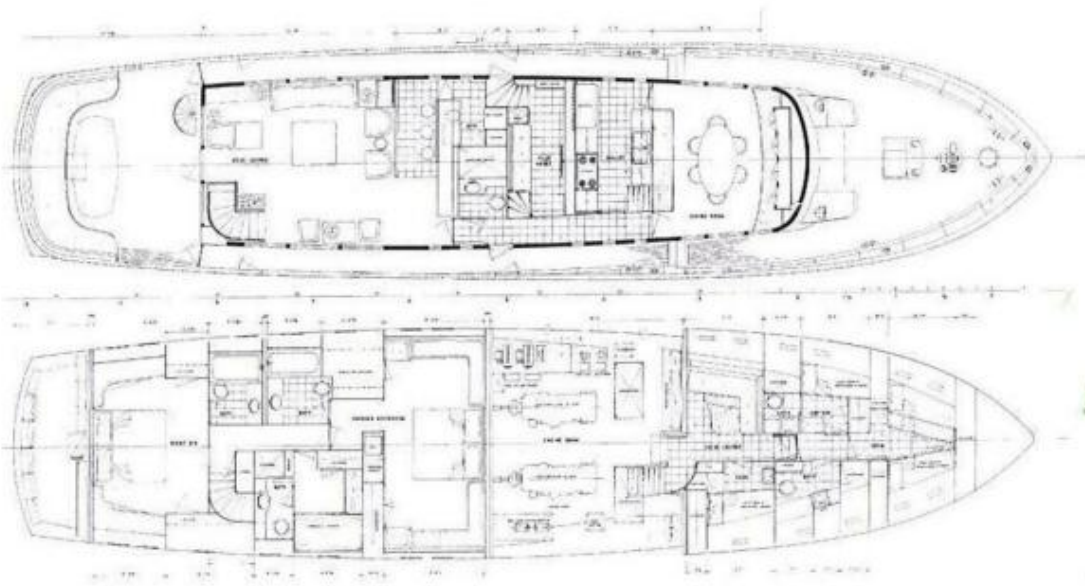
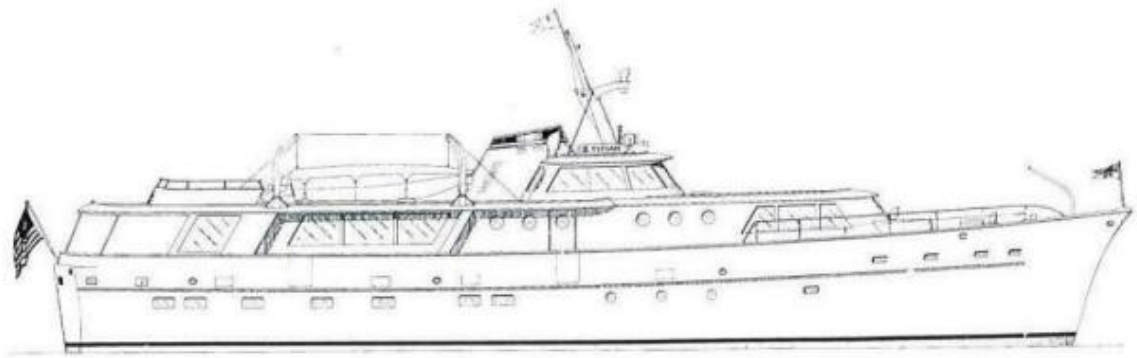

Original Layout (has been slightly changed)