



# FAR NIENTE

131' (40.00m) 2014 Westport  
Fort Lauderdale Florida United States



## OVERVIEW

Manufacturer:	Westport		
Engines:	2 MTU	Hull Material:	Fiberglass
Engine Model:	12V4000	Cruise Speed:	20 Knots
Engine HP:	2895	Max Speed:	24 Knots
Beam:	26' 2"	Cabins/Heads:	5 / 5
Max Draft:	6' 6"	Fuel Type:	Diesel
Water:	1780 G (6738.03 L)	Fuel:	9530 G (36074.96 L)

**\$16,995,000**



## Data Sheet

Category: Motor Yachts  
Condition: Used  
Model Year: 2014  
Refit Year: 2022  
Beam: 26'2" (7.98m)  
Max Draft: 6' 6" (1.98m)  
LOA: 131' 2" (40.00m)  
Cabins: 5  
Sleeps: 10  
On Deck Master: Yes  
Heads: 5

Crew Cabins: 4  
Captain's Quarters: Yes  
Crew Sleeps: 8  
Maximum Speed: 24 Knots  
Cruise Speed: 20 Knots  
Range NM: 1650  
Fuel Type: Diesel  
Hull Material: Fiberglass  
Hull Shape: Semi Displacement  
Air Conditioning: Yes

Gross Tonnage: 333  
Stabilizers: Zero Speed  
Stabilizer Brand: Naiad  
Fuel Tank: 9530 gal (36074.96 liters)  
Fresh Water: 1780 gal (6738.03 liters)  
Holding Tank: 1740 gal (6586.61 liters)  
Classification: ABS  
MCA Certified: Yes  
Builder: Westport  
Interior Designer: Westport Yacht Design  
Exterior Color: Show White  
HIN/IMO: WPS04011C414

## Engines/Generators

### Engine 1

MTU  
12V4000  
Inboard  
2895HP  
2158.80KW  
Fuel: Diesel  
Hours: 6800  
Hours Date: 04-27-2023

### Engine 2

MTU  
12V4000  
Inboard  
2895HP  
2158.80KW  
Fuel: Diesel  
Hours: 6800  
Hours Date: 04-27-2023

## Summary/Description

Delivered in 2014, Far Niente is the newest 40 meter Westport on the market. Westport pedigree and reliability.

## HIGHLIGHTS

1. Newest 40 meter Westport on the market, Hull 4011, a 2014 model. Only 1 owner since new, delivered in 2014.
2. Westport pedigree and reliability
3. 20+ knot cruising speed
4. Accommodations for 10 guests in 5 spacious staterooms, including on-deck master.
5. Mahogany raised-panel wood interior with marble and granite throughout.
6. Spacious sun deck with Jacuzzi, ample sunning space, and dining table for ten
7. Recently received a complete paint job.
8. Naiad Zero-speed stabilizers
9. ABS classification and MCA safety certification
10. Successful charter history

## OVERVIEW

FAR NIENTE is designed to carry an owner's party of up to 10 guests in five luxurious owner and guest staterooms. Her accommodations consist of a full-beam master stateroom on the main deck, including a starboard side study with built-in desk, as well as his and hers walk-in closets and bathroom finished in a gorgeous Marble. Below deck there are four guest staterooms, consisting of two VIP suites with king berths and two additional twin staterooms, all with en-suite baths. The crew accommodations support up to seven or eight crewmembers in four cabins.

Stepping on board FAR NIENTE's main deck aft via the hydraulic passarel, you will find a spacious, covered dining area for up to 10 guests. The main deck aft also has a fully equipped wet bar with guest seating and large flat screen TV. This area is perfect for cocktails and dining, whether at anchor or tied up at the dock. The space can also comfortably accommodate 18 to 20 guests during parties. A few steps down from the aft deck, the swim platform allows easy access to the water and the yacht's tender and toys.

Upon entering the yacht's main deck aft (through automated double glass doors), you will find a large seating area with sophisticated sofas, ottomans, and occasional chairs. Oversized windows flood the area with natural light, enhancing spectacular views. A formal dining area for up to 10 guests is further forward and includes a raised-panel mahogany buffet for easy guest service.

Forward of the main salon and dining area is the starboard side main entrance foyer, with the spacious galley to port and day head just forward.

The professional stainless steel, fully equipped galley features a large walk-around island, with a bar top for guests or crew to relax. State of the art appliances, excellent storage, and plenty of light makes this galley a dream for any professional chef.

The next deck up is home to the beautiful skylounge and massive boat deck, which many guests describe as their favorite space while underway. Large windows, an electric fireplace, and comfortable sofas and chairs make the space an extraordinary spot to take in the surroundings, socialize, or play a board game. A large flat screen TV, small desk, service bar, and dayhead add to the convenience and enjoyment of the space, allowing guests the ultimate in comfort and relaxation.

Just forward of the skylounge is the Pilothouse, with a raised settee, allowing guests to observe the vessel operation and scenery while underway. The space is also a popular place to enjoy fresh coffee in the morning while taking in panoramic views of the surroundings. For the captain and his crew, a modern, state of the art navigation and communication package makes navigating around the world a pleasure.

Forward of the Pilothouse is an outdoor, teak-covered guest terrace with a custom U-shaped seating area with mounted Tucci umbrellas, loose chaise furniture and a spectacular views. There are stairs from here down to the main deck and lower observation settee and table on the bow. These two private outdoor spaces provide an excellent spot to read a book, enjoy cocktails and hors d'oeuvres before dinner, and an wonderful space to watch the sunrise or sunset.

The boat deck aft is accessed through another set of double glass automated doors via the skylounge and is home to the yacht's tender and various water toys. A large, flat screen TV is also concealed in the overhead, and a service bar with BBQ is located on the port side.

The large and open flybridge is one of the main attractions on the yacht. A six to eight person Jacuzzi tub is located furthest forward and provides an excellent spot to soak up the view, sun, and enjoy a cold beverage. A spacious sunpad surrounds the Jacuzzi providing even more space to sunbath or curl up for a nap. At the center of the flybridge you will find a spacious, covered, dining area for up to ten guests, and includes a pop-up TV from the side storage cabinets. A custom wind screen has been added to allow enjoying this area in all weather conditions. A wet bar add to the versatility of the space, providing all the amenities a guest could ask for. The dining table and chairs can be moved around the deck, providing space to dance under the stars in a completely open space. Aft of the dining area is an uncovered area that includes loose furniture for a great conversation area and three comfortable chaise loungers.

FAR NIENTE is ABS classed and MCA certified, establishing high levels of safety and construction. With zero-speed stabilizers to ensure a comfortable time for everyone on board at anchor and underway, and with a top cruising speed of 24 knots, she will easily get you where you want to go.

She is a beautiful 2014 model, meticulously maintained by a superb crew, offering a proven platform to explore the world.

## MAIN AFT DECK

Comfortable and well-appointed exterior area for outdoor entertaining with a full-service bar with high bar stools, generously sized cushioned aft settee with teak cocktail table, full sized teak dining table with dining chairs, and full A/V installation including a fold down TV. Each side is protected from the wind with glass windows to port and starboard as well as wing doors to the walk around decks.

Teak decks and LED lighting are installed throughout the entire exterior of the vessel.

### Furniture:

- Gloss finish teak dining table (fixed pedestal with leaf insert)
- (10) Dining chairs
- varnished teak cocktail tables (fixed pedestal)
- Forward facing settee
- Bar stools

### Bar Area:

- Full service bar with high gloss teak bar top
- Refrigerator
- Sink
- Bottle storage
- Barware storage
- TV (fold down)

## MAIN SALON

Aft entry door is stainless steel framed, glass, counter-pull, open/close sliding mechanism with pneumatic seal.

This is an elegantly comfortable area to enjoy the 55" TV that pops up out of the corner.

TV: 55"

Sofa

Cocktail table

Free standing chair

(2) Occasional chairs

(2) End tables

Game table and four (4) chairs

\*Dayhead in passageway just forward of the salon.

## DINING

Forward from the main salon is the formal dining area. Servers have easy access from the galley via a dual hinged access door.

- Formal dining table: Pommele Sapele table with Mahogany and glass accents accommodates ten guests
- (8) Formal dining chairs to match nearby card table chair
- Buffet/storage: Buffets to port, starboard, and aft provide storage for sixteen (16) 5-piece place settings of china, formal flatware, and stemware.

## AFT BOAT DECK

Open seating area with loose furniture including love seat, two club chairs, and cocktail table.

Large service bar to the port side:

- Sink
- BBQ
- Refrigerator

Tender: AB Inflatable

Jet Skis: Seadoo Sparks

Chocks with universal mounting system

Davit: 3000 lb., full hydraulic proportional control, reserve back up power pack

## SKYLOUNGE

Aft entry door is stainless steel framed, glass, counter-pull, open/close sliding mechanism with pneumatic seal.

TV: 55" LED

L shaped sectional sofa

Large ottoman / cocktail table

(2) Lounge chairs

(2) Ottomans

Electric fireplace

Working desk with two (2) chairs next to bookshelves

Service bar

\*Day head at forward end of skylounge by the desk

## **SUN DECK**

Large Jacuzzi forward in the center with custom seating, surrounded by sun pads

Hardtop integrated with electronics mast for shade in the center of the deck

Large high gloss dining table in the center (fixed pedestal)

10 teak chairs for dining

Service bar to port side

Popup TV built in on starboard side

Three (3) chaise lounges with two (2) side tables

Sofa and (2) lounge chairs with (1) coffee table

Custom wind screen to enclose dining area

Teak decking throughout

(4) 10-person lift rafts with embarkation lights and hydrostatic releases, built in cradles outboard of the deck rails.

## **GALLEY**

Galley is provided with stone (owner selected) counter space with ample room for food preparation, pantry with dry storage shelves for extended cruising, and various appliances. Integrated into the counterspace is a high-top bar for preparation or casual dining.

#### Appliances:

- Induction range: CookTek, 36" 5 burner
- Wall oven: Miele, double
- Microwave/convection oven: Wolf
- Refrigerator/freezer: Sub-Zero
- Freezer, undercounter: Sub-Zero
- Wine coolers: Sub-Zero
- Sink: Stainless steel double basin with pull out faucet
- Instahot water dispenser: Insinkerator
- Heat lamp

Large pantry forward of galley

Storage cabinets with shelving (full length of port forward bulkhead)

## CREW QUARTERS

There are 4 crew cabins in total, 3 forward and below and 1 aft of the engine room. Each stateroom has independent TV/AV as well as ensuite bathroom facilities.

Also forward is crew galley and crew mess.

- TV/AV
- Sink
- Microwave
- Refrigerator
- Washer/Dryer - 2 sets
- Dining settee with table
- Security monitors
- VHF & Depth sounder

## TENDERS AND TOYS

1. New RIB tender - 2022
2. (2) Seadoo Sparks jet skis - 2021
3. (2) Seabobs with hidden chargers and aluminum mounting racks.



4. (2) Kayaks
5. (2) Paddle boards
6. Swim platform 19" bits provide reinforcement to town a 42' tender.
7. E-Foil board
8. Custom Slide
9. Maui mat
10. Floating inflatable cabana

## AUDIO AND VISUAL EQUIPMENT

Each accommodation space is equipped with audio/video entertainment equipment which provides for a variety of entertainment choices, satellite-based radio and television, dockside cable service as well as on board sources including DVD, and central movie server. The dedicated, air-conditioned AV locker is located in the guest foyer on the lower level. Sonos player and Apple TV's added to the network in 2020. Upgraded to all new IPADS installed in 2020.

### Central Equipment

Kaleidescape System:

(1) Movie server and (10) movie/music players includes the Movie and Music License and a Lifetime Music Guide and Software Update Service. There are (5) dedicated players (Master Stateroom, Both VIP cabins, Skylounge & Salon), and the remaining (5) are shared to all other locations. The entire AV system is supported by a power conditioner and UPS backup power supply. New Kaleidescape system was installed in 2020.

- Kaleidescape Movie/Music Server
- Kaleidescape Four-zone Music Player
- Direct TV HD Satellite Receivers
- Crestron iPod docking station
- Crestron FM tuner
- iPad Controls with Airplay on Apple TV
- Video access to CCTV cameras & chart plotter

### AV Package (per location)

Galley/Dinette: TV 40" LCD

- Access to DVD, IPOD, Apple TV, Kaleidescape, Sat TV, TV Tuner, CCTV Cameras, Navigation, FM Radio
- Controlled with an Ipad Mini
- 2 Overhead speakers

Master Stateroom: TV 55" LED

- Access to DVD, IPOD, Apple TV, Kaleidescape, Sat TV, TV Tuner, Navigation, FM Radio
- Controlled with an Ipad Mini
- 5 Overhead speakers + subwoofer

Salon: TV 55" LED

- Access to DVD, IPOD, Apple TV, Kaleidescape, Sat TV, TV Tuner, Navigation, FM Radio
- Controlled with an Ipad Mini
- 5 Overhead speakers + subwoofer

Aft Deck: TV 42" Flip-down LED exterior, daylight viewable

- Access to DVD, IPOD, Apple TV, Kaleidescape, Sat TV, TV Tuner, Navigation, FM Radio
- Controlled with an Ipad Mini & Handheld remote
- 4 Overhead speakers

Sundeck: TV 42" Popup LED exterior, daylight viewable

- Access to DVD, IPOD, Apple TV, Kaleidescape, Sat TV, TV Tuner, Navigation, FM Radio
- Controlled with an Ipad Mini & Handheld remote
- 4 Overhead speakers

Fore Deck:

- Access to IPOD, Apple TV, FM Radio
- Controlled with an Ipad Mini
- 4 Bulwark speakers

Aft Guest Stateroom: TV 32" LED

- Access to DVD, IPOD, Apple TV, Kaleidescape, Sat TV, TV Tuner, Navigation, FM Radio
- Controlled with an Ipad Mini & Handheld remote
- 2 Overhead speakers

Forward Guest Stateroom: TV 28" LED

- Access to DVD, IPOD, Apple TV, Kaleidescape, Sat TV, TV Tuner, Navigation, FM Radio
- Controlled with an Ipad Mini & Handheld remote
- 2 Overhead speakers

Skylounge: TV 55" LED

- Access to DVD, IPOD, Apple TV, Kaleidescape, Sat TV, TV Tuner, Navigation, FM Radio
- Controlled with an Ipad Mini
- 5 Overhead speakers and subwoofer

Boat Deck: TV 42" Flip-down LED exterior, daylight viewable

- Access to DVD, IPOD, Apple TV, Kaleidescape, Sat TV, TV Tuner, Navigation, FM Radio
- Controlled with an Ipad Mini & Handheld remote
- 4 Overhead speakers

Pilothouse:

- Access to IPOD, Apple TV, FM Radio
- Controlled with an Ipad Mini & In Wall Touchpanel
- 2 overhead speakers

Captain Stateroom: TV 28" LED

- Access to DVD, IPOD, Apple TV, Kaleidescape, Sat TV, TV Tuner, Cameras, Navigation, FM Radio
- Access to Radars. Control of chart plotter plus custom Radar alarm and custom anchor drag alarm
- Controlled with an Ipad Mini & Handheld remote
- TV Speakers

Crew Lounge & Crew Quarters: TV 24" LED

- Access to DVD, IPOD, Apple TV, Kaleidescape, Sat TV, TV Tuner, Cameras, Navigation, FM Radio
- Controlled with an Ipad Mini & Handheld remote

- TV Speakers

Satellite Television: KVH HD 11 tracking antenna with world LNB

## NAVIGATION AND COMMUNICATION

The vessel is equipped with modern navigation and communications equipment suitable for worldwide voyages. This equipment includes satellite-based position and speed information, gyroscopic and magnetic heading data, radar, electronic charting and depth finding. Communications equipment spans numerous transmission technologies in compliance with safety regulations and to maximize contact with shore side and marine stations, enhancing one's ability to communicate from any location.

### **Pilothouse Navigational Aids**

- All new bridge electronics installed in 2020
- Bridge Switching Systems (BSS): Five (5) 26" widescreen Nauticomp displays
- Chart plotters:
  - o Nav 1: Transas Navi-Sailor 4000, ECDIS MFD software with connection to BSS and includes wireless keyboard/mouse. System includes interfaces from : ARPA GPS, AIS, Depth, Speed, Wind, GYRO, and second DGPS. Output to Autopilot is provided. Transas Hub allows online update of charts.
  - o Nav 2: Nobeltec Time Zero with connection to BSS includes wireless keyboard/mouse. Output to Autopilot is provided (new in 2020)
- GPS: Two Furuno DGPS receivers with WAAS
- AIS: Furuno FA-170 interfaced to Radar and Electronic Chart with Pilot Plug (new 2020).
- Radar: Two Furuno FAR-2117 X-Band Radars. One with 8.0 ft. Open Array and one with 6.5 ft. Open Array; 96 N.M. range (new 2020). Radars are heading stabilized with speed input for ARPA input to both radars.
- Wing Stations: Outside pilothouse (port and starboard) with molded composite covers, engine controls, engine start and stop, jog steering, rudder angle indicator, bow thruster/stern thruster, and horn controls.
- Gyrocompass: Simrad GC-85 Compact System interfaced for display on Autopilot, Radars and Electronic Chart & AIS (new 2020)
- Magnetic Compass: Ritchie F600 G-5 mounted centerline at pilothouse helm station. Compass is compensated during normal sea-trials. Vessel is delivered with Deviation Card from that date. Fluxgate compass interfaced with NMEA weather instruments
- Autopilot: Simrad AP70 with Gyro input and back-up Simrad RC-42 backup fluxgate rate compass. A dedicated RFU to the steering shelf is added for direct feed to the autopilot.
- Depth - Speed - Wind: NMEA 2000 backbone and sensors with B&G displays (new 2020), includes air temp, barometric

pressure. Full function displays in Pilothouse and Crew Lounge.

- Color Sounder: Furuno FCV-1200 BB color video sounder with display on BSS.
- Doppler Log: Furuno DS80 Doppler Speed Log
- APC 1000VA 670W Smart UPS, full load runtime 6 minutes
- Upgraded new navigational alarms to Captains Cabin in 2020.

### **Vessel Alarms and Monitoring**

System is 24-volt and installed as a single-point alarm management screen in the Pilothouse and 6 remote touch screens around the vessel. The system monitors:

- Tank levels
- AC power and electrical system
- Tank monitoring
- CO alarms
- Bilge alarms
- Security
- Navigation lights
- Fire Detection and Alarms

### **Cameras**

- Seven I.P. High Def night vision cameras: (2) in the Engine Room, (1) exterior aft deck port side, (1) exterior aft deck starboard side; (1) starboard side deck, (1) port side deck and (1) on mast are displayed on the CCTV system.
- Monitoring Station (With display on BSS)
- Closed Circuit Television
- Night Vision Camera: FLIR (upgraded in 2020)
- Quad split screen color display: System controlled by Crestron Controller

### **Communications: Ship to Ship/Shore**

- VHF:
  - o (2) DSC Furuno FM-8800 in Pilothouse with Emergency battery back-up.
  - o Furuno FM-3000 in the Crew Lounge
  - o Handheld GMDSS VHF radios w/desktop chargers supplied
  - o VHF in galley
- SSB: Furuno FS1575 with DSC capability
- GPIRB – Smartfind Plus
- McMurdo SAT Find 406 MHz GPIRB
- S.A.R.T. – 9GHz Portable
- Navtex: Furuno NX700 Paperless Navtex Receiver

### **Satellite Communications (Satcom) Components**

Fleet Broadband FB150 for Voice, and Internet Access. Voice connected through Phone System. KVH V11 HTS Vsat provides internet access. (New unit installed in 2020) Internet/Data connectivity service and (2) VOIP lines.

- Satcom “C”: Furuno Felcom18 Inmarsat C
- Furuno PP520 Printer
- Furuno Felcom 18 SSAS Upgrade kit
- Furuno GPS Module kit
- Sat Phone: Iridium 9555 with charging cradle
- Upgraded with Starlink Maritime and Starlink RV installed
- External antenna for portable Sat phone added.

### **Telephone System**

Panasonic Digital telephone system with 20 extensions of which 6 are cordless. Telephone system is connected to Satcom, Cell Phone, two VOIP and Shore Phone voice line. Includes a single 100’ Telephone/Cable TV combination shore cord.

Telephone System Components:

- (14) Panasonic PBX TDA 50G 24 button LCD Display
- Cordless system phone (6)
- Gangway intercom with sockets at side deck.
- APC 1000VA 670W Smart UPS
- Shore Phone: Weatherproof phone connection at starboard bustle locker.
- Cellular Telephone: Upgraded with newest Again wifi receiver and Pepwave MBX 8 sim plus 8 sim injector, plus hi-gain cell antennas (Axxis Marine) to allow cell data up to 40 nm offshore.
- WIFI: All new Wifi 6 network system installed along with new Keri's network management system.

### **Signals and Lights**

- Ship's bell
- Ship's Whistle: Air powered horn (with automated signal timer): Kahlenberg, F-2 five trumpet, Kahlenberg, M512 signal timer
- Search Light: One (1) Carlisle & Finch, 200 watt xenon, 15 million candlepower; remote controlled
- Search Light: Carlisle & Finch, 200 watt xenon, 15 million candlepower, remote controlled.
- Running Lights: full array

## **SAFETY EQUIPMENT**

The vessel is to be equipped with all safety equipment required for charter service (with USCG or Cayman Islands Shipping Registry of up to 12 passengers.)

- Life Raft: Four (4) 10-man A-pack flat life rafts mounted on flybridge rails.
- Life Preservers: Twenty-three (23) Coast Guard-approved adult life preservers with water lights, and six (6) Coast Guard-approved child life preservers with water lights.
- Immersion suits: (17)
- Ring Buoys: Four 30" diameter buoys secured on exterior of vessel.
- Flares: Flare kit included.
- Bell: Perko
- Fire Extinguishers: Dry chemical: ten-10lb, nine-5lb, and one-2.5lb. Carbon Dioxide ten-10lb.
- Medical Kit: MCA compliant coastwise and offshore medical kit and supplies

## MACHINERY

Two (2) MTU/DDC 12V4000 engines; 2895 HP each. They are connected to propellers via 5" Aquamet 22 HS Stainless shafts and close coupled down angle gearbox. Primary exhaust is underwater at chine while a silenced bypass exits at transom corners. Seawater cooling water is supplied via dual 5" lugged type butterfly valves, bronze Y-strainers and molded FRP scoops with Stainless steel grates.

- Controls: Electronic with throttle synchronizing and LCD data display. EDM for each engine.
- Fuel Filters: Racor
- Marine Gear: ZF, Mod 5050A, Close coupled, 8° down angle, ratio 2.97:1 with trailing pump.
- Main Exhaust: Stainless steel collector with hard thermal insulation, integral spray ring for 18" main underwater FRP exhaust piping and flanged connections
- Underwater Exhaust outlet: Molded FRP design with chine exit. Westport Shipyard fabrication
- By-pass exhaust: 10" FRP piping
- Silencer: Soundown
- Propellers: Custom 5 Blade Nibral cast - CNC machined - S Class

Engine Hours as of April 2023:

Port Main Engines: 6,800 hours

Starboard Main Engines: 6,800 hours

Estimated range with 10% reserve and no significant wind/current:

- 3000 n.m. at 12 knots
- 2000 n.m. at 15 knots
- 1300 n.m. at 18 knots

## ELECTRICAL EQUIPMENT

### Generator

There are two, Northern Lights 92KW electrical generators rated at 1800 rpm, providing AC power at 120-208volt/3phase/60 cycle Hz. The generators are located port/starboard in the engine room. Water temperature, oil pressure and hour meters are installed in the distribution panel. Both generators have remote start/stop in pilothouse. Power Take Off (PTO) and hydraulic pump are installed on both generators for full redundancy. Seamless Power Transfer is standard when switching to/from Generators to Shore power and when switching loads from one generator to the



other generator.

## **Shore Power**

Shore power is provided through electrical conditioners that allow a large variety of power forms; single phase, three phase, combination, high voltage, or low frequency to be converted to ship power.

Shore Power Converters: Two (2) A/SEA 37 KVA, 40-70 cycle. 170 to 520 VAC input.

Shore Power Cords: (2) 100 amp cords on Glendinning Cablemaster reels

Adapters: (4) two for 240V to 480V and two for 208V to 480V).

TV and phone connections: located at starboard bustle

## **DC Power**

Main Engine Batteries: (4) 8D, 225-amp hour

Generator Batteries: (2) Group 31, 105 am/hour

Ship's 24V system: (4) 8D, 225-amp hour

Emergency 24V power: (2) 8D, 225-amp hour

Reserve 24V power: (2) Group31, 105-amp hour

## **GENERAL CONSTRUCTION**

### **Construction and Exterior Finish**

The hull is fiberglass mat and roving with vinylester resin and PVC linear cores. Structural framing is laid up using a combination of fiberglass and carbon fiber reinforcement. House and deck structures are cored composite construction. Core material and density varies throughout to optimize engineered structures.

Main Bridge, and Sun Deck: Sprayed exterior gelcoat is followed by fiberglass mat and roving with vinylester resin for the outer skins, vacuum bagged foam core, and fiberglass mat and roving with vinylester resin for the inner skins. The keel pad, strut palms and stabilizer pads are reinforced with additional plies of fiberglass.

Hull stringers, webs, and stiffeners: Fiberglass mat and roving and/or carbon fiber with vinylester resin over foam

forms. All soles and structural bulkheads are of fiberglass and foam composite construction infused with vinylester resin.

## **Paint**

Topsides: Awlcraft 2000 high gloss polyurethane. Hull and house color is Snow white. Boot stripe is acrylic high gloss black.

Bottom Paint: Sea Hawk black antifouling paint over an epoxy barrier coat.

## **SYSTEMS**

### **Fuel System**

Total capacity (diesel): Approx. 9,530 gal (US) in five (5) tanks. Fueling process is via either of two deck fill locations amidships, port and starboard side. All tanks are vented to atmosphere on the starboard side. Fill/transfer system includes a centrifuge, pumps, meter and distribution manifold. All diesel engines draw from the day tank. Engines and Generators are supplied via priming pumps and filters. Fuel is transferred to and from the day tank via fuel transfer pumps. Fuel is also transferred by virtue of the work of the centrifuge. Tank levels are monitored by electronics sensor, with high/low level alarms, and displayed on a vessel monitoring system display. Fuel tanks ventilate thru a "vent tank", which is monitored for overflow. Tanks are welded aluminum.

### **Tanks**

Fuel Tanks (Diesel):

#1 Mid Bilge Tank: approx. 740 gallons

#2 Mid Bilge Tank: approx. 790 gallons,

#3 Center (Day Tank): approx. 2134 gallons,

#4 Port Tank: approx. 2934 gallons,

#5 SB Tank: approx. 2934 gallons

### **Fill/Transfer/Use**

Centrifuge: Alpha Laval, 198 GPH (Gallons/Hour); diesel/oil separator

- Primary Pump: AC, 50 GPM
- Secondary Pump: DC positive displacement back-up/priming pump
- Meter: Electronic turbine with numerical display and automatic pump shut off

## **Fresh Water System**

- Fresh Water Tank (Divided): Stainless steel, approx. 1780 total gallons
- Purification: 220 VAC Silver ion electrolytic water sterilization system
- UV filters: Two for disinfection of potable water, 29 GPM each.
- Water Softener: Yacht Mate DM1000 system, with Swim Platform water connection, plumbed directly to the fresh water tanks.
- Deck fills: Two stainless steel, 1 ½" round with threaded caps. One quick connect fitting, located on the swim step bustle is plumbed to supply the water softener.
- Water makers: (2) Blue Water Desalination (reverse osmosis) for a total capacity of 3700 gallons per day
- Water Heater: Dual element (for fast recovery) water heater, 132 gallon capacity.
- Dual particle filters: For removal of sediment, dissolved solids and contaminants to 5 microns plumbed in parallel. Stainless steel canister with replaceable filter cartridges
- Pressure tank: FRP construction located at remote ends of piping system
- Pumps: (2) centrifugal pressure pumps, 30 gpm each, plumbed in parallel for high flow capability
- Potable fresh water drinking system with triple remineralization filters capable of delivering cold, room temp, and carbonated water.

## **Lube Oil System**

Spare oil for the Main and generator engines can be carried onboard. Tanks for fresh and spent oil are mounted in the Engine Room. The new oil tank is replenished through an oil fill on top of the tank. The refuse oil is offloaded with quick-connect hose at the stern. Two air-powered diaphragm pumps are used to transfer to/from locations via hose reels.

- Lube Oil - New: 192 gallons
- Lube Oil - Used: 278 gallons
- Pump: Two (2) air diaphragm pumps.

## **Waste Water System**

Black and gray water is routed to an FRP tank prior to emptying via shore side pump out. When permitted, black water can be treated by the onboard MSD for overboard evacuation or the contents can be delivered directly overboard. The

dockside pump out connection is located on the swim platform. Gray Water is sent directly overboard or when required, routed to the black water tank. Tanks are vented at the boot stripe, carry level alarms and are monitored on the Vessel Monitoring System.

- Pumps: High capacity solids handling AC diaphragm pump.
- MSD: Certified to meet MARPOL regulations as well as USCG Type II MSD. (Includes chlorine generator)
- Black Water Tank: FRP construction with internal baffles, approx. 1,740 gal.
- Gray water collection/movement: Three Headhunter sumps (crew, guest and engineers) for transfer to black water tank or directly overboard via Y-valve. Westport construction includes primary AC pump and DC back-up pump with strainer, inspection port and alarm on DC pump.
- Black water lift station: A Headhunter sump for the galley and crew galley for transfer to the black water tank.

### **Compressed Air System**

The vessel will have a compressed air system for powering the ship's whistle, gasoline dispensing pump and oil dispensing pump, the fuel valves, as well as for use in the machinery spaces for air powered tools. The system consists of compressor, piping system, quick connect fittings, and (3) accumulator tanks.

- Quick Connect Fittings: Located; FWD escape hatch, Port Swim Step, Exterior Bar (port side) on Pilothouse deck and Flybridge Mast Leg (stbd) in storage locker.
- Accumulator tanks: 3 - 10-gallon units, 2 in the Engine Room and 1 in the stbd. Flybridge mast leg storage locker.
- Hose/Reel: Reel Craft - Hose ½" x 35'
- Compressor: Kaeser 5hp SX-6

### **Bilge System**

The bilge system consists of five watertight bilge compartments which carry alarms for the presence of water and are monitored electronically. In the Engine Room and Utility Room are 66 gpm AC bilge pumps. The water pumping Diesel engine, mounted in the Utility Room bilge (part of the firefighting system) can also be engaged for extreme bilge pumping capability.

### **Deck Drain System**

All exterior decks are fitted with freeing ports and/or drains with a plumbed piping system. Deck drains are molded portions of the deck and fitted with polished stainless steel grates. All drain piping is of ABS approved materials, PVC – DWV and are led to laminated thru hulls located at the boot stripe with check valves and ball valves.

### **Fire Hydrant System**

The fire main system consists of four fire stations and two pumps. Each station contains a hose, angle valve, and high/low volume nozzle. The primary electric fire pump can be started from any fire station or locally.

The interior of the ship is protected by sprinklers which draw from the ship's fresh water supply. In the event the water supply is depleted, then without interruption, the system would revert to seawater use.

The Engine Room is protected by a gas smothering FM200 system.

### **Galley Hood Fire System**

Independent, fixed system is located in the main Galley in the hood above the stove.

### **Stabilizer System**

Stabilization while underway is provided by a pair of fins located approximately amidships and powered hydraulically by a main engine driven hydraulic pump. Control is by modern digital 'fly-by-wire' system located in the pilothouse.

At rest stabilization: Zero speed stabilization is accomplished by two 22 sq foot stabilizer fins using a Model Naiad 525 Stabilizer system which is powered by the central hydraulic system via a generator.

Stabilizers were dropped in November 2021 for service. Hydraulics were serviced in Jan 2023.

### **HVAC System**

The interior temperature of the vessel is maintained by a 30 ton capacity seawater cooled HVAC system from Marine Air. Air handlers of various BTU ratings are mounted behind cabinets and bulkheads throughout the vessel and are fitted

with electric heating elements for autonomous heating for all accommodation, crew, and guest spaces. The HVAC system also provides fresh air make up to create a ventilated atmosphere.

- 2x brand new AC compressors installed in Dec 2022
- 1x refurbished AC compressor in April 2023
- 1x new compressor scheduled for installation in June 2023

### **Central Hydraulic System**

The system is powered by pumps on port and SB generators (either or both at the same time). The central hydraulic system operates the thrusters, capstans, anchor winches, stabilizers, and crane/davit. New PTO installed in 2022.

- Bow thruster: 16" dual prop, 65HP motor
- Stern thruster: 16" dual prop, 55HP motor
- Davit: Nautical Structures telescoping 3,000 lb capacity with DC backup power for MCA compliance.
- Passarelle: Extends from under the aft deck behind the stairs on the port side. Passarelle will accommodate a wheelchair and has removable railings. It extends 6'7.5" past the transom.
- Stabilizers – see description above.

### **Mooring System**

- (2) Davis Anchor Talon HHP-500 stainless steel anchors – 530 lbs each
- 5/8" stud link galvanized steel chain (ABS certified) – 400' starboard, 400' port
- o Anchor chains replaced in November 2021
- Maxwell Windlass/winch combination on the foredeck are hydraulically driven.
- (2) Maxwell VC3500 Capstans are located on the swim step bustles to port and starboard.

## **NOTES**

1. Varnished tables all refurbished and PPF filmed in Nov 2022
2. Refurbished name boards with super bright white LED's (2022)
3. Replaced all thru-hulls in 2019 as part of 5 year special survey

4. Removed gasoline tank and added storage instead.
5. Galley overheads replaced in Nov 2022
6. Added an additional bunk to Captain's Cabin to accommodate charter crew.
7. ISM compliant: Yes, mini ISM

## **EXCLUSIONS**

The name "FAR NIENTE" is reserved. A complete and detailed list of items to be removed from "FAR NIENTE" will be provided at time of sale upon written request.





























































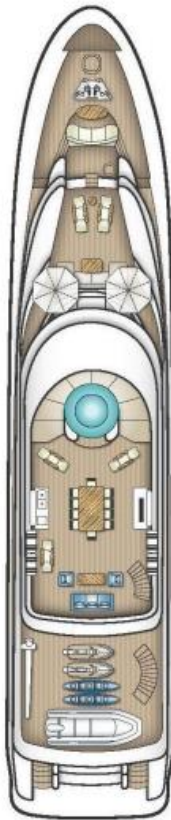

Sun Deck



Bridge Deck



Main Deck

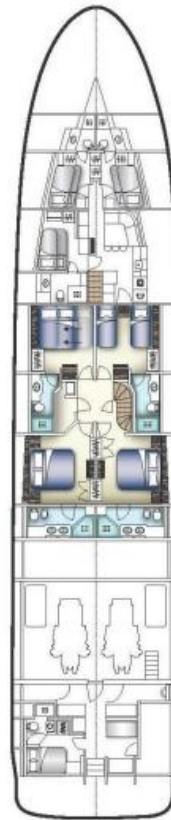

Lower Deck