



# Hallelujah

57' (17.37m) 2017 Beneteau Sense 57  
Fort Lauderdale Florida United States



## OVERVIEW

**\$549,000**

Manufacturer:	Beneteau		
Engines:	1 Yanmar	Hull Material:	Fiberglass
Engine Model:	4JH1	Cruise Speed:	
Engine HP:	110	Max Speed:	
Beam:	16' 4"	Cabins/Heads:	3 / 3
Max Draft:	"	Fuel Type:	Diesel
Water:		Fuel:	



## Data Sheet

Category: Cruisers

Condition: Used

Model Year: 2017

Beam: 16'4" (4.98m)

Min Draft: 7' 10" (2.39m)

LOA: 57' (17.37m)

LWL: 52' 3" (15.93m)

Cabins: 3

Single Berths: 2

Double Berths: 3

Heads: 3

Fuel Type: Diesel

Hull Material: Fiberglass

HIN/IMO: SPBDL074H617

Stock #: B90797

## Engines/Generators

### Engine 1

Yanmar

4JH1

110HP

Fuel: Diesel

### Generator 1

Onan

7.50KW

Hours: 680

## Summary/Description

Exceptional vessel for extended cruising in comfort, live aboard, or short excursions Fully Air Conditioned - Washing Machine - Optional long range fuel and water tanks - Solar Electric Panels - Water Maker - Carbon Down/wind Sail Rig w/Assymetrical Spinaker.

Exceptional vessel for extended cruising in comfort, live aboard, or short excursions. Fully Air Conditioned and equipped with a washing machine. Optional long range fuel and water tanks, solar electric panels, water maker, carbon down/wind sail rig w/asymmetrical spinaker. "Hallelujah" has a Huge cockpit with hydraulic fold down swim platform, Large comfortable Settees Port and Starbd, Hi/Lo dining table to Starbd, and fixed overhead hard top Bimini with opening sunroof in the center.

- Unique design with bright, airy Salon, only 3 steps down from the cockpit.
- Salon has wide windows on all sides with opening ports and opening overhead hatches.
- Full Galley in the Salon with numerous storage cabinets and lockers.
- (3) private guest cabins forward of salon - each with en-suite head and shower.
- Additional crew cabin under cockpit seat to Port - with easy access from cockpit.

This vessel can be purchased with crypto currency if desired

Please contact listing broker for FULL details or to set up appointment to see this vessel -

Boat has been imported, US Duty Paid, and is available to all US residents

## Dimensions

LOA: 58 ft 4 in, 17.78 Meters

Hull Length: 55 ft, 1 in 16.80 m

Waterline: 52 ft 3 in, 15.93 m

Beam: 16 ft 4 in, 5.40 m

Asir draft: 78 ft 5 in, 23.91 m

Draft: 7 ft 10 in, 2.4 m

Displacement: 41,390 lbs., 23,550 kg

Ballast: 10,803 lbs., 4900 kg

### Tankage:

- Fresh water: 256 gal 969 ltr
- Fuel: 220 gal 830 ltr

Engine: Yanmar 4JH1 110 hp (1675 hours)

Generator: Onan 7.5 kw (680 hours)

Rating – “A” Ocean 10 persons

## Accommodations

3 Private double cabins -with en-suite heads

Plus, crew cabin

(3) electric heads

- Woodwork: Alpi walnut (option)
- White ceruse oak laminate flooring
- Bulkheads upholstered in vinyl fabric
- Fabric upholstery in the saloon
- Marine mattresses in the cabins

### **MASTER FORWARD CABIN**

Master cabin forward for privacy

Centerline queen berth

Separate shower and toilet compartments

Bright and airy with large overhead opening hatch, 4 smaller hatches

Individual air conditioning controls

Headroom: 1,94 m / 6'4"

- Central double bed (2,03 m x 1,21 m - 1,70 m / 6'8" x 4' - 5'7") - Slatted bed base
- Wardrobe, Cupboard, Shoe cabinet
- Dressing table with grey top and removable seat
- Mirrors
- 2 Hull portholes with curtain
- 2 Opening deck hatches with mosquito blinds

### **FORE HEAD**

Separate shower, to port - Headroom: 1,93 m / 6'4"

- Private access via glazed door
- Mirror - Cupboard • Shower - Hot/cold water mixer tap
- 1 Flush deck hatch with mosquito blind

'Separate WC, To starboard Headroom: 1,94 m / 6'4"

Holding tank (80 L / 21 US Gal)

- Washbasin - Synthetic resin worktop - Hot/cold water mixer tap
- Mirror
- Toilet accessories • Cupboard - Cubby hole locker
- 1 Flush deck hatch with mosquito blind

### **GUEST CABINS - PORT AND STARBOARD**

Two identical guest cabins – one to Port, one to Starboard

Each with private head and shower

Overhead opening hatch on each cabin

Individual air conditioning controls

Headroom: 1,97 m / 6'6" 2 Cabins each with:

- Sliding entrance door
- Double bed (2,00 m x 1,00 m - 1,56 m / 6'7" x 3'3" - 5'1") - Slatted bed base
- Hanging locker - Shelving - Drawers • Mirror
- 1 Hull porthole with curtain
- 1 Opening deck hatch with mosquito blind

### **HEADS - PORT AND STARBOARD**

Headroom: 1,94 m / 6'4" 2

Each head containing:

- Private entrance through cabin
- Separate moulded shower, Hot/cold water mixer tap

Holding tank (80 L / 21 US Gal)

- Washbasin - Synthetic resin worktop - Hot/cold water mixer tap • Mirror
- Toilet accessories
- Cupboard and cubby hole

- 1 Opening deck hatch with mosquito blind

#### **OCCASIONAL CABIN ( - In place of the sail locker (Port side)**

Separate crew/guest cabin with access from cockpit

- Headroom: 1,18 m / 3'10" Access through the cockpit locker
- Solid wood sliding ladder
- Marine mattress
- 1 Opening porthole
- 1 Opening hatch

## **Vessel WalkThrough**

When you board "Hallelujah" you enter the Large cockpit aft with twin steering wheels. A Crew/Guest cabin is located under the Port cockpit settee and accessed from the cockpit. As you leave the cockpit you will take 3 steps down where you will enter in to the bright and airy main salon with large side windows (with opening ports) and overhead opening hatches. The salon is easy to walk around with full Galley along Starbd side, dinette to Port and centerline storage cabinet with seat facing dinette. The nav station is located at the aft section of the Salon to the Port of the companionway

(3) guest cabins are located forward of the Salon on either side of the center hallway one guest cabin located to Port, and one to Starbd, with Master at forward end of hallway(2 sets of bedding for each bed). Air conditioning with seawater compressor in stern, chilled water circulation, 4 x low noise condensers

#### **Sense 57 exclusive trim level 2017**

- Bowsprit with integral anchor stowage and bobstay,
- Cockpit galley
- Releasable inner forestay chainplate
- 4 Opening ports in galley & saloon windows
- 4 x Service Batteries (4 x 120 amp x 12V)
- Additional 40a battery charger
- LED interior lighting
- LED Navigation lights
- Electric coach roof winch to port H50.2 STECH
- Fusion + Interior and exterior waterproof speakers
- Storage under floor
- Stainless steel beading for fenders in cockpit locker
- 2000w 12v/220v Inverter
- 4 USB sockets to charge mobile devices
- 12v refrigeration unit in galley ice box
- Indirect LED lighting inside cupboards
- Deck wash pump
- Storage bags at both helm stations
- 3-burner stainless cooker with oven and grill
- Saloon speakers upgraded to Bose Acoustimass

- 3 Toilets upgraded to electric

## Salon and Galley

### Salon

- Ultra leather seat cushions
- Folding "Luxe" saloon table with electric up/down mechanism
- Headroom: 1,98 m / 6'6"
- U shaped saloon bench
- 1 central unit with folding bench seat - Stowage - Bar
- Shelves and stowage along the hull, Storage under bench seats
- 1 Hull porthole with curtain
- 1 Fixed coachroof side window with pleated blind
- 1 Fixed wrap-around window to cockpit + Blind
- 1 Flush deck hatch with mosquito blind
- CHART TABLE
- Control console with flap - miscellaneous locker - Storage - Moulded wood fiddle
- Navigator's seat with (15°) tilting cushion to compensate for heel
- Electrics panel
- Navigation instrument panel
- Radio with stereo CD / MP3 player - 2 Loud speakers
- Battery switch panel + Breaker panel
- COMPANIONWAY
- Headroom: 1,99 m / 6'6"
- Wooden companionway with cold-moulded 3 steps
- 2 Leather covered stainless steel handrails

### Galley:

- Water-maker - Nautilus Marine S120 120/140 Lt/hr (new 2018)
- Sharp 1000W microwave oven
- 3 ring gas cooker & grill
- Espresso coffee maker
- Toaster
- Fridge (new condenser 2021) 52USG
- Freezer 26USG
- 10 place settings
- Pressure Cooker
- Extractor Hood
- Headroom: 1,97 m / 6'6" • Lengthways galley counter
- Synthetic resin worktop Grey
- 1 Sink with 2 rectangular bowls, in Grey synthetic resin
- 1 Valve - Hot/cold water mixer tap
- 1 Gas cooker 2 burners, Stainless steel oven on mountings
- 1 Fridge 200 L, ice-cube tray, front and top-opening
- 1 Cooler 100 L, top opening
- Cupboards - Drawers - equipped lockers
- 1 Hull porthole with curtain

- 1 Fixed coachroof side window with pleated blind
- 1 Fixed wrap-around window to cockpit + Blinds
- 1 Flush deck hatch with mosquito blind
- Propane bottle box in the cockpit
- Regulator and safety toggles

## Electrical and Electronics

### Electrical:

- Generator Onan 7.5 kw (680 hours)
- Battery charger 90 AH
- Wind Turbine
- Solar panels
- BM-2 12v Battery monitor
- Marinco 3KVA Inverter
- 4 x 120Ahr deep discharge lead acid service batteries (new 2021)
- 2 x 40A + 20A battery chargers (work on 220v 50/60 hz - or 110v shore power)
- 2 x 30mt (50 ft) 35A shore power cables
- 12 V circuit - 220 V circuit • 4 service batteries (2x140 Ah) - 1 Engine battery (110 Ah)
- 2 x 40 Ah Battery charger, 1 x 20 Ah charger - 1 220V shore power - 1 Power distributor
- Electrical panel (12 V / 220 V) (Circuit breakers - Voltmeter - Water gauge - Fuel gauge - Battery warning - Fuel warning) Sockets 220V
- Interior lighting:
- Halogen ceiling lights, Reading lights
- Outside lighting:
- 1 Forward and aft navigation lights
- 1 Engine navigation light / Spreader light forward of mast
- 1 Anchor light on masthead
- 1 Deck light
- Wire runs for options cables

### Electronics:

- B&G electronics suite- B&G Navionics with 3 screens
- B&G RI10 Broadband Radar - 2 Chanel - 4G
- 2 x Triton2 displays
- Triton 2 keypad
- W12 MFD 12" B&G display
- 2 x W9 MFD 9" B&G display
- B&G Forward facing sonar & hub (new 2022)
- B&G H90 VHF
- B&G H50 VHF
- BT1 Bluetooth adaptor
- AT10 NMEA Converter
- RF25 rudder feedback to electro/hydraulic autohelm
- Wi-Fi unit to use the B&G Link App to repeat the displays to tablets



- B&G hydraulic AC42 Autopilot (New 2021)
- DST810 Multi speed/depth/temp with Bluetooth App (New 2022)
- NAIS-400 AIS receiver/transmitter
- Precisión-9 compass
- WS320 Bluetooth mast head Windex (new 2021)
- Fitted Iridium GO satellite and data phone with antenna (new 2019)
- Smartfind 406 EPIRB
- DeepSea S1000 Emergency AIS transponder

### **Entertainment:**

- Fusion MS-RA70 Sound system with Bose speakers and bass bin (new 2021)

## **Mechanical**

- Engine Yanmar 4JH1 Diesel: - 110 HP/110 HP Common Rail (1675 hours)
- Straight propeller shaft w/Folding prop
- Engine control - Starting - Control panel in cockpit
- Engine compartment: Foam soundproofing - Ventilation: 1 air intake and 1 pressure air outlet
- 1 Alternator 12 V / 125 Ah
- 1 Rotomoulded diesel tank (415 L / 110 US Gal in the saloon) - Electronic gauge - Low level alarm - 1 Deck filler
- Filters: Sea water - Diesel - Water separator
- Engine access via companionway and machinery space (opening with gas piston)
- Silent Wind generator & solar with Bluetooth App control
- Air conditioning system with seawater compressor in stern, chilled water circulation, 4 x low noise condensers in cabins and salon
- 24v bow thruster

## **Hull & Deck**

- Full teak decking
- Extra fuel tank for generator
- Design in accordance with European Directive requirements and according to CE certification
- Monolithic hull design in polyester • Monolithic structural counter moulding laminated and bonded to the hull
- Deck in balsa and fiberglass sandwich covered in "diamond point" type non-slip surface
- Hull/deck joint screwed, bonded and covered with a single solid wood rubbing strake screwed in place
- Cast iron keel bonded and bolted using stainless steel bolts and counter plate
- Twin under-hung rudders with stainless steel stock
- White coloured hull - Grey metallic livery

### **MOORING**

- Anchor with 100mt (320 ft) galvanized chain and chain counter
- Self-draining chain locker • Stainless steel bow fitting 2 rollers - Stainless steel bobstay
- 12 V - 1500 W vertical electrical windlass - Remote control
- 8 Aluminium mooring cleats - Stainless steel deck line protection

### **SAIL LOCKER**

- Access through deck hatch - forward
- Stainless steel ladder
- Hatch giving access to chain locker

### **SAFETY ON DECK**

- 1 Open stainless steel forward pulpit
- 2 fixed stainless steel pushpits
- 1 Lifebuoys support bracket
- 1 Outboard engine bracket
- 1 Ensign staff
- Double guardrail and stainless steel stanchions - Openings in guardrail to port and starboard
- 2 Stainless steel handrails on deck
- 2 Stainless steel handrails on fixed arch

## **Cockpit**

The beam of the Sense 57 is carried aft to allow for a huge cockpit area. Her twin steering pedestals open up the cockpit for easy access fore and aft, and the hydraulic fold down swim platform extends this area and allows easy access to the water.

There are dual settees, Port and Starbd, and the hi/low table to Starbd is ideal for dining or cocktails. A hard top Bimini overhead provides a shaded environment with a center opening panel for sun if desired.

- 2 x Sunbrella side sun/wind/rain shades and fittings (new 2021)
- 2 Carbon Steering effect wheel consoles: Stainless steel steering wheels - 900 mm / 2'11" diameter - Leather covered - Stainless steel handrail - navigation instrument support (optional instruments) - Glass holder - 2 Steering compass on binacle
- Wireless remote for hydraulic bathing platform
- Low level blue lighting to cockpit floor
- Starboard Wood Cockpit Table with Electrical UP / Down System
- Port Cockpit Table with Foldaway Seat
- Luxe Cover pack Wheels and Table
- Full set of gray Teflon fabric cockpit cushions 16pcs
- Fixed Bimini Hard top with retractable canvas sunshade -
- Electric starboard coach roof winch upgrade
- Harken port coach roof rewind rope handling winch H46.2STECH

- Luxe coach roof sprayhood (dodger) - cadet grey
- Cockpit windlass control with chain counter
- Self-draining cockpit, natural solid wood decked
- 1 Port cockpit locker - Access to technical area or Occasional cabin (option)
- 1 Starboard cockpit locker - Access to technical area
- Gas locker beneath starboard cockpit seat
- Natural solid wood slatted cockpit benches
- 1 Liferaft locker in cockpit sole
- 2 Deck access points to tiller system
- 1 Tiller • Engine throttle and control panel to starboard • Wooden cockpit table with leaf to starboard which can be transformed into sun-bathing area
- 1 Fixed composite arch
- 2 waterproof loudspeakers on fixed arch
- Cockpit lighting integrated in fixed arch
- 1 PMMA companionway door
- 2 Fixed windows to the aft of the coachroof
- 1 Hot and cold cockpit shower
- 1 Shore power socket

#### **AFT TRANSOM**

- Fully opening transom, convertible to bathing platform (3,20 m x 0,80 m / 12'6" x 2'7")
- Electrically controlled opening
- Natural solid wood decking on swim platform
- 1 Folding bathing ladder (stainless steel), solid wood steps, handrails

## **Plumbing**

- 3 Rotomoulded freshwater tanks (3 x 200 L / 3 x 53 US Gal) - Saloon / Side cabins - Separate fillers - Tank selection with "¼ turn" by-pass valves
- Pressurised electric water pump - Expansion tank - Inline filter • 40 L / 11 US Gal Electric calorifier (Operation off engine or on 220 V electrical system)
- 1 Rigid 80 L / 21 US Gal black water holding tank for each WC • Electrical shower drain pumps
- 2 Electric bilge pumps - 1 Manual bilge pump
- 1 Electric ice box drain pump

## **Sails and Rigging**

- Standard mast - SELDEN 9/10 anodized aluminium installed on the deck, 2 aft-swept spreaders - MDS roller slides
- Anodised aluminium boom • Discontinuous stainless steel standing rigging

- Backstay: Bridle
- Rigid boom vang with tackle
- Genoa furling system with drum on the deck
- 2 "STANDUP" blocks for mainsail on fixed composite arch
- 2 Genoa tracks with piston adjusted traveller cars - 2 Genoa sheet turning blocks • Rigging run back to cockpit (except boom topping lift)
- Complete running rigging: Main halyard, genoa halyard with clutch on mast and cleat, Boom topping lift with cleat on mast, Mainsheet, 2 Genoa sheets 2 rapid reefing lines, 1 manual reef
- 12 Jammers, and other control lines
- 2 rope boxes

### **WINCHES**

- 2 Harken Self-tailing 2 speed genoa sheet winches (H60.2 STC)
- 2 Harken Self tailing 2 speed coachroof winches (H46.2 STC to starboard, H50.2 STC to port)
- 2 Winch handles SpeedGrip
- 2 Winch handle boxes

### **SAILS**

- Full battened Main sail with 3 reefing lines 72m2
- Roller furling Genoa 73m2
- Dacron furling genoa, double thickness with UV protection strip
- Carbon Code-0 cruising shoot on roller furling 138m2
- Hank on staysail rated to 50kn apparent 28m2 (new 2019)
- Hank on storm staysail rated to 65kn 12m2 (new 2019)
- All new sheets, halyards and blocks 2019
- Selden Carbon spinnaker pole 7.3mt (new 2019)
- Selden extendable whisper pole 5mt (new 2019)
- Selden running back stays (new 2019)
- Hydraulic back stay tensioner
- Sunbrella sail stack bag (new 2021)
- adjustable genoa cars from the cockpit
- Asymmetric Spinnaker Gear

### **Additional Equipment**

- 6 person tender with 2.5HP Suzuki outboard and paddles (not registered or titled)
- 10-man SOLAS life raft
- Electric pedestal to both saloon and cockpit table
- 3x 12lt dive tanks & demand valves
- Dive tank filling compressor - runs direct from the Gen
- Daewoo 7kg Twin tub cloth washing machine and drain pump (new 2021)
- Electric fans to bedrooms

- 3 x Electric heads Jabsco (2 new macerators 2022)
- High pressure saltwater deck wash
- Shore fresh water supply and filters
- Extending boat pole
- Vacuum cleaner and Dust Buster
- Grab bag
- Cordless grinder/cutter
- SOLAS 1st aid kit
- 4 fire extinguishers and blanket
- tools and spares
- washing machine
- NOTES:
- Anti-foul Jan 2022
- Engine and Gen full-service Nov 2021
- Rigging check 2021
- Dive compressor new filters 2022

## Manufactures Comments

The Sense 57 is an ocean cruising yacht with an audacious concept. She is the pride of the range and everything about her spells adventure. With all her primary cabins located forward of the Salon, the deck plan of the Sense-57 is both clever and exceptional. As a result, the cockpit is closer to water level which emphasizes her slender profile. The Sense 57 is perfectly balanced under sail and highly maneuverable. She is remarkably comfortable sailing in all sea conditions, With really fluid movement on board, unique style and redesigned access to the sea, she delivers outstanding comfort under sail, and she boasts fine cruising speeds.

Getting-away takes on a whole new meaning.

The Sense 57 has everything it takes to enjoy outdoor life at its very best. Incredibly spacious, the cockpit, sheltered by a semi-hard top, converts into a huge sunbathing area. A magnificent aft swim platform lowers to sea level, offering you every opportunity to enjoy the water. To delight in every moment, the outdoor galley has a grill and a sink cleverly concealed below the helm seats.

### EXTERIOR

B&G electronics pack, instrument panel at each helm station: Housing for 9" plotter in addition to repeaters (options)

Exterior galley with grill and sink concealed in the helm seats.

Large hull portholes provide more light and an extensive sea view.

Swim platform that lifts to close making the cockpit safe under sail.

Opening semi-hard Bimini top. Extra elements can be added to close off the cockpit completely.

### INTERIOR

Master cabin: island bed with marine mattress and slatted bed frame; lots of storage (up to 5 drawers, hanging lockers, etc.), a leather dressing table and retractable 22" TV with motorized lift system (on option). Ensuite bathroom with shower separate from the toilet. Two guest cabins with ensuite bathroom and sliding door access.

Optional: Extra cabin accessed by the cockpit.

Built in fitted galley (lengthwise). Attractive grey synthetic resin worktop. Fully concealed electrical appliances when galley is not in use (retractable worktop on gas hob, panel in front of oven). Large porthole / service hatch opening onto the cockpit saloon (512 mm x 322 mm).

An ensuite bathroom with shower and toilet in each cabin.

Very comfortable companionway: 3 steps lead to the saloon (instead of the usual 5), sloping at an angle of 45°.

Central furniture incorporating an extra seat, 2 people, for the chart table. A 32" retractable TV on motorized lift system (option). Its location supports you in the galley when the boat heels and provides an additional grab rail.

## Exclusions

Owner's personal effects are excluded from the sale

## Disclaimer

The company offers the details of this vessel in good faith but cannot guarantee or warrant the accuracy of this information nor warrant the condition of the vessel. A buyer should instruct his agents, or his surveyors, to investigate such details as the buyer desires validated. This vessel is offered subject to prior sale, price change or withdrawal without notice.























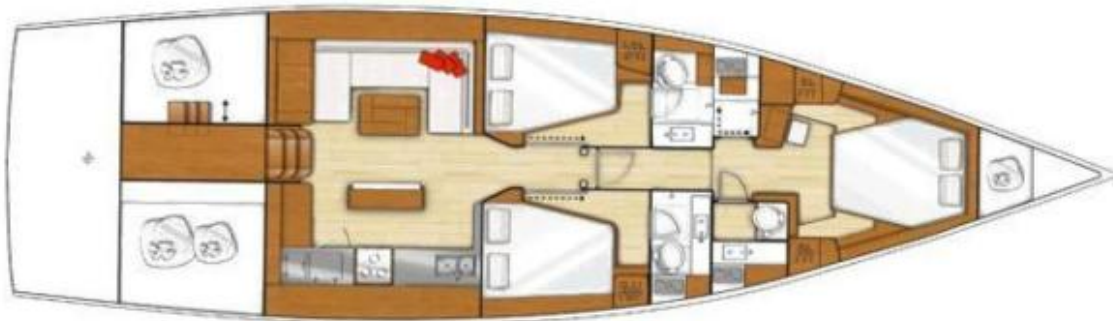
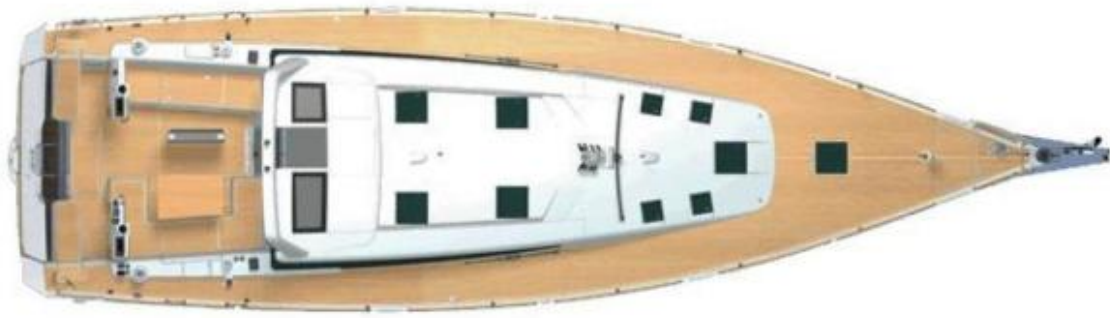

Extra cabin accessed by the cockpit.

