



126' (38.00m) 2024 Inace Explorer
Fortaleza Brazil



OVERVIEW

Manufacturer:	Inace	Hull Material:	Steel
Engines:	2 Caterpillars	Cruise Speed:	Knots
Engine Model:	C18	Max Speed:	Knots
Engine HP:	0	Cabins/Heads:	/
Beam:	26' 0"	Fuel Type:	Diesel
Max Draft:	7' 9"	Fuel:	
Water:			

\$14,995,000



Data Sheet

Category: Trawlers

Condition: New

Model Year: 2024

Beam: 26' (7.92m)

Max Draft: 7' 9" (2.36m)

LOA: 126' (38.40m)

Knots

Knots

Fuel Type: Diesel

Hull Material: Steel

Builder: Inace

Designer: Luiz Debasto

Engines/Generators

Engine 1

Caterpillars

C18

Fuel: Diesel

Engine 2

Caterpillars

C18

Fuel: Diesel

Summary/Description

For Sale

A touch more style, the next generation of Expedition yachts, the superb 126' aft house explorer yacht by Luiz Debasto design has the same impressive sea keeping qualities that INACE is famous for.

The aft deck and swim platform have been extended in this version also creating more room on the bridge deck and flybridge deck and increased space in the engine room. The extra space has allowed us to expand the seating areas on all of the decks.

There is a large master plus 4 ensuite guest cabins and a great skylounge and flybridge There is tons of room for for toys and a large tender. The expedition yacht has a 4000 NM cruising range to take you anywhere. The huge engine room easily accommodates twin Cat engines and generators. Built to ABS and MCA specifications for your safety as well as the highest standards.

PRICE ON REQUEST. **5% Commission to Selling Broker**

Just Added Scale model images have been added at the bottom of the page

Dimensions

Displacement: 322

Engines

Cruising Speed: 10.5

Max Speed: 12.5

Tanks

Fuel: 16300

Fresh Water: 2300

Under Construction - The second in this Series

A touch more style, the next generation of Expedition yachts, the superb 126' aft house explorer yacht by Luiz Debasto design has the same impressive sea keeping qualities that INACE is famous for.

The aft deck and swim platform have been extended in this version also creating more room on the bridge deck and flybridge deck and increased space in the engine room. The extra space has allowed us to expand the seating areas on all of the decks.

There is a large master plus 4 ensuite guest cabins and a great skylounge and flybridge There is tons of room for for toys and a large tender. The expedition yacht has a 4000 NM cruising range to take you anywhere. The huge engine room easily accommodates twin Cat engines and generators. Built to ABS and MCA specifications for your safety as well as the highest standards



Photo 1 Photo 1



Main Salon Main Salon



Master Stateroom Master Stateroom

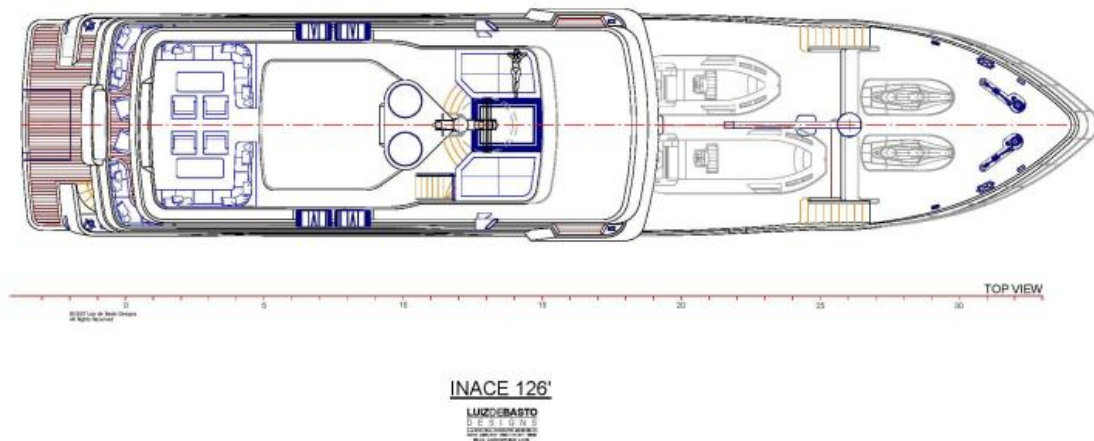

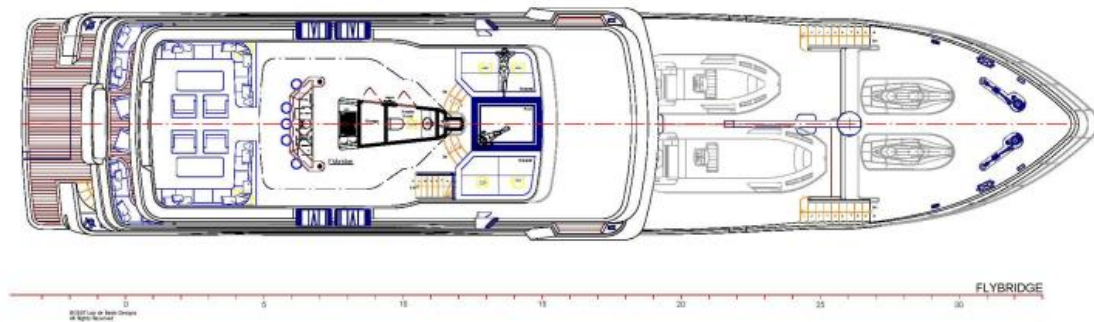

INACE 126'

LUZARASTO
DESIGN
CONSTRUCTION

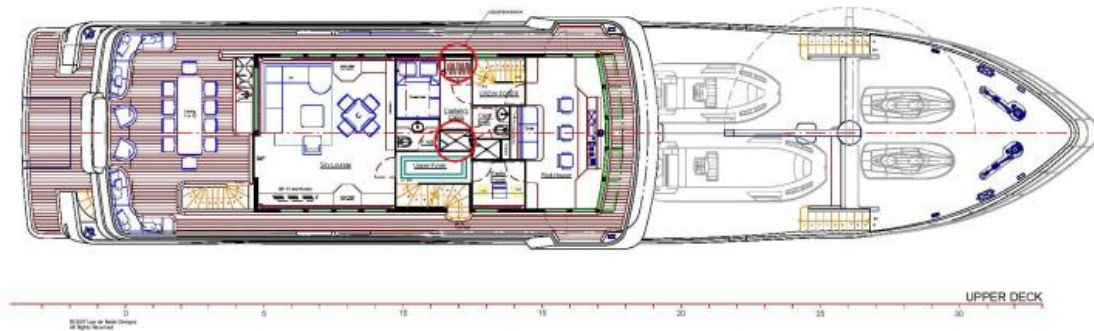

INACE 126'

LUZARASTO
DESIGN
CONCEPT DESIGNER
DESIGNER OF THE YEAR
2011

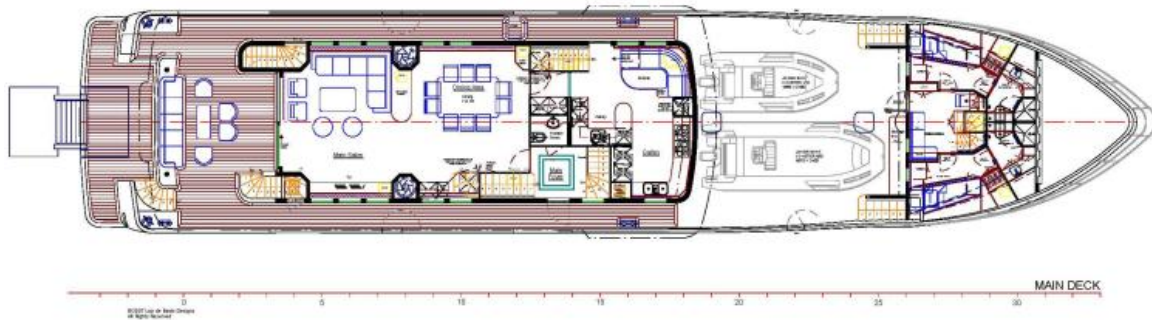

INACE 126'

LUZARASTO
DESIGN
CONSTRUCTION



INACE 126'

LUZDERASTO
DESIGN
CONCEPT DESIGN & ARCHITECTURE
WWW.LUZDERASTO.COM

NOTE:

- VIP1 and VIP2 has been changed according to the new layout.
- All portlights in the VIP1 and VIP2 has been moved forward for 100mm.
- A bookshelf has been created in the Owner's Suite, moving forward for 20mm like 2 doors to the Owner's Bathroom.

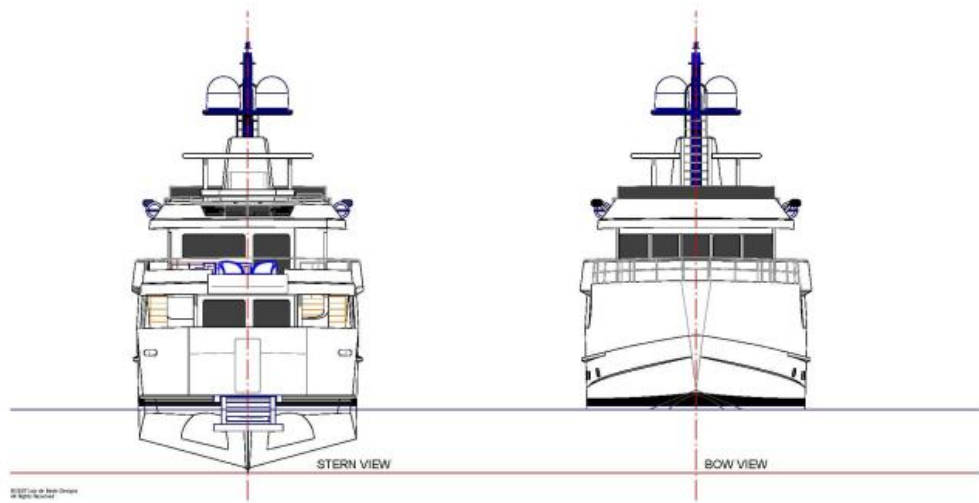

INACE 126'

LUZ DE BOK
DESIGN
LUTZ DE BOK DESIGN GMBH
LUTZ DE BOK DESIGN GMBH
LUTZ DE BOK DESIGN GMBH



INACE 126'

LUZDEBASTO
DESIGNS
CONVERTING BUSINESS ADDRESS
2000 2000 2000 2000 2000
2000 2000 2000 2000 2000

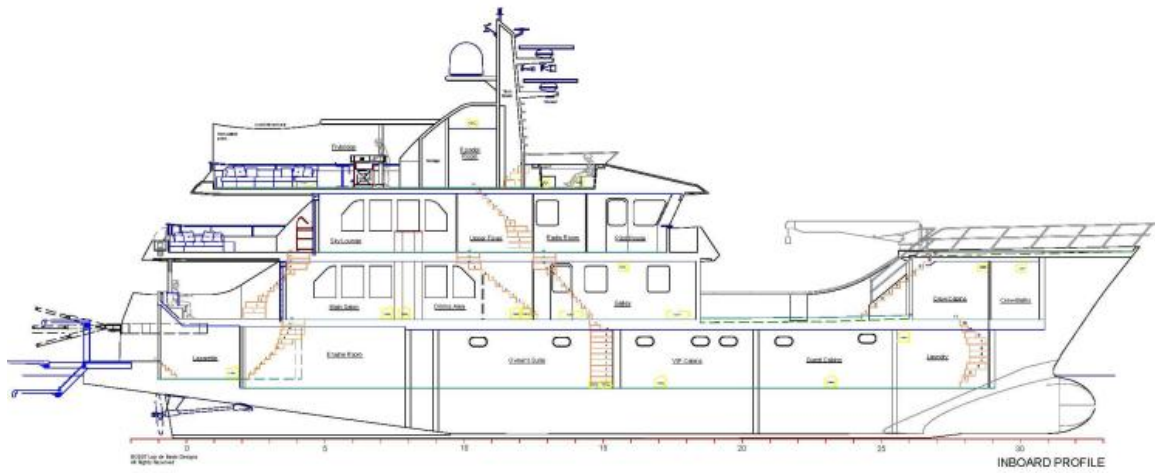

INACE 126'

LUZARASTO
DESIGN
CONCEPT DESIGN AND ARCHITECTURE
WWW.LUZARASTO.COM