



PANDION

44' (13.41m) 2009 Lagoon Lagoon 440
St. Augustine Florida United States



OVERVIEW

\$370,000

Manufacturer: *Lagoon*

Engines: 1 YANMAR

Engine Model: 4JH4AE (Port) 4JH57 (Starboard)

Engine HP: 54

Beam: 25' 3"

Max Draft: 4' 3"

Water: 240 G (0 L)

Hull Material: Fiberglass

Cruise Speed:

Max Speed:

Cabins/Heads: 3 / 3

Fuel Type: Diesel

Fuel: 170 G (0 L)



Murray Yacht Sales Info@MurrayYachtSales.com

800-826-2807

Data Sheet

Category: Catamaran

Condition: Used

Model Year: 2009

Beam: 25'3" Max Draft: 4' 3" LOA: 44'
(13.41m)

Cabins: 3

Heads: 3

Fuel Type: Diesel

Hull Material: Fiberglass

Bridge Clearance: 70'

Displacement: 10 tonnes

Fuel Tank: 170 gal Fresh Water: 240 gal

Holding Tank: 60 gal Imported: Yes

HIN/IMO: FR-CNB44357B909

Stock #: 480037

Engines/Generators

Engine 1

YANMAR

4JH4AE (Port) 4JH57 (Starboard)

54HP

Fuel: Diesel

Hours: 3077

Year: 2009 (Port) 2015 (Starboard)

Summary/Description

Used Sail Catamaran for sale

PANDION is a 2009 Lagoon 440 catamaran, is one of the last built of the highly successful 440 model that combines performance blue water sailing with comfort. She is the preferred owner's version, with 3 cabins and 3 heads. The Owner's stateroom includes a separate walk-in shower. The port forward cabin has been converted to a tool shop, complete with custom shelves, a work bench and vise; the space can be easily converted back to a cabin with berth. Never chartered. Survey from 2022 available for review.

She is completely loaded with everything a serious cruiser would want onboard, including: upgraded Leisure Furl boom furling system with custom-made mainsail and a 1,000-square ft Code Zero furling sail both built by Mack Sails. Major upgrades for cruising include two upgraded inboard Yanmar diesel engines (54 HP & 57 HP – standard engines for the 440 are 40 HP), complete new Raymarine electronics package installed in 2022, including 2 Axiom chart plotters, Evolution Autopilot with remote Smart Controller, AIS 700 transmitter & receiver, Doppler Radar, and six i70s instrument displays for depth, wind, speed, and more. New house battery bank was installed in 2023 with AGM batteries totaling 1125 AH, Cummins Onan marine generator with only 2400 hours, CruiseAir A/C, Spectra Ventura 150 water maker, 11 ft hard bottom inflatable dinghy with Yamaha 20 HP outboard, custom stainless steel transom arch with six solar panels generating over 800 watts, rub rail, new (2022) Fusion Bluetooth sound system with JL audio speakers, Bauer Jr. dive compressor for filling scuba tanks, large custom top loading freezer, inverter, Flexofold three-blade folding props, and washing machine.

Owner is currently cruising in Bahamas with an anticipated return to USA in May 2024.

Layout & Accommodations

Forepeak cabin bunk decks and cabinetry from factory, just add a mattress

Washing machine in master quarters

Delightful full size walk in shower

All three heads electric flush with fresh water

Flatscreen TV in each cabin, 43" TCL flat screen LED in main salon

Port forward cabin serves as a convertible shop with workbench, vise, and lots of storage shelves

Galley

Under cabinet mounted Microwave 110V

Water purifier with separate faucet, sea water foot pump with separate faucet

Three burner propane cooktop and Eno oven, two dedicated propane tanks located in cockpit

Triple stainless steel sinks

Upgraded stainless fridge and freezer 12V

Top loading custom freezer in cockpit area

Corian counter tops

Deck & Equipment

All new ground tackle installed in 2022 – galvanized steel Rocna33 anchor (73 lb), with 150 ft G4 7/16" (12 mm) galvanized steel anchor chain, and Mantus stainless steel anchor swivel

Quick 1500W Anchor Windlass, complete rebuild in 2022 (all shaft seals and bearings replaced)

Full set of cockpit cushions in good condition

Fly bridge has 2 custom helm seats with arm rests

Large custom stainless steel arch aft. \$15,000 with six solar panels, generating over 800 watts power

Custom Rub rail installed \$4000 value

Teak Cockpit Floor

Two electric Harken self tailing two-speed winches at Helm, each with two Harken remote foot switches; and two manual two-speed self tailing Harken winches at Helm; and 1 self tailing Harken manual winch in cockpit for lifting dinghy

GalleyMate (Made in Australia) high quality propane BBQ with rotisserie, dedicated 20 lb tank

Nav Station throttle controls

18 ft Fiorentino Sea Anchor with 450 ft rode

Shark Drag Drogue with 65 ft bridle legs (bridle can be used for emergency steering)

4 person Winslow Life Raft

Life Sling MOB device

Rear cockpit surround with white mesh enclosure provides bug-free shade

Fortress secondary anchor with 50 ft 3/8 inch galvanized chain

New Bimini and dodger (sunbrella) installed 2023 (\$1,500)

Marinco yellow 50A 50 ft. shore power cord, new Marinco 50A 50 ft. shore power cord purchased in 2019, including a Marinco Reverse Y Adapter to convert two 30A outlets to 50A service.

Aluminum LPG 10 lb. tanks for galley stove/oven, and new 10 lb. painted steel tank (2024).

Electronics & Navigation

Complete new Raymarine electronics package installed in 2022 (\$30,000) including:

Two Raymarine AXIOM MFD chartplotters (at helm and nav station), with updated Navionics charts for Florida and Bahamas

Raymarine Evolution EV-400 Sailing Vessel Autopilot pack with P70R rotary control head, and remote Smart Controller

Raymarine Quantum 2 Doppler Radar

Six Raymarine color LCD i70s instrument displays to monitor wind, speed, depth, course info, etc.

Raymarine wind transducer and mast cable

Raymarine AIS 700 transmitter and receiver integrated in AXIOM chart plotters

Fusion MS-RA70 Sound System with JL Audio 600 watt marine channel amplifier

Two Blue Sky SB3024 solar charge controllers installed in 2023

In addition, vessel has:

Standard Horizon Quantum GX5000S VHF radio with PA system, auto fog horn, and DSC

BW8 Bilge monitoring system with four sensors per hull

JL Audio speakers

Blue Sky solar charge control panel in salon

Raymarine Joystick steering from salon at Nav Station

LED lights throughout

Biometric security locking SAFE

Electrical, Power & Plumbing

New house battery bank installed in 2023 with VMAX 6 volt 225 AH AGM batteries, totaling 1,125 AH, connected in series parallel configuration for 12-volt system (\$3,000)

Two new Balmar 70 amp alternators, with upgraded Balmar MC-618 and Centerfield voltage regulators installed, and new Yanmar ECM module installed on starboard engine in 2021 (\$5,800)

New 12 volt starter battery for dinghy 20 HP Yamaha electric start, installed in December 2023

Bauer Jr.Dive compressor 110V installed

All USA Electrical System factory installed

Xantrex Freedom 3000 charger/inverter 12V to 110V 3000 Watt, Xantrex battery monitor

Dolphin 12-volt 80 amp charger for starting batteries

Galvanic isolator to prevent electrolysis when running shore power

Spectra Ventura 150 Watermaker (rebuilt by Spectra in 2022) produces about 6.5 - 7 gph on 12 volt 3.5 amps

Fresh water 12-volt wash down pump for anchor and chain, installed in 2023

New automatic and back up bilge pumps installed in both starboard and port keels in 2023

Engine & Mechanical

Second set of Yanmar engine controls at Nav station.

FlexoFold three blade folding Bronze propellers. New port prop hub installed in April 2023.

Engines and saildrives recently serviced during haul out in 2023, and subsequent preventative maintenance in 2023 and 2024, including SD 50 saildrives drive cones lapped, shaft seals replaced and gear oil changed, seawater pump impellers replaced, coolant changed, engine oil and filters changed, RACOR fuel filters replaced, fan belts replaced, new saildrive and prop anodes installed

Spare parts and backup components inventory.

Cummins Onan generator 11.5 KW 110V 60 hz, 2400 hours. Refit with custom raw water pump and filter that eliminates common issues with cooling on Lagoon 440s. Supplemental Racor fuel filter system added. Engine oil and filter changed in December 2023, new belt installed in March 2024.

Dual Racor 500 fuel filters on each inboard diesel engine with changeover valve to change fuel filter on the fly.

12-volt fuel transfer system passing through a dedicated Racor 500 filter to polish fuel from one fuel tank to the other.

Manual switched electric booster pump on each engine to prime filters or act as a backup if primary fuel pump fails.

Middle fresh water tank, 80 gal, is set up to convert to diesel storage in minutes if ever desired.

Both engine rooms have been fitted with FireBuoy emergency fire extinguishers that deploy with excessive heat and are monitored and alarmed at the helm.

Sails & Rigging

Leisure Furl Boom furling system by Forespar, designed in New Zealand, with custom-made main sail built by Mack Sails (\$30,000)

Installed new 1,000 sq ft Code Zero furling sail built by Mack Sails in 2018 (\$3,000) and refurbished by Mack Sails in 2023

Refurbished furling jib sail in 2019

Bowsprit pole factory installed

Harken Traveler car system upgraded to avoid typical 440 early wear

Blocks on traveler upgraded to Harken Black Magic with more robust bearing design

Wichard Gybe Boom Preventer softens the effect of accidental gybe by "easing" the boom to lee during an event.

Wichard Jack lines for safety from stern to bow

Additional Information

Dinghy

2010 11.9 ft Achilles Dinghy with electric start Yamaha 20 hp outboard engine, with RACOR external fuel filter system. Engine is serviced on regular schedule, including oil and filter changes in December 2023, and water pump impeller replaced in March 2024. New 12-volt starter battery installed in December 2023. New RACOR fuel filter installed in January 2024.

New bottom paint Pettit Hydrocoat (black) antifouling paint, Zincs, sail drive service during haul out in February 2023.

Haul out May 2024

Sail drives serviced with new oil and seals

New zincs

Replaced rudder bearings

Flexifold Props serviced and lubed with Prop-Speed antifouling



Used Sail Catamaran for sale 2009 Lagoon 440 - PANDION



Used Sail Catamaran for sale 2009 Lagoon 440 - PANDION



Used Sail Catamaran for sale 2009 Lagoon 440 - PANDION



Used Sail Catamaran for sale 2009 Lagoon 440 - PANDION



Used Sail Catamaran for sale 2009 Lagoon 440 - PANDION



Used Sail Catamaran for sale 2009 Lagoon 440 - PANDION



Used Sail Catamaran for sale 2009 Lagoon 440 - PANDION

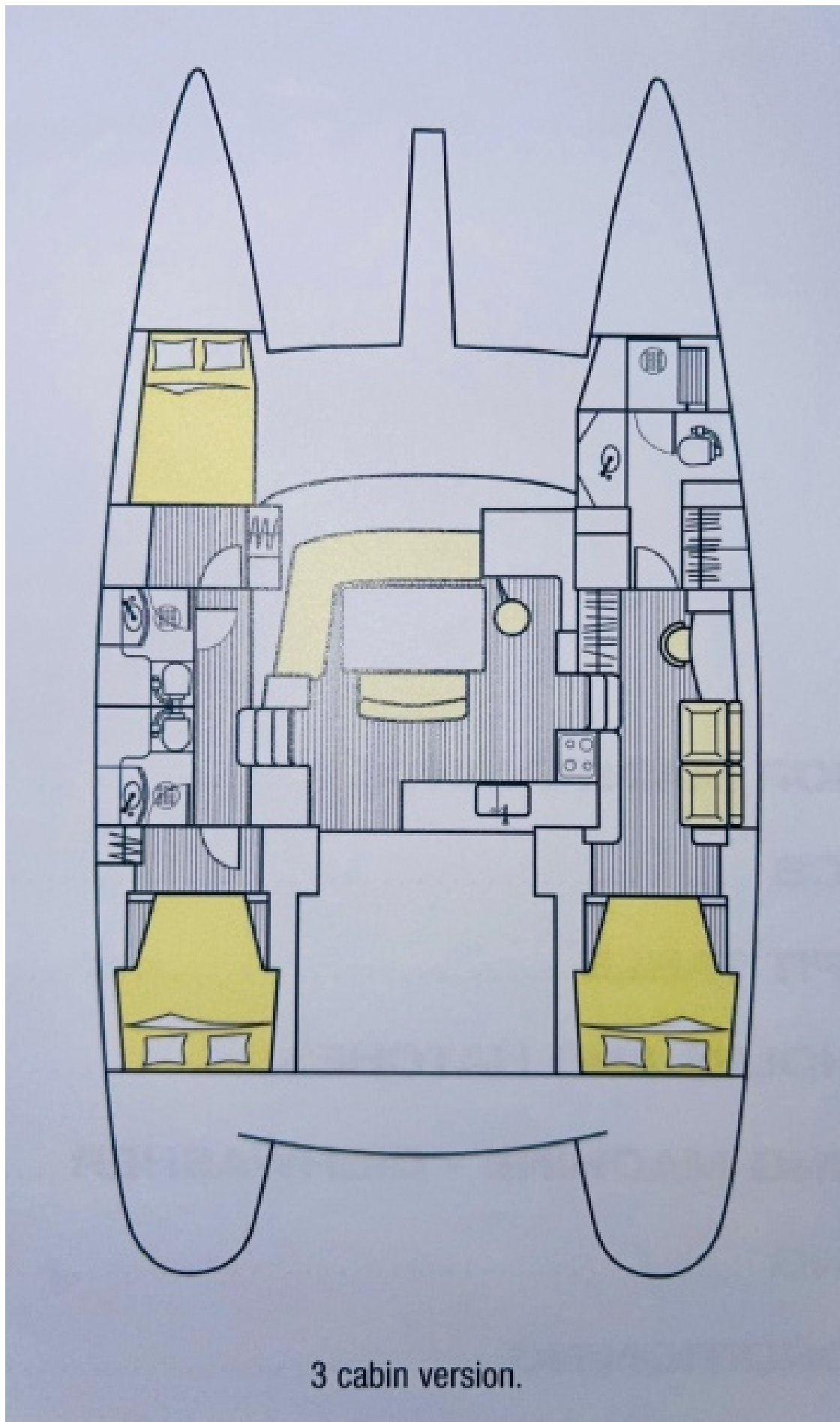

Used Sail Catamaran for sale 2009 Lagoon 440 - PANDION



Used Sail Catamaran for sale 2009 Lagoon 440 - PANDION



Used Sail Catamaran for sale 2009 Lagoon 440 - PANDION



Used Sail Catamaran for sale 2009 Lagoon 440 - PANDION



Used Sail Catamaran for sale 2009 Lagoon 440 - PANDION



Used Sail Catamaran for sale 2009 Lagoon 440 - PANDION



Used Sail Catamaran for sale 2009 Lagoon 440 - PANDION



Used Sail Catamaran for sale 2009 Lagoon 440 - PANDION



Used Sail Catamaran for sale 2009 Lagoon 440 - PANDION

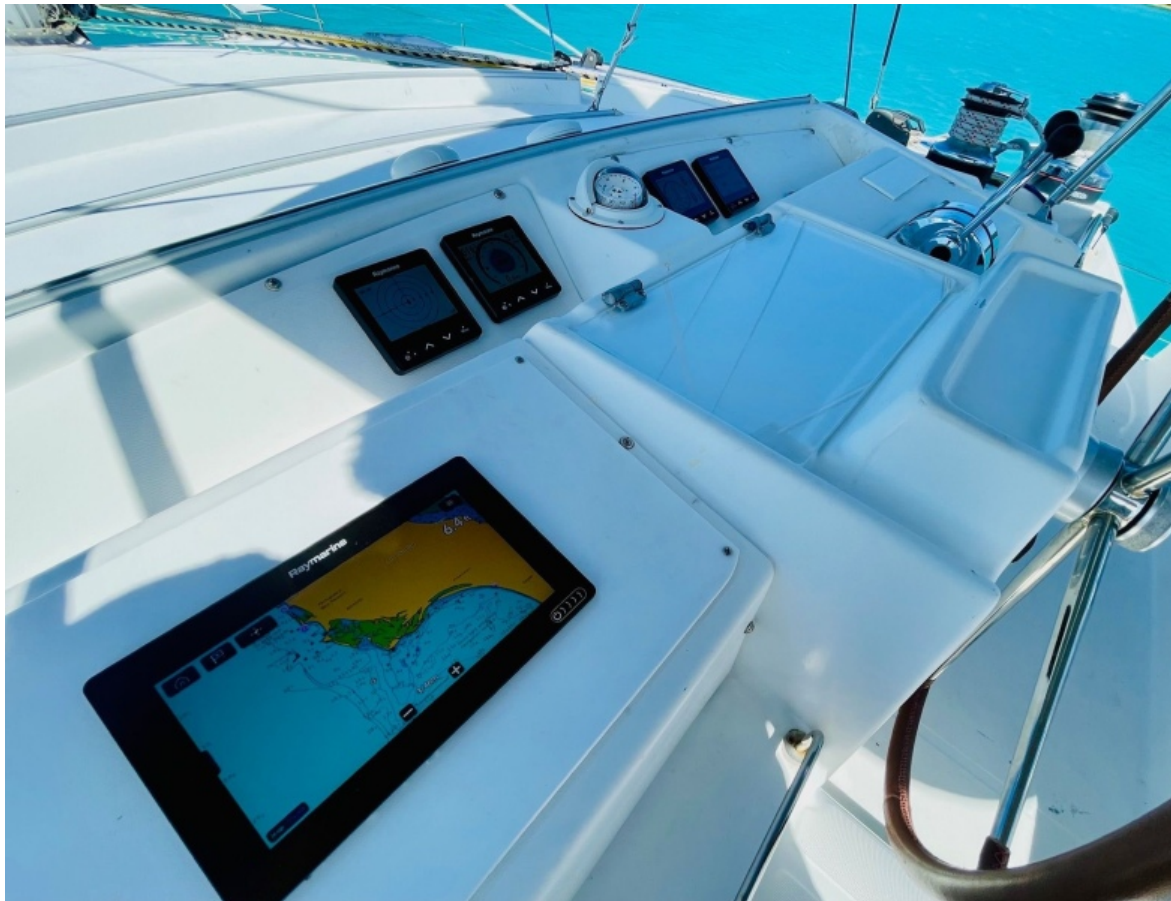

Used Sail Catamaran for sale 2009 Lagoon 440 - PANDION



Used Sail Catamaran for sale 2009 Lagoon 440 - PANDION



Used Sail Catamaran for sale 2009 Lagoon 440 - PANDION



Used Sail Catamaran for sale 2009 Lagoon 440 - PANDION



Used Sail Catamaran for sale 2009 Lagoon 440 - PANDION



Used Sail Catamaran for sale 2009 Lagoon 440 - PANDION



Used Sail Catamaran for sale 2009 Lagoon 440 - PANDION



Used Sail Catamaran for sale 2009 Lagoon 440 - PANDION

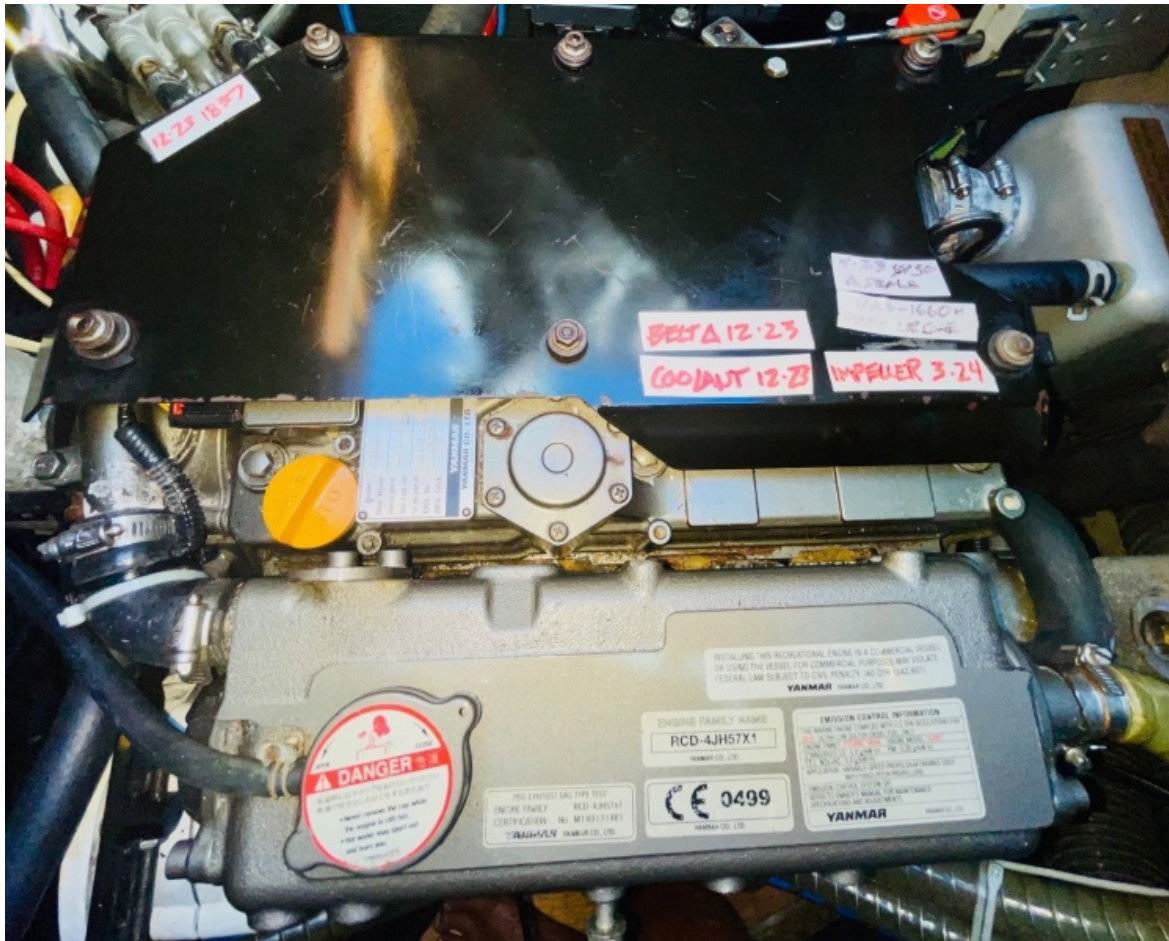

Used Sail Catamaran for sale 2009 Lagoon 440 - PANDION

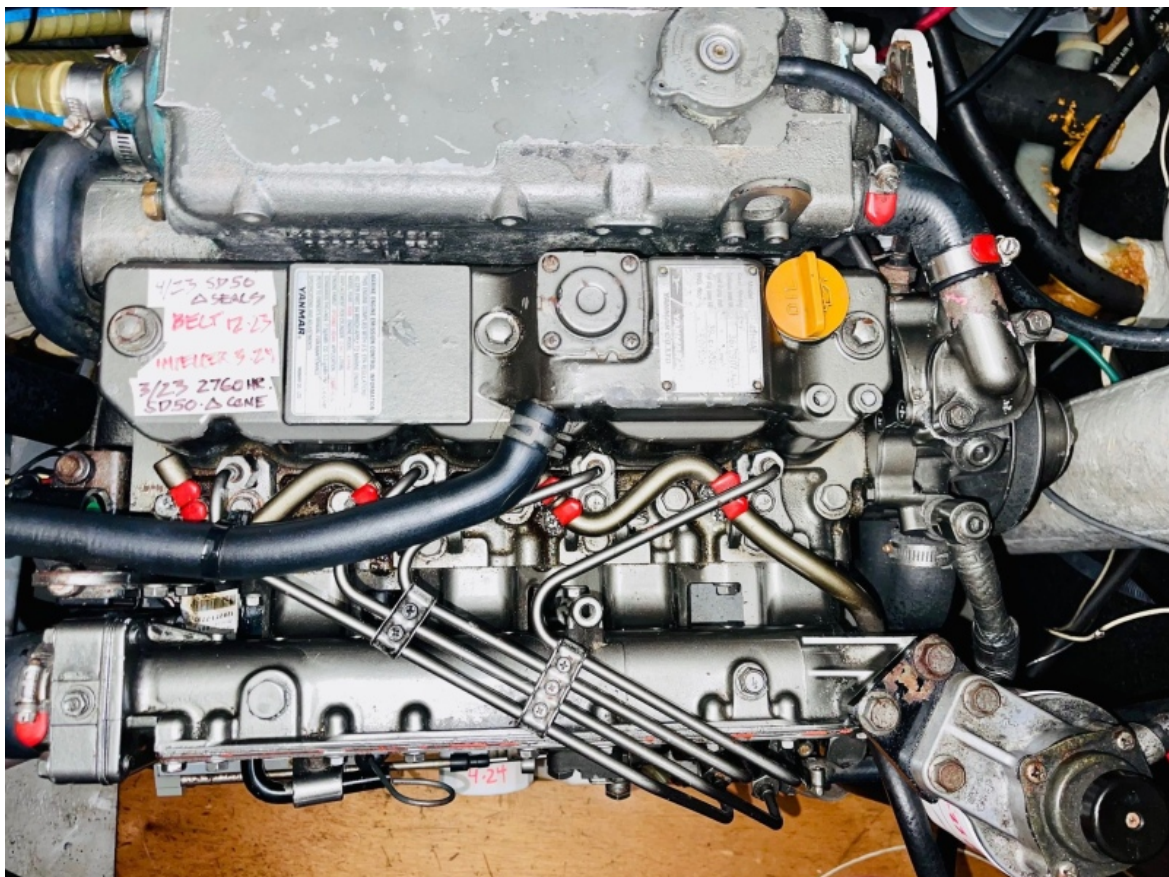

Used Sail Catamaran for sale 2009 Lagoon 440 - PANDION

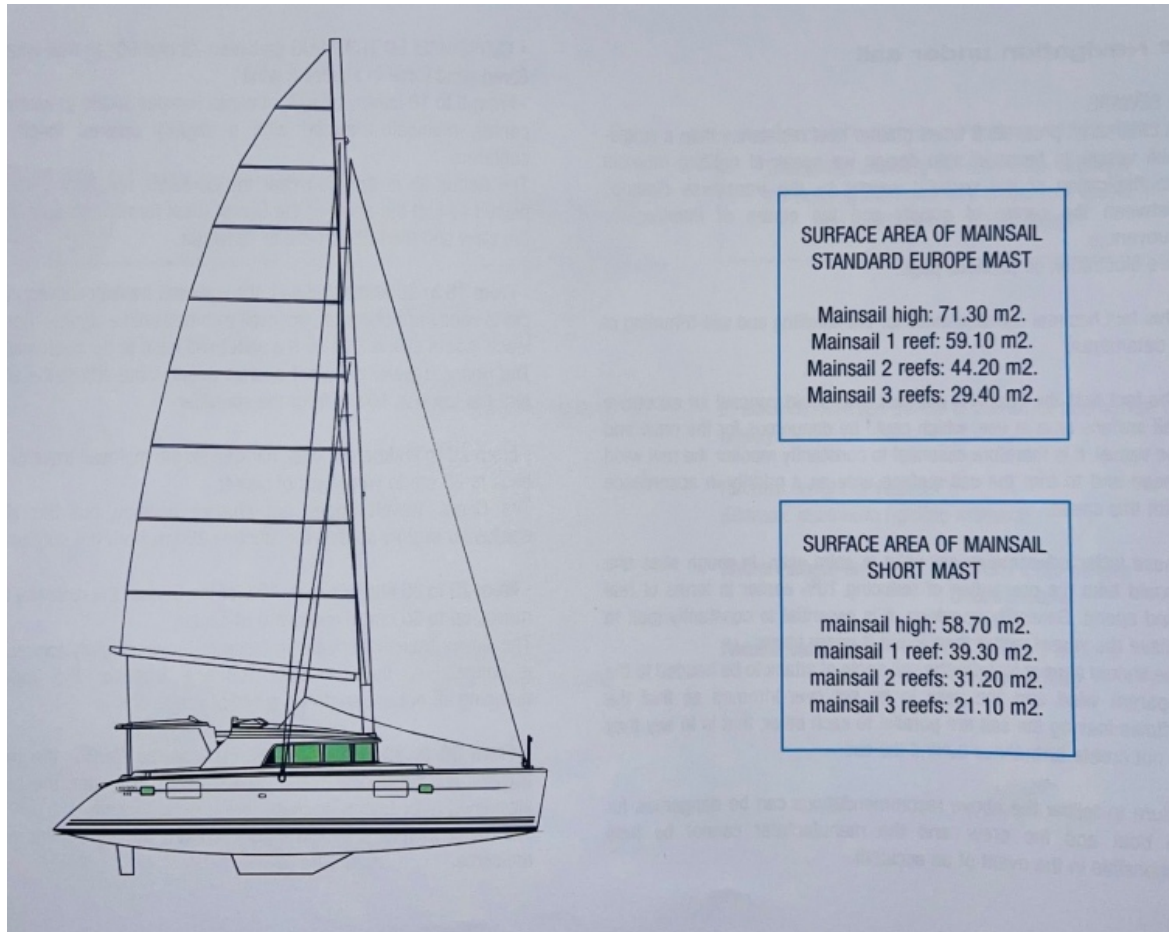

Used Sail Catamaran for sale 2009 Lagoon 440 - PANDION