



126' (38.00m) 2024 Inace Explorer  
Fortaleza Brazil



## OVERVIEW

Manufacturer:	Inace	Hull Material:	Steel
Engines:	2 Caterpillars	Cruise Speed:	Knots
Engine Model:	C18	Max Speed:	Knots
Engine HP:	0	Cabins/Heads:	/
Beam:	26' 0"	Fuel Type:	Diesel
Max Draft:	7' 9"	Fuel:	
Water:			

\$14,995,000





## Data Sheet

Category: Trawlers  
Condition: New  
Model Year: 2024  
Beam: 26' (7.92m)  
Max Draft: 7' 9" (2.36m)  
LOA: 126' (38.40m)

Knots  
Knots  
Fuel Type: Diesel  
Hull Material: Steel

Builder: Inace  
Designer: Luiz Debasto

## Engines/Generators

### Engine 1

Caterpillars  
C18  
Fuel: Diesel

### Engine 2

Caterpillars  
C18  
Fuel: Diesel



## Summary/Description

For Sale

A touch more style, the next generation of Expedition yachts, the superb 126' aft house explorer yacht by Luiz Debasto design has the same impressive sea keeping qualities that INACE is famous for.

The aft deck and swim platform have been extended in this version also creating more room on the bridge deck and flybridge deck and increased space in the engine room. The extra space has allowed us to expand the seating areas on all of the decks.

There is a large master plus 4 ensuite guest cabins and a great skylounge and flybridge There is tons of room for for toys and a large tender. The expedition yacht has a 4000 NM cruising range to take you anywhere. The huge engine room easily accommodates twin Cat engines and generators. Built to ABS and MCA specifications for your safety as well as the highest standards.

PRICE ON REQUEST. **5% Commission to Selling Broker**

Just Added Scale model images have been added at the bottom of the page

## Dimensions

Displacement: 322

## Engines

Cruising Speed: 10.5

Max Speed: 12.5

## Tanks

Fuel: 16300

Fresh Water: 2300

## Under Construction - The second in this Series

A touch more style, the next generation of Expedition yachts, the superb 126' aft house explorer yacht by Luiz Debasto design has the same impressive sea keeping qualities that INACE is famous for.

The aft deck and swim platform have been extended in this version also creating more room on the bridge deck and flybridge deck and increased space in the engine room. The extra space has allowed us to expand the seating areas on all of the decks.

There is a large master plus 4 ensuite guest cabins and a great skylounge and flybridge There is tons of room for for toys and a large tender. The expedition yacht has a 4000 NM cruising range to take you anywhere. The huge engine room easily accommodates twin Cat engines and generators. Built to ABS and MCA specifications for your safety as well as the highest standards

## Disclaimer

The Company offers the details of this vessel in good faith but cannot guarantee or warrant the accuracy of this information nor warrant the condition of the vessel. A buyer should instruct his agents, or his surveyors, to investigate such details as the buyer desires validated. This vessel is offered subject to prior sale, price change, or withdrawal without notice.



Photo 1 Photo 1



Main Salon Main Salon





Master Stateroom Master Stateroom

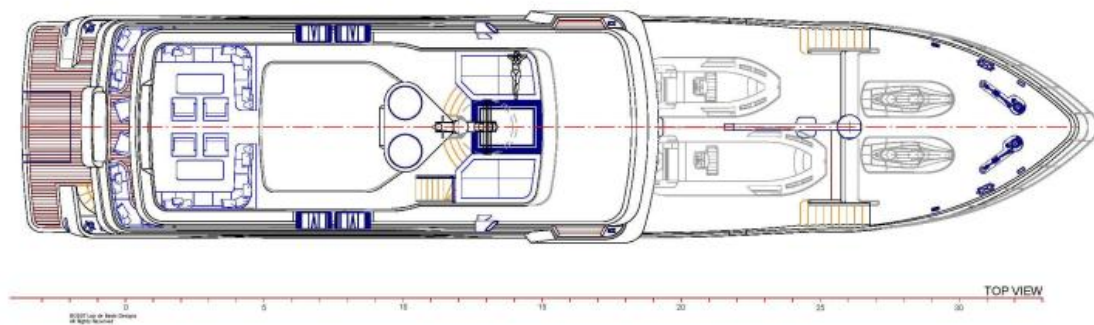

**INACE 126'**  
LUXORASTO  
DESIGN

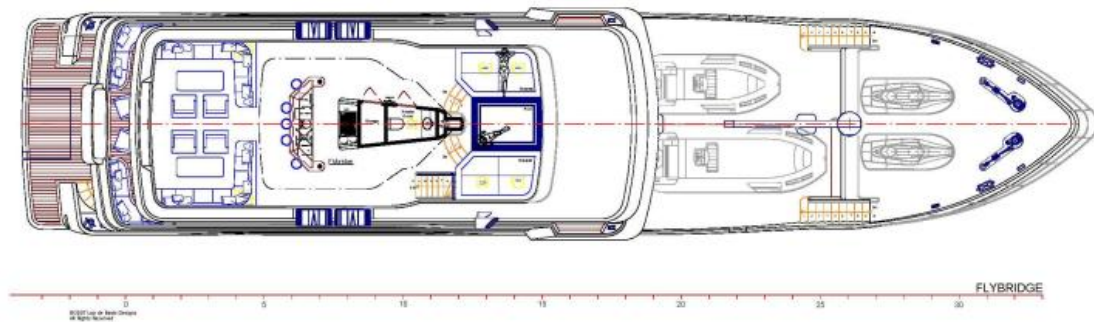

### INACE 126'

LUZCERASTO  
DESIGN  
CONCEPT DESIGN & BUILDING  
888.201.2017 | info@alloceanyachts.com

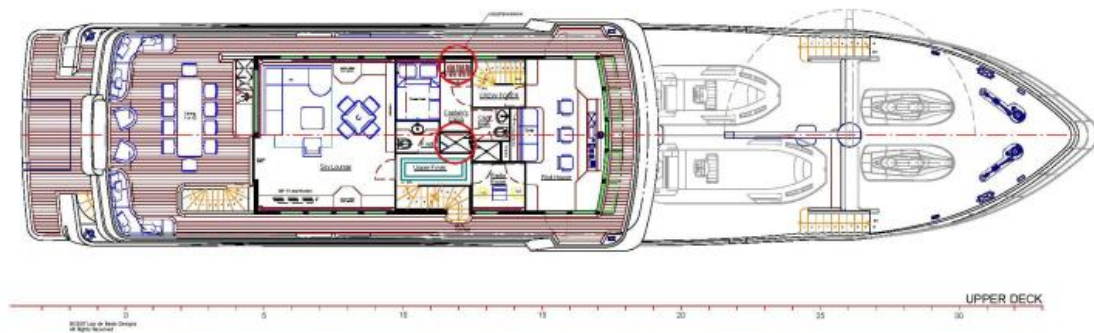

# INACE 126'

LUZCERASTO  
DESIGN  
CONCEPT DESIGN AND ARCHITECTURE  
848.201.0077 | info@alloceanyachts.com

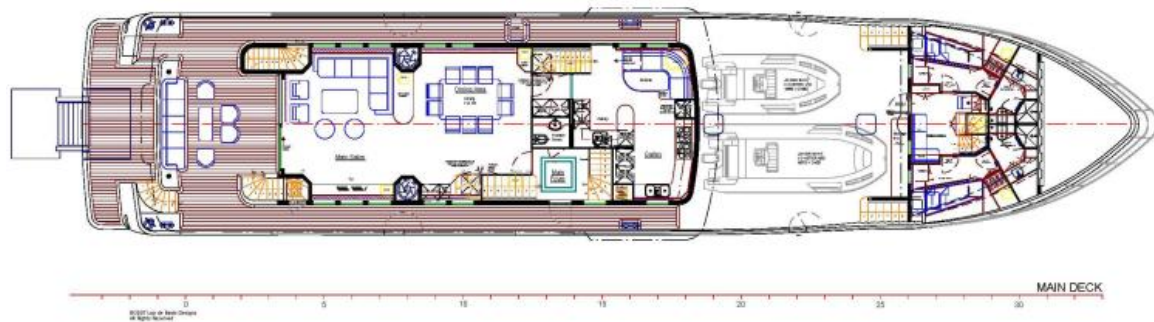

### INACE 126'

LUZARASTO  
DESIGN  
LUXURY YACHTS  
DESIGN & CONSTRUCTION  
848.201.0077 | info@alloceanyachts.com





**INACE 126'**

**LUZCERASTO**  
DESIGN  
CONCEPT DESIGN STUDIO  
ARCHITECTURE & INTERIOR DESIGN

**NOTE:**

- VIP1 and VIP2 has been changed according to the new layout.
- All portlights in the VIP1 and VIP2 has been moved forward for 100mm.
- A bookshelf has been created in the Owner's Suite, moving forward for 20mm like 2 doors to the Owner's Bathroom.

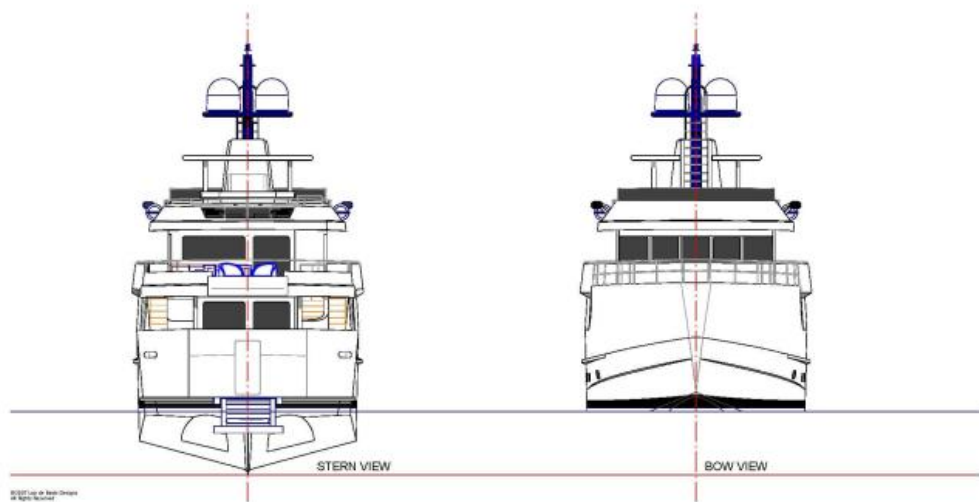

**INACE 126'**

**LUZARASTO**  
DESIGN  
CONCEPT DESIGN AND ARCHITECTURE  
800.201.1007 | www.alloceanyachts.com



**INACE 126'**

**LUZARASTO**  
DESIGN  
12345678901234567890  
12345678901234567890  
12345678901234567890

