



Available for Immediate Delivery



44' (13.41m) 2023 Excess EXCESS 14
Saint Petersburg Florida United States

OVERVIEW

Manufacturer:	Excess	Hull Material:	Fiberglass
Engines:	2 Yanmar	Cruise Speed:	
Engine Model:		Max Speed:	
Engine HP:	45	Cabins/Heads:	/
Beam:	25' 9"	Fuel Type:	Diesel
Max Draft:	4' 10"	Fuel:	106 G (401.25 L)
Water:	79 G (299.05 L)		

Call for Price



Gulf Coast Team info@MurrayYachtSales.com

800-826-2807

Data Sheet

Category: Catamaran	Fuel Type: Diesel	lbs
Subcategory: Multi-Hulls	Hull Material: Fiberglass	Fuel Tank: 106 gal (401.25 liters)
Condition: New	Hull Shape: Catamaran	Fresh Water: 79 gal (299.05 liters)
Model Year: 2023	Air Conditioning: Yes	Builder: Excess
Beam: 25'9" Max Draft: 4' 10" (1.47m)		Designer: VPLP Design
LOA: 43' 9" (13.34m)		In Stock: Yes
LWL: 42' 10" LOD: 45' 11"		

Engines/Generators

Engine 1

Yanmar
Inboard
45HP
Fuel: Diesel
Hours: 510

Engine 2

Yanmar
Inboard
45HP
Fuel: Diesel
Hours: 510

Summary/Description

The Excess 14 is designed for the perfect balance of sailing sensations and comfort aboard. Inspired by racing for cruising pleasure, this sleek catamaran features lightweight, asymmetrical hulls and a new sailplan maximizing sail area. Everything is there to wake up your senses as a sailor!

Boat Show Special Package

Excess Catamaran's newest and sportiest model, the Excess 14, has just completed her World Boat Show Tour and is now available for delivery on the Gulf Coast of the United States.

Launched in Les Sables d'Olonnes, France, in August and code-named "Rocket," she was delivered by the Excess Team for her World Debut at the famous Cannes Yachting Festival. She then sailed to Italy for the Salone Nautico 2023 (Genoa International Boat Show), followed by a stop in Spain at the Salon Nautico International de Barcelona. "Rocket" was then sailed the 130 miles to Palma and loaded on a ship bound for Florida.

The Murray Yacht Sales Team retrieved her from the ship in Ft. Lauderdale and sailed her to our St. Petersburg office for sea-trials, press events, and commissioning. She made her United States debut at the Miami International Boat Show in February and is currently moored at our St. Petersburg office on Salt Creek.

"Rocket" was built with great attention to detail under the watchful eyes of the entire Excess Team. Contact us for more information and details of "Rocket's" Boat Show Special Package.

WELCOME ON BOARD!

This catamaran is the outcome of innovative architecture, and unbiased research work seeking 'out of the box' solutions. The Excess 14 is designed around a layout never seen before on the market, both in the owner's version and in the charter version. More sensations yet everything you'd expect from a cruising boat: this is the challenge taken up by the Excess 14!

THE EMBODIMENT OF EXCESS DNA

Instantly recognizable design:

Take a low boom, reduced windage thanks to lower freeboard, taut lines, and redesigned hull windows, and you get a catamaran with a distinctive look! Add an aft-set coachroof, a forward stepped mast, a composite bowsprit (as standard)

as well as inverted and inclined bows for more fun! Finish off with an exposed forefoot and you have a dynamic catamaran that's ready for adventure.

For more sensations at the helm, you know our preference: helm stations right at the stern in direct contact with the rudders and a good view of the sails, as inspired by monohulls.

What you may not know is that visibility is optimal onboard the Excess 14, through untinted windows - this is an Excess exclusive on the market!

This model features an optimized fins design, and the rudder blades have been extended! A direct steering system has been chosen, with textile lines, for a better helm feel (because yes, it is important!)

INNOVATIVE ARCHITECTURE

Fundamental, unbiased research!

Thanks to our collaboration with VPLP design, the lines of the Excess 14 have benefited from an understanding of ocean racing. Enriched by their Expertise and cutting-edge software, this model is designed with a forward-set rig, a square-top mainsail, and a large overlapping genoa (as standard) to optimize the sail area to displacement ratio.

As it was impossible to leave it at that, bridge deck clearance was increased for better passage through the water, and the hulls were designed asymmetrically to reduce interference drag.

Continuing in this innovative approach, there is also:

- A lower center of gravity
- An optimized structure (foam sandwich, carbon reinforcements, etc.)
- A new longitudinal volume distribution At Excess, we don't do things by halves!

MORE SENSATIONS AND EVERYTHING YOU'D EXPECT OF A CRUISING BOAT

The Excess 14 is a cruising catamaran that also offers the comfort and modularity of its living spaces.

The goal was to maintain volume and good headroom, all this in a warm and as bright as ever interior design.

In the hulls, you'll find wide, very comfortable beds, and bathrooms featuring a separate shower. For setting off on your adventure, large and subdivided storage spaces have been created!

And because there's no compromise between sailing and living spaces, the retractable chart table is really ingenious!

A LAYOUT UNSEEN ON THE MARKET

Designed around a layout unseen on the market, both in the owner's version and in the charter version.

The Excess 14 is available in several layout versions.

In the innovative 3-cabin version, the main characteristics are :

- A central bathroom
- A large private dressing area
- An option of extra bunks

In the 4-cabin version, you'll find :

- A layout including 4 cabins, 4 heads & 4 separate showers!
- An optional skipper cabin in each hull
- A sky lounge option: lounging space on the coachroof with no compromise to the look or sensations.

The walk-in dressing room allows you to store both sailing gear and casual clothes.

With additional twin berths, the whole family can enjoy the suite.

EXCESS Models: [EXCESS 11](#) - [EXCESS 12](#) - [EXCESS 14](#) - [EXCESS 15](#)

Disclaimer

The company offers the details of this vessel in good faith but cannot guarantee or warrant the accuracy of this information nor warrant the condition of the vessel. A buyer should instruct his agents, or his surveyors, to investigate such details as the buyer desires validated. This vessel is offered subject to prior sale, price change or withdrawal without notice.



Excess 14 World Tour Model



Excess 14 Available Now



Excess 14 Gulf Coast



Excess 14 For Sale



Excess 14 Sailing with both the Genoa & Code 0



Excess 14 Florida Gulf Coast



Excess 14 NOMINATED FOR EUROPEAN YACHT OF THE YEAR (EYOTY) 2023



Excess 14 Bow



Excess 14 Bow



Excess 14 At Mooring



Excess 14 Under Sail



Excess 14 Enjoying to Sail



Excess 14 Stb Profile



Excess 14 Cockpit



Excess 14 Salon



Excess 14 Galley



Excess 14 Walk In Closet



Excess 14 Or Spare Cabin



Excess 14 Navigation



Excess 14 Fun to Sail



Excess 14 Fun to play

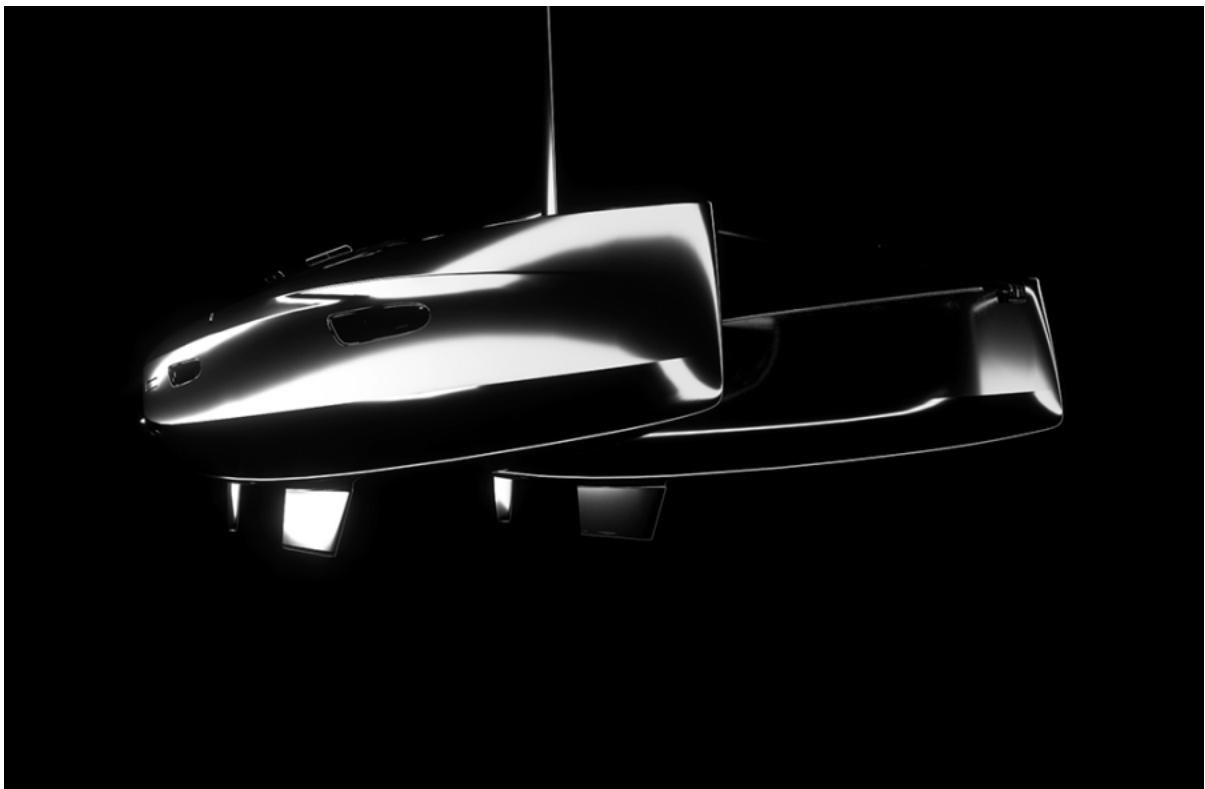

Excess 14 The asymmetrical hull design of this sleek catamaran minimize the impact of waves and maintain performance.



Excess 14 This new sailplan features a lowered boom designed to maximize sail area. The mainsail is a square-top design and the mast is set forward. A 115% genoa comes standard to optimize the sail area to displacement ratio.

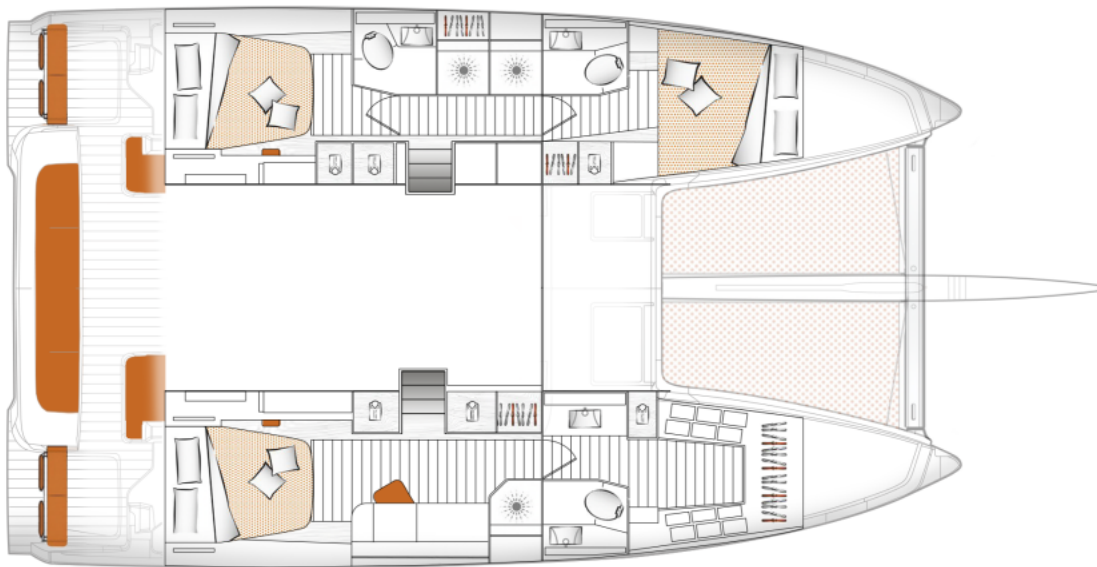

Excess 14 3 Cabin w Walk-In Closet

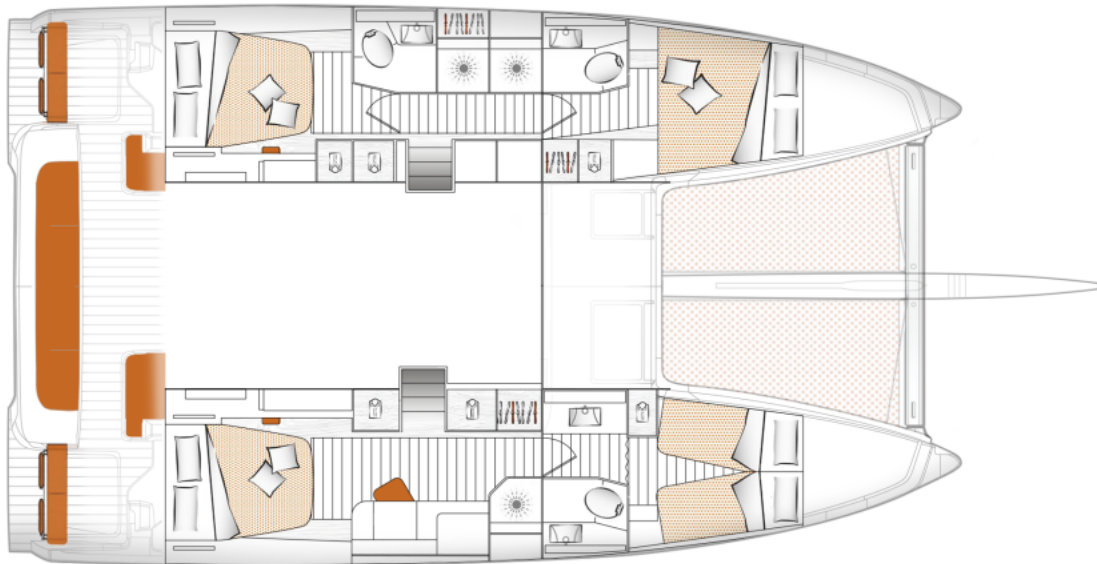

Excess 14 3 Cabin w Extra Berths

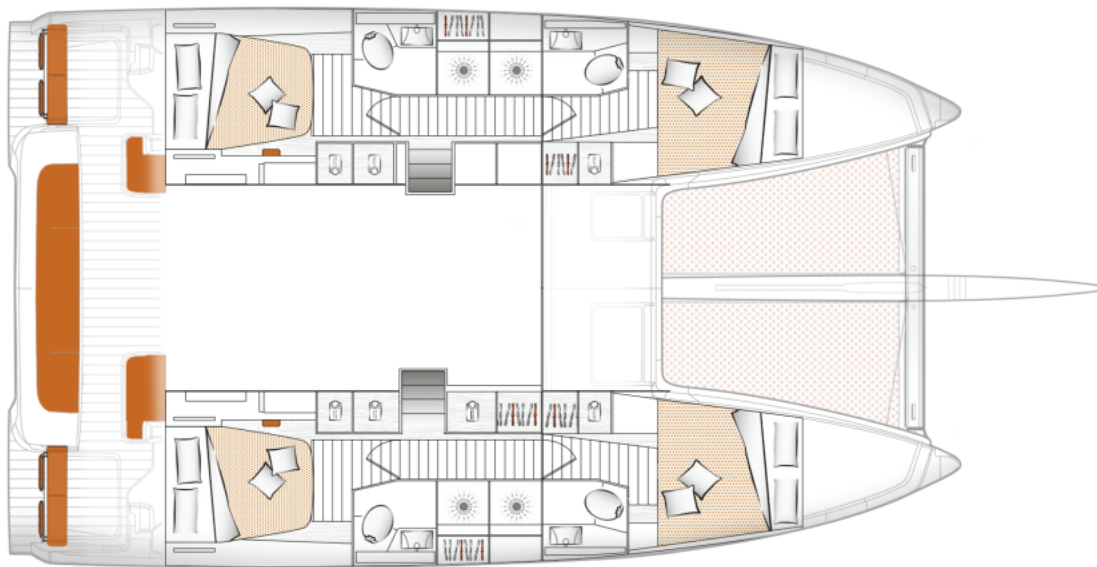

Excess 14 4 Cabin 4 Head

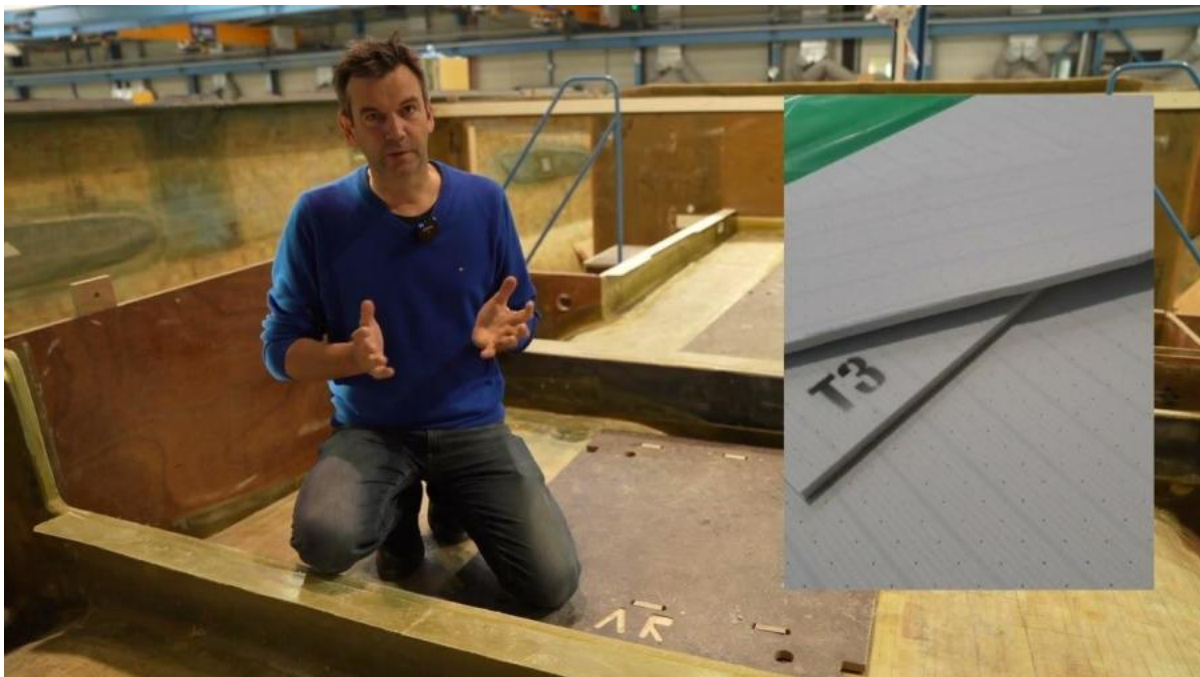

Product Manager HERVÉ PIVETEAU Explaining Bulkhead



Excess 14 Bow Life on board



Excess 14 Bow Life on board



Excess 14 Cockpit Life on board



Excess 14 Sailbag Life on board





