



My Zenda

70' (21.00m) 1991 Hatteras Cockpit Motor Yacht
Gloucester Massachusetts United States



OVERVIEW

Manufacturer:	Hatteras		
Engines:	2 Detroit	Hull Material:	Fiberglass
Engine Model:	12V92	Cruise Speed:	Knots
Engine HP:	1075	Max Speed:	Knots
Beam:	18' 2"	Cabins/Heads:	4 / 4
Max Draft:	5' 5"	Fuel Type:	Diesel
Water:	220 G (L)	Fuel:	1595 G (L)

\$249,900



Data Sheet

Category: Motor Yachts
Condition: Used
Model Year: 1991
Beam: 18'2" (5.54m)
Max Draft: 5' 5" (1.65m)
LOA: 70' (21.00m)
Cabins: 4
Double Berths: 2
Queen Berths: 2
Heads: 4

Knots
Knots
Fuel Type: Diesel
Hull Material: Fiberglass

Fuel Tank: 1595 gal Fresh Water: 220 gal

Engines/Generators

Engine 1

Detroit
12V92
Inboard
1075HP
801.63KW
Fuel: Diesel
Year: 1991
Location: Port

Engine 2

Detroit
12V92
Inboard
1075HP
801.63KW
Fuel: Diesel
Year: 1991
Location: Starboard

Summary/Description

Classic 1991 Hatteras 70' Cockpit Motor Yacht A Rare Opportunity To Snag This Renowned Live-Aboard At An Unbeatable Price Current Owner Has Made Significant Progress On Her Refit. Now Selling "As Is" For New Owner to Finish The Job.

HUGE Price Reduction!!!

Classic 1991 Hatteras 70' Cockpit Motor Yacht

A Rare Opportunity To Snag This Renowned Live-Aboard At An Unbeatable Price!

Current Owner Has Made Significant Progress On Her Refit. Now Selling "As Is" For New Owner to Finish The Job.

What's already in place includes:

- Custom Galley with new wood cabinets, stainless steel appliances, and granite countertops.
- Expansive Salon - ready for finishing touches
- Four (4) Bedrooms, 4 Heads. Aft Master Stateroom and Ensuite Roughed and Ready for Finish.

Check Out The Pictures And Specs And Contact Me Today!

Features and Accommodations

This beautifully refurbished European profile yacht with its extravagant accommodations was one of the most luxurious production yachts offered by Hatteras in the 90's.

- It's high functional floor plan features the galley and dinette on the wheel house level, where it is convenient to the salon. The full width salon is extended well aft with a private stairway to the master stateroom.
- Overnight room for all with a four stateroom/four head layout.
- The massive fly bridge has room for a dingy aft and seating for a large crowd.
- Engines are two 12v92 twin turbo Detroit Diesel engines with 1075 HP per engine which produce cruising speeds up to 19 knots.

Salon: The main salon is large and offers excellent natural light and ventilation through the side windows. To starboard is the stairway access to the master stateroom and engine room.

Galley: Versatile and desirable "up" galley is large and U-shaped. Cherry cabinets. Granite countertops. Stainless steel sink. Outstanding storage. Sunny and bright with excellent ventilation. Appliances include:

Dinette: Roomy, with fore and aft facing settee and a high-low table. Converts into an additional berth if needed. Drawer storage.

Pilothouse: Ample seating with an elevated chair and pull out foot rest. Drawers and cabinets for storage. Port and starboard pilot house doors with access to the flybridge along the starboard side and wide step treads. Access forward to the bow deck. Starboard side steps access lower cabins.

Master Stateroom: Private, aft room offers queen-sized, center-lined berth. Along the port and starboard sides are large drawers and shelving.

Laundry Room: Whirlpool washer and dryer.

Forward Stateroom: Center-lined queen berth and shared head.

Forward Head and Day Head. Vanity, mirrored cabinets, electric head, shower stall, overhead hatch.

Bunk Bed Stateroom: Bunks with the headboards inboard and overhead hatch.

Aft Guest Stateroom: Queen berth with storage drawers built-in.

Deck

- Flybridge helm cover
- (2) helm chairs
- Transom door with locks
- Swim platform with stainless steel swim ladder

Forward Deck: Access by way of either pilot house doors. Wide and safe side decks offers ease of movement. The deck has built-in seating facing forward and a large sun cushion on the cabin top. The windlass is easy to use and the large foredeck makes anchoring a breeze.

Flybridge: Two helm chairs and excellent 360 degree visibility.

Disclaimer

The Company offers the details of this vessel in good faith but cannot guarantee or warrant the accuracy of this information nor warrant the condition of the vessel. A buyer should instruct his agents, or his surveyors, to investigate such details as the buyer desires validated. This vessel is offered subject to prior sale, price change, or withdrawal without notice.



Hatteras 70 Cockpit Motor Yacht Custom Arrangement

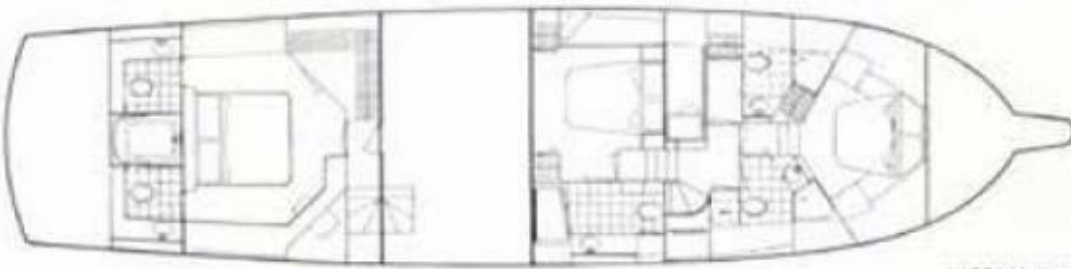
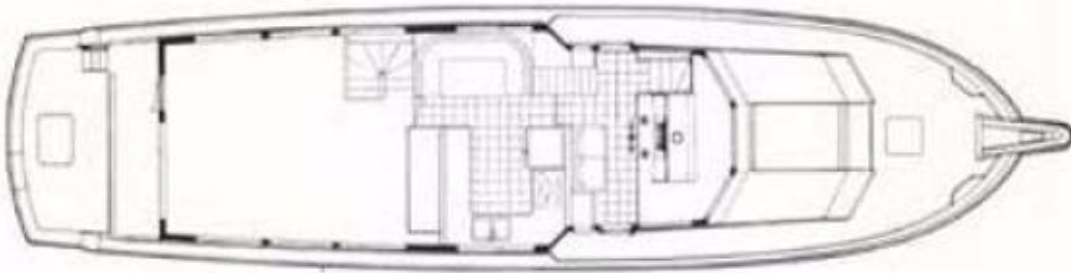

©1991 Hatteras Yachts





