



Plenty of Chips

55' (16.76m) 1990 Californian Cockpit Motoryacht
Hampton Virginia United States



OVERVIEW

\$169,997

Manufacturer:	<i>Californian</i>		
Engines:	2 Detroit Diesel	Hull Material:	Fiberglass
Engine Model:	671TIB	Cruise Speed:	12
Engine HP:	485	Max Speed:	22
Beam:	15' 2"	Cabins/Heads:	3 / 3
Max Draft:	4' 3"	Fuel Type:	Diesel
Water:	210 G (794.94 L)	Fuel:	730 G (2763.35 L)





Data Sheet

Category: Motor Yachts
Subcategory: Expedition Yacht
Condition: Used
Model Year: 1990
Beam: 15'2" (4.62m)
Max Draft: 4' 3" (1.30m)
LOA: 54' 5" (16.59m)
Cabins: 3
Heads: 3

Maximum Speed: 22 Cruise Speed: 12
Fuel Type: Diesel
Hull Material: Fiberglass

Displacement: 46200 Dry Weight: 46200 lbs
Fuel Tank: 730 gal (2763.35 liters)
Fresh Water: 210 gal (794.94 liters)
Holding Tank: 80 gal (302.83 liters)
HIN/IMO: CDRNA503G990

Engines/Generators

Engine 1

Detroit Diesel
671TIB
Inboard
485HP
Fuel: Diesel
Hours: 1927
Location: Port

Engine 2

Detroit Diesel
671TIB
Inboard
485HP
Fuel: Diesel
Hours: 1927
Location: Starboard



Summary/Description

Superb blue water handling, coupled with very spacious layout, makes this among the safest and most comfortable cruising vessels available. Having both Westmar bow thruster and stern thruster eases dockside handling. Sunbrella curtains with zippered Strataglass assure excellent view, coverage and en

HUGE PRICE REDUCTION! OWNER WANTS OFFERS!

Superb blue water handling, coupled with very spacious layout, makes this among the safest and most comfortable cruising vessels available. Having both Westmar bow thruster and stern thruster eases dockside handling. Sunbrella curtains with zippered Strataglass assure excellent view, coverage and environmental protection for the flybridge and aft deck.

Accommodations

Cruising & entertaining designed layout includes a large, functional cockpit, oversized aft deck, comfortable salon, galley, dinette, 3 staterooms (each with a full head and stall shower), large flybridge with comfortable room for several guests, and easily accessible engine room

Salon

- Flexsteel "L" recliner sofa [2006]
- Custom curtains & blinds [2006]
- Commercial track lighting [2006]
- Extensive counter & cabinet space
- Liquor cabinet
- Lower control station with instrumentation
- AC & DC Electrical Panels
- Electric main switches (via deck access panel)
- Fuel tank selectors
- AC/Heat controls
- Steps up to aft deck
- Steps down to galley/dinette
- Steps down to Master Stateroom passageway
- Large flat screen television [2018]
- Blue Ray, RUKU Entertainment Streaming, HDMI Streaming to multiple televisions [2018]

Galley

- Custom curtains [2006]
- Parquet Teak Deck
- Plasteak interior teak flooring [2015]

- Black refrigerator accents [2015]
- Wall hung oil painting [2008]
- "C" shaped dinette w/custom foam & upholstery [2006]
- Extensive storage in cabinets, drawers & under dinette
- Piston* assist & hold hatch to engine room [*2011]
- Water heater (below deck)
- Steps up to salon
- Steps down to engine room
- Privacy door to VIP forward stateroom
- Sharp Carousel 11 Convection microwave with vent blower and light
- Double stainless sink
- Seagull IV X-IF Drinking Water Purification System [2006]- New filters [2012]
- Frigidaire frost proof refrigerator and top freezer
- Built-in NuTone food processor with accessories
- Corian countertops
- 4-Burner glass stove top
- Coffee maker [2018]

Master Stateroom

- Full beam master stateroom
- Queen island berth with custom memory foam mattress [2003]
- Samsung 24" flat screen television [2018]
- Bose television sound bar
- Blue Ray, RUKU streaming, HDMI streaming (stateroom television may simultaneously watch entertainment streamed from salon entertainment system, or stream independently)
- [2018]
- New A/C [2018]
- Lighted vanity with mirrors (new lights 2006)
- Integrated night stand
- Commercial track lighting [2006]
- Large hanging locker (cedar lined) w/mirror doors & electric dehumidifier
- Small hanging locker (cedar lined)
- Large, shelved storage area behind doors
- Vacuflush head
- Stall shower & sink
- Privacy door to head
- Corian countertop
- Lifetime Baldwin Brass fixtures [2003]
- Personalized (Plenty of Chips) Towels [2018]
- Custom "blackout" curtains [2006]
- AC/Heat controls
- Private door access to cockpit
- Privacy door to master stateroom gangway (to salon)

Amidship Stateroom

- Daybed converts to single bunk, or pull out to double bunk
- Drawers, cabinet and hanging storage
- Table lamp [2007]
- Custom covers, pillows, curtains [2006]
- Stacked Frigidaire washer & dryer in Closet
- Privacy door to master stateroom gangway

Amidship Head

- Vacuflush head
- Plasteak flooring [2015]
- Stall shower & sink
- Corian countertop
- Lifetime Baldwin Brass fixtures [2003]
- Custom curtains [2006]
- Privacy door to master stateroom gangway

VIP Stateroom

- Queen Berth (Centerline w/steps for easy access)
- Custom Memory Foam Mattress 2003]
- Custom Covers & Pillows [2006]
- Custom curtains [2006]
- Hanging closet
- Drawers & cabinet
- Insuite head with stall shower & sink
- Lifetime Baldwin Brass fixtures 2003]
- Sliding privacy door for head Lifetime Baldwin Brass fixtures to stateroom
- Privacy door to dinette/galley
- AC/Heat Controls

Entertainment

- Bose Wave AM/FM/CD Player in salon [2004]
- Jensen MCD 5710 AM/FM/CD Player on flybridge [2003]
- 32" LED TV in salon [2018]
- 24" Samsung LED TV in master stateroom [2018]
- Blue Ray, RUKU entertainment streaming, HDMI streaming in salon and master stateroom [2018]
- Bose sound bar in master stateroom [2018]
- Master stateroom TV may watch entertainment streamed from salon system or watch independent streaming [2018]
- XM Radio in salon [2006]
- West Marine speakers in salon, aft deck and flybridge [2003]
- KVH-4 Satellite TV antenna [2005]

Bridge

- Hatch with ladder down to aft deck
- Flexsteel Helm Chairs (2) & Mounts [2006]
- Custom Passenger Seating [2006]
- Anti-Fatigue Pad for pilot [2006]
- Extensive storage behind doors and hatches (doors & hardware refurbished & replaced [2011])
- 12v Outlet [2003]
- Electrical Panel
- Custom Fascia Panels [2005]
- New lighting [2015]
- Sunbrella Bimini & Curtains with 40 gauge grey tinted Strataglass; [2017]
- New windshield [2017]

Electronics and Navigation

- Radar arch - refurbished and painted [2010]
- Furuno Marine Radar - 6kw, 64 mile, open array, 48" antenna on custom PYI mount [2005]
- Furuno NAV pilot-500 autopilot [2005]
- ICOM IC-M602 VHF Radio - includes ICOM Command microphone and extended cord on aft deck [2003]
- Raymarine ST60 Tridata - depth, speed, lot, et al. [2003]
- Furuno GP1870F Color Video Sounder - fish finder, depth and terrain [2015]
- (2) Furuno MI 943C Chartplotter - includes radar, plotter and sounder [2005]
- Furuno PG-500 Integrated rate compensated heading sensor [2005]
- Jabsco remote control automatic 6" spotlight [2003]
- Newmar intercom in salon/galley and flybridge [2003]
- Ritchie Power Darn Plus 5" magnetic compass [2003]
- FARIA gauges and indicators in flybridge and salon stations [2005]
- XM "Roady" Radio
- Radar arch mount XM antenna [2005]
- GPS WAAS antenna [2005]
- (2) Galaxy 17' 6 11 VHF antenna and mounts [2003]
- Galaxy 4' AM/FM Antenna mount [2003]

Aft Deck

- LED lighting [2015]
- Carpeted [2006] with teak rails
- Stainless Sink
- Lighted over-sink cabinet w/mirror doors
- U-Line Frost-Free Combo Refrigerator/ Ice maker [2003]
- Seagull IV X-IF Drinking Water Purification System [2006] Filters replaced [2012]
- 8" Ship's Bell [2009]
- Ring Buoy [2018] & line bag with 150' line [2009]
- Man Overboard Floating Throw Light [2011]
- Boat Hooks & holders [2004]
- Ladder down to cockpit with PlasDeck steps [2015]

- Ladder up to fly bridge
- Stairs down to salon
- 3 Position Sofa with Coffee Table [2006]
- Easy Chair with Side Table 2006]
- Port & Starboard Wing doors to Forward Deck

Cockpit

- Custom full beam swim platform with PlasDecking and custom hand rails [2016]
- Transom door
- Stainless Steel steps to gunwale with PlasDeck steps [2015]
- Stainless steel staff [2012]
- Outriggers
- Rocket Launcher Rod Holders
- Hot & Cold Water
- Securefill Fuel Recovery System (1 per tank) [2005]
- Power Inlets (50 Amp & 30 Amp) [2006]
- Cable TV & Telephone Inlet [2006]
- Large fiberglass Deck Box [2004]
- Stainless Steel Deck Chairs w/Sunbrella Upholstery and self-draining foam cushions [2010]
- Teak Table [2005]
- BOJI Water Softener & Filter, large size [2005]
- Flood Lights [2006]
- Marquipt Sea Stair self-leveling shipside accommodation stairs w/Handrail (Boarding access via stairs on Port and Starboard)
- Door with Steps down to Master Stateroom
- Ladder up to Aft Deck with PlasDeck steps

Electrical

- Kohler 20kw Generator powered by YANMAR Turbo-charged, intercooled 4 cylinder engine (1700 Hours)
- Generator Sound shield cover
- Generator Serviced 2020
- Xantrex 40+ amp multistage battery charger. Dedicated to House battery bank [2006]
- (2) Odyssey PC2250ST - House batteries. AGM, Sealed [2006]
- (4) Odyssey PC2250ST - Thruster batteries. AGM, Sealed (1/2 the size of 8Ds) [2006]
- 12v DC and 110v AC systems
- Dockside 50 Amp Inlet - cockpit [2006]
- Dockside 50 Amp Inlet - port side amidships [2006]
- Dockside 30 Amp Inlet - cockpit [2006]
- 50' White 50 Amp Cable with bag [2007]
- 25' Yellow 50 Amp Cable with blue nylon cover and bag [2006]
- 55' Yellow 30 Amp Cable with bag [2003]
- New Custom 50 Amp Cable - Length to buyer's specification (within reason) white or yellow. Cable and ends provided unassembled [2012]
- Major rewiring [2020]

Deck and Hull

- Davit (1500 lb) with S/S Dinghy lift attachment. Refurbished and painted [2011]. New cable [2012]
- Maxwell VMC 3500 Windlass with foot controls at bow [2010]
- 3/8" G4 Hi-Test Chain [2010]
- CruzPro CH-30 Chain counter and intelligent windlass controller at flybridge [2005]
- 55lb Delta anchor [2003]
- FireBoy Halon extinguisher system
- Fire extinguishers
- (3) Bilge pumps - One replaced each indicated year [2003, 2010, 2011]
- ADEMCO 41 IOXM Security system (not currently in use)
- Ring Buoy [2018]
- Hailer [2005]
- Buell triplex air horns. Also compressor with twin holding tanks and extra hose connection (2004)
- Navigation and anchor lighting [2015]
- Storm Sea anchor [2003]
- (6) Medium Green Boat fenders [2016]
- Required safety gear with extras
- Rapid ditch bag [2003]
- Hynautic Engine Controls
- Bilge blowers
- Sea Cocks [serviced 2018, 2020]
- Stern thruster with rebuilt spares motor in 2003 and includes (4) new unused spare solenoids purchased 2003
- Bow anchor roller plate with reinforced support [2005]

Additional Equipment

- Cruisair Reverse Air AC/Heat in master and amidships staterooms [2018]
- Cruisair Reverse Air AC/Heat in salon and galley [2003]
- Cruisair Reverse Air AC/Heat in VIP stateroom and galley [2010]
- Custom holding tank [2006]
- Holding tank filter [2060]
- (2) Spare props
- Props tuned by Wildcat [2005]
- Dripless shaft packing [2003]
- Bennett trim tabs
- Windshield cover [2017]
- Portable vacuum system (Includes Beater head and other accessories) [2005]
- Groco pump Pressure water system - rebuilt in 2006
- Cleaning gear and hoses
- High stainless rails
- Nighthawk by Kidde Safety Combination Smoke and Carbon Monoxide alarms [2010]
- Stainless steel bow pennant staff [2004]
- 3/4 Lines [2016]
- Original owner's manual - included original schematics
- Operator's manuals for electronics
- Various installation manuals

Engines

- Engine room had major refit 2019/2020 with new wiring, hoses, paint, lighting,
- Twin Detroit Diesels 6-71 TIB (Covington), reported overhauled in 1997
- Glendenning Synchronizers, port engine re-wired/re-hosed 2020
- Walker Airseps [2020]
- FloScans (Series K) [2004]
- Block Heaters [2003]
- Vacuum Gauges on Racor Fuel Filters [2003]
- Hynautic controls
- Twin Disc Model MG-509 Marine Transmissions
- Easy drain oil hoses installed Reported overhauled in 1997
- HP: 485 hp each (970 hp total power)
- Starboard hours: 1927
- Port hours: 1927
- Speed: 12 knots cruise/ 22 knots top speed





























































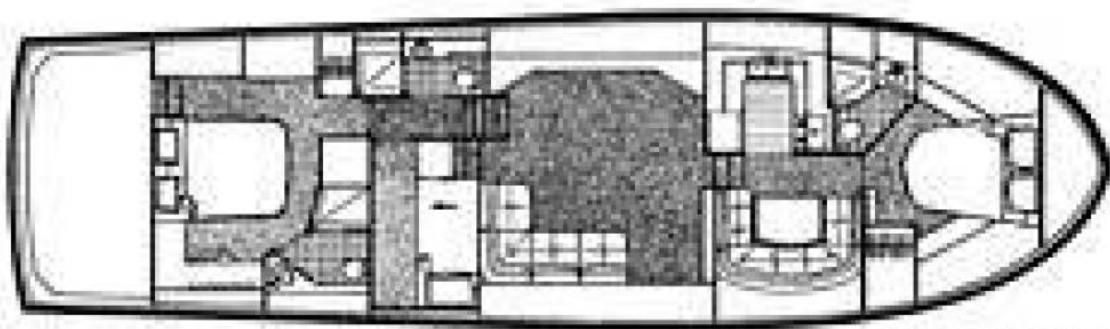

CARVER