



126' (38.00m) 2024 Inace Explorer
Fortaleza Brazil



OVERVIEW

Manufacturer:	Inace	Hull Material:	Steel
Engines:	2 Caterpillars	Cruise Speed:	Knots
Engine Model:	C18	Max Speed:	Knots
Engine HP:	0	Cabins/Heads:	/
Beam:	26' 0"	Fuel Type:	Diesel
Max Draft:	7' 9"	Fuel:	
Water:			

\$14,995,000





Data Sheet

Category: Trawlers	Knots	Builder: Inace
Condition: New	Knots	Designer: Luiz Debasto
Model Year: 2024	Fuel Type: Diesel	
Beam: 26' (7.92m)	Hull Material: Steel	
Max Draft: 7' 9" (2.36m)		
LOA: 126' (38.40m)		

Engines/Generators

Engine 1

Caterpillars
C18
Fuel: Diesel

Engine 2

Caterpillars
C18
Fuel: Diesel



Summary/Description

For Sale

A touch more style, the next generation of Expedition yachts, the superb 126' aft house explorer yacht by Luiz Debasto design has the same impressive sea keeping qualities that INACE is famous for.

The aft deck and swim platform have been extended in this version also creating more room on the bridge deck and flybridge deck and increased space in the engine room. The extra space has allowed us to expand the seating areas on all of the decks.

There is a large master plus 4 ensuite guest cabins and a great skylounge and flybridge There is tons of room for for toys and a large tender. The expedition yacht has a 4000 NM cruising range to take you anywhere. The huge engine room easily accommodates twin Cat engines and generators. Built to ABS and MCA specifications for your safety as well as the highest standards.

PRICE ON REQUEST. **5% Commission to Selling Broker**

Just Added Scale model images have been added at the bottom of the page

Dimensions

Displacement: 322

Engines

Cruising Speed: 10.5

Max Speed: 12.5

Tanks

Fuel: 16300

Fresh Water: 2300

Under Construction - The second in this Series

A touch more style, the next generation of Expedition yachts, the superb 126' aft house explorer yacht by Luiz Debasto design has the same impressive sea keeping qualities that INACE is famous for.

The aft deck and swim platform have been extended in this version also creating more room on the bridge deck and flybridge deck and increased space in the engine room. The extra space has allowed us to expand the seating areas on all of the decks.

There is a large master plus 4 ensuite guest cabins and a great skylounge and flybridge There is tons of room for for toys and a large tender. The expedition yacht has a 4000 NM cruising range to take you anywhere. The huge engine room easily accommodates twin Cat engines and generators. Built to ABS and MCA specifications for your safety as well as the highest standards





Photo 1 Photo 1



Main Salon Main Salon



Master Stateroom Master Stateroom

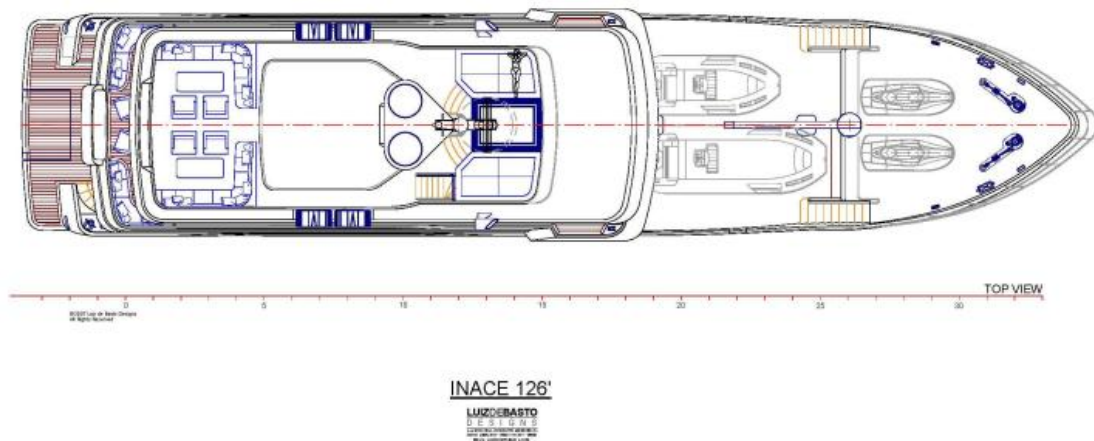

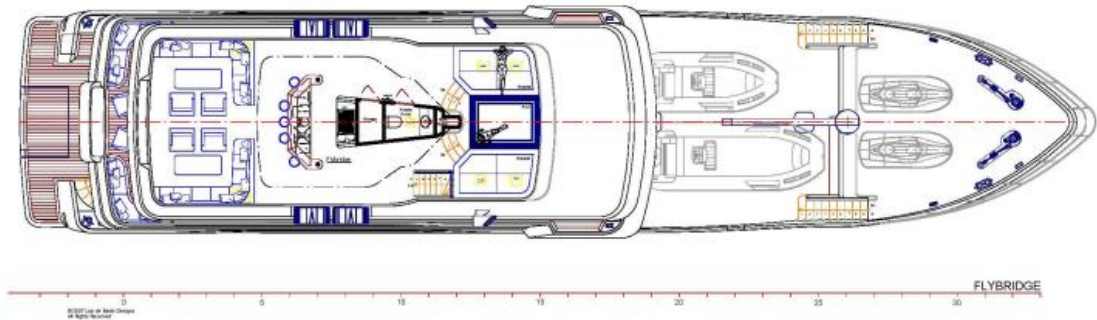

INACE 126'

LUZDERASTO
DESIGN
CONCEPT DESIGN
DESIGNER: LUZDERASTO
DESIGN

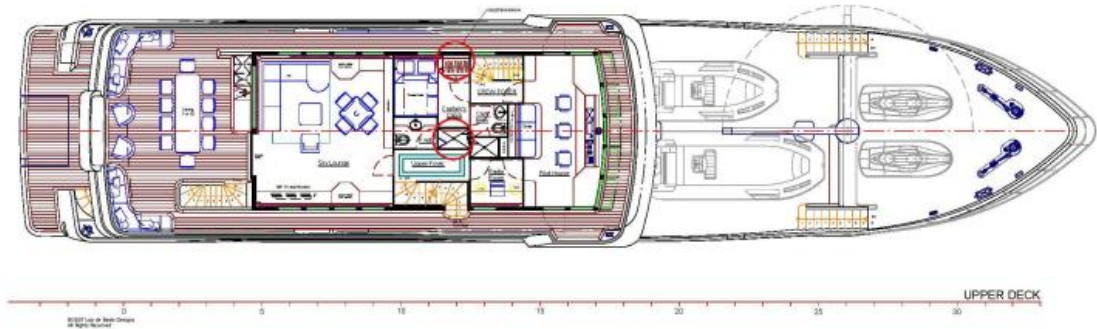

INACE 126'

LUZARASTO
DESIGN
CONSTRUCTION

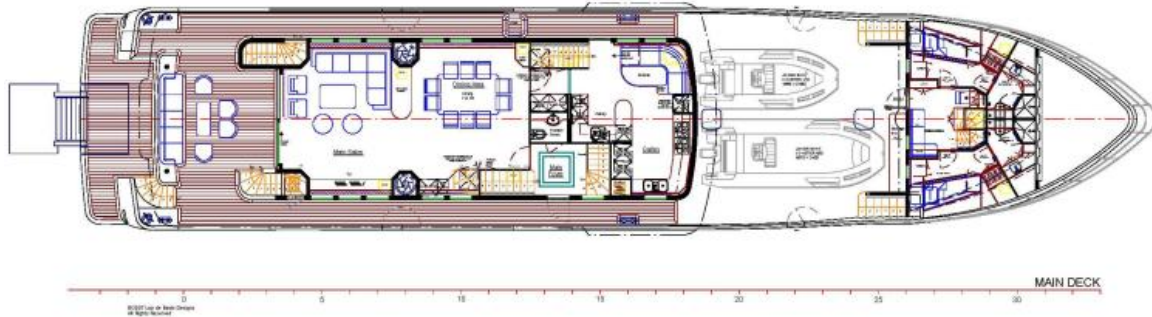

INACE 126'

LUZARASTO
DESIGN
CONSTRUCTION
MANUFACTURE



INACE 126'

LUZCERASTO
DESIGN
CONCEPTS AND PLANS
ARCHITECTURE

NOTE:

- VIP1 and VIP2 has been changed according to the new layout.
- At port side the VIP1 and VIP2 has been moved forward for 100mm.
- A bookshelf has been created in the Owner's Suite, moving forward for 20mm (like 2 doors to the Owner's Bathroom).

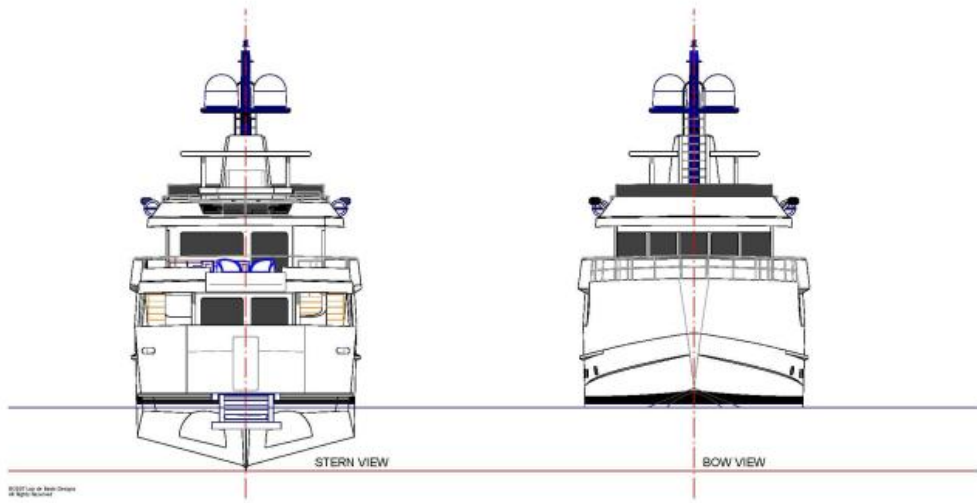

INACE 126'

LUZ DE BONT
DESIGN
LUXURY YACHT DESIGN
www.luzdebont.com



INACE 126'

**LUZDEBASTO
DESIGNS**
COMMERCIAL INTERIORS AND MORE
PHONE: (904) 971-1990 • FAX: (904) 971-1999
WWW.LUZDEBASTO.COM

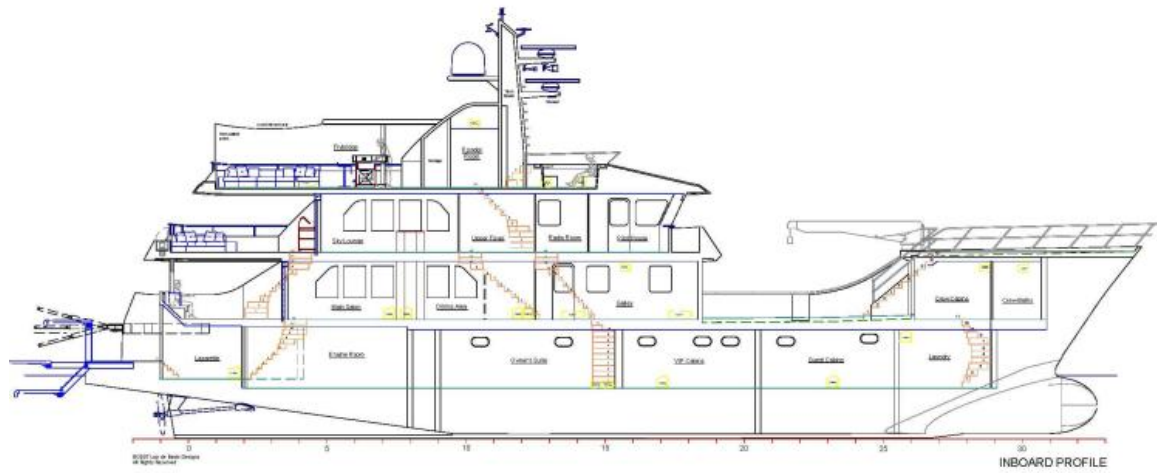

INACE 126'

LUZCERASTO
DESIGN
CONCEPT DESIGN AND ARCHITECTURE
DESIGN AND ARCHITECTURE